

REIN+ GUEST STANDARD FEATURES

- Rated for 500 lbs.
- European beech hardwood frame
- Mortise-and-tenon construction
- Clean-thru design
- Field replaceable components
- Wall-saver design
- Non-marring adjustable glides
- Upholstered seat and back
- Can be ganged to other Rein+ units using 1810-G or 1810-TG

GUEST CHAIR

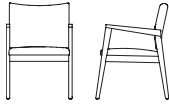

| w | outside d | h | sw | seat sd | sh | seat to top of back | arm height | weight lbs. | cubic feet |
|-------|-----------|------|-------|---------|------|---------------------|------------|-------------|------------|
| 22.75 | 25.25 | 32.5 | 20.25 | 20 | 17.5 | 15 | 25.5 | 23 | 12 |

| model | yds com (54") | sq ft col | com 1 | col 2 | 3 | 4 | 5 | 6 | 7 | 8 | 9 | 10 | 11 | 12 | 13 | 14 | 15 | L1 | L2 | L3 |
|-------|---------------|-----------|-------|-------|-----|-----|-----|-----|-------|-------|-------|-------|-------|-------|-------|-------|-------|-------|-------|-------|
| 1810 | 1.25 | n/a | 770 | 791 | 814 | 843 | 885 | 943 | 1,002 | 1,061 | 1,120 | 1,179 | 1,237 | 1,296 | 1,355 | 1,414 | 1,472 | 1,042 | 1,101 | 1,159 |

BARIATRIC CHAIR



| w | outside d | h | sw | seat sd | sh | seat to top of back | arm height | weight lbs. | cubic feet |
|-------|-----------|------|-------|---------|------|---------------------|------------|-------------|------------|
| 31.75 | 25.25 | 32.5 | 29.25 | 20 | 17.5 | 15 | 25.5 | 35 | 23 |

| model | yds com (54") | sq ft col | com 1 | col 2 | 3 | 4 | 5 | 6 | 7 | 8 | 9 | 10 | 11 | 12 | 13 | 14 | 15 | L1 | L2 | L3 |
|---------|---------------|-----------|-------|-------|-------|-------|-------|-------|-------|-------|-------|-------|-------|-------|-------|-------|-------|-------|-------|-------|
| 1810-OB | 2 | n/a | 1,013 | 1,046 | 1,084 | 1,131 | 1,196 | 1,290 | 1,384 | 1,479 | 1,573 | 1,667 | 1,761 | 1,855 | 1,949 | 2,043 | 2,137 | 1,431 | 1,526 | 1,619 |

OPTIONS

| Arm Caps | Finish | Removable Covers | Fabric 1 |
|--|--|---|--|
| Standard X9 No Arm Cap | Selection Required | Standard X9 No Selection of Option | Selection Required |
| Resin \$108 pair D1N Black D1M Taupe D1P Grey Solid Surface \$198 pair CWS Cameo White MWS Modern White CSS Concrete DMS Deep Mink | See page 9 for full list of finish options | B1L Removable Seat Cover only \$105 | Fabric: Grade, Vendor, Pattern, Color NOTE: For multiple fabric applications see page 14 for information and pricing |

HOW TO ORDER

SPECIFY: Arm caps | wood finish | removable covers | textile pattern and color. See **pages 5-14** for information and options on moisture barrier, CAL133, upholstery applications, a complete offering of finishes and ordering details.

MODEL NUMBER

1810

| Arm Caps | Finish | Removable Covers | Fabric 1 |
|----------|--------|------------------|--------------------------------|
| D1N | MLC | B1L | Grade 5, Momentum, Row, Breeze |

REIN+ MULTIPLE STANDARD FEATURES

- Rated for 500 lbs. per seat
- European beech hardwood frame
- Mortise-and-tenon construction
- Clean-thru design
- Field replaceable components
- Wall-saver design
- Non-marring adjustable glides
- Upholstered seat and back
- Can be ganged to other Rein+ units using 1810-G or 1810-TG

CHAIR/CHAIR TANDEM



| w | outside d | h | sw | seat sd | sh | seat to top of back | arm height | weight lbs. | cubic feet |
|----|-----------|------|-------|---------|------|---------------------|------------|-------------|------------|
| 44 | 25.25 | 32.5 | 20.25 | 20 | 17.5 | 15 | 25.5 | 46 | 23 |

| model | yds com (54") | sq ft col | com 1 | col 2 | 3 | 4 | 5 | 6 | 7 | 8 | 9 | 10 | 11 | 12 | 13 | 14 | 15 | L1 | L2 | L3 |
|---------|---------------|-----------|-------|-------|-------|-------|-------|-------|-------|-------|-------|-------|-------|-------|-------|-------|-------|-------|-------|-------|
| 1810-CC | 2.25 | n/a | 1,470 | 1,507 | 1,549 | 1,602 | 1,676 | 1,782 | 1,888 | 1,994 | 2,100 | 2,205 | 2,311 | 2,417 | 2,523 | 2,629 | 2,734 | 1,937 | 2,043 | 2,148 |

CHAIR/CHAIR/CHAIR TANDEM

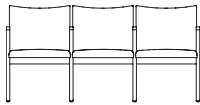

| w | outside d | h | sw | seat sd | sh | seat to top of back | arm height | weight lbs. | cubic feet |
|------|-----------|------|-------|---------|------|---------------------|------------|-------------|------------|
| 65.5 | 25.25 | 32.5 | 20.25 | 20 | 17.5 | 15 | 25.5 | 69 | 34 |

| model | yds com (54") | sq ft col | com 1 | col 2 | 3 | 4 | 5 | 6 | 7 | 8 | 9 | 10 | 11 | 12 | 13 | 14 | 15 | L1 | L2 | L3 |
|----------|---------------|-----------|-------|-------|-------|-------|-------|-------|-------|-------|-------|-------|-------|-------|-------|-------|-------|-------|-------|-------|
| 1810-CCC | 3.25 | n/a | 2,028 | 2,081 | 2,143 | 2,219 | 2,326 | 2,479 | 2,632 | 2,784 | 2,937 | 3,090 | 3,243 | 3,396 | 3,549 | 3,701 | 3,854 | 2,690 | 2,844 | 2,995 |

OPTIONS

| Arm Caps | Finish | Removable Covers | Fabric 1 |
|--|--|---|---|
| Standard X9 No Arm Cap | Selection Required | Standard X9 No Selection of Option | Selection Required |
| Resin \$54 per arm cap D1N Black D1M Taupe D1P Grey Solid Surface \$96 per arm CWS Cameo White MWS Modern White CSS Concrete DMS Deep Mink | See page 9 for full list of finish options | B1L Removable Seat Cover per seat \$105 | Fabric: Grade, Vendor, Pattern, Color NOTE: For multiple fabric applications see page 14 for information and pricing |

HOW TO ORDER

SPECIFY: Arm caps | wood finish | removable covers | textile pattern and color. See pages 5-14 for information and options on moisture barrier, CAL133, upholstery applications, a complete offering of finishes and ordering details.

MODEL NUMBER

1810-CC

| Arm Caps | Finish | Removable Covers | Fabric 1 |
|----------|--------|------------------|--------------------------------|
| D1N | MLC | B1L | Grade 5, Momentum, Row, Breeze |

REIN+ GANGING TABLE STANDARD FEATURES

- European beech hardwood frame
- Mortise-and-tenon construction
- Top options - veneer, HPL or TFL with matching PVC edge, 3DL or solid surface
- Wall-saver design
- Non-marring adjustable glides
- Can be ganged to other Rein+ units using 1810-G or 1810-TG

INSIDE 90° TABLE

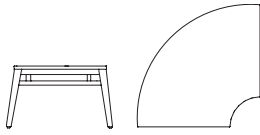

| model | | w | d | h | wt | cu ft | list |
|----------|--------------------|-------|-------|------|----|-------|--------|
| 1810-90I | VENEER | 30.25 | 30.25 | 14.5 | 52 | 10 | \$ 775 |
| | TFL/HPL/3DL | | | | | | \$ 854 |
| | STUDIO TFL/HPL/3DL | | | | | | \$ 941 |
| | SOLID SURFACE | | | | | | \$ 958 |

OUTSIDE 90° TABLE

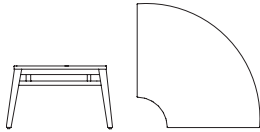

| model | | w | d | h | wt | cu ft | list |
|----------|--------------------|-------|-------|------|----|-------|--------|
| 1810-90O | VENEER | 30.25 | 30.25 | 14.5 | 52 | 10 | \$ 775 |
| | TFL/HPL/3DL | | | | | | \$ 854 |
| | STUDIO TFL/HPL/3DL | | | | | | \$ 941 |
| | SOLID SURFACE | | | | | | \$ 958 |

END/MIDDLE TABLE

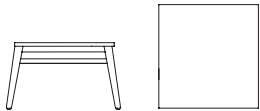

| model | | w | d | h | wt | cu ft | list |
|--------|--------------------|------|----|------|----|-------|--------|
| 1810-E | VENEER | 22.5 | 25 | 14.5 | 41 | 7 | \$ 607 |
| | TFL/HPL/3DL | | | | | | \$ 689 |
| | STUDIO TFL/HPL/3DL | | | | | | \$ 759 |
| | SOLID SURFACE | | | | | | \$ 805 |

OPTIONS

| Exposed Wood Finish | Top | Spill Groove |
|--|--|---|
| Selection Required | Standard | Selection Required |
| See page 9 for full list of finish options | X9 Veneer Match to Exposed Wood Finish | Available only on 3DL and Solid Surface |
| | HPL (Matching PVC Edge) TFL (Matching PVC Edge) 3DL Solid Surface | X9 None C6H Spill Groove |
| | See pages 9-10 for full list of HPL, TFL, 3DL and Solid Surface options | |

HOW TO ORDER

SPECIFY: Base - Wood finish | Top - Veneer finish, HPL, TFL, 3DL or solid surface | spill groove. See pages 5-14 for a complete offering of finishes and ordering details.

MODEL NUMBER

1810-90I

| Exposed Wood Finish | Top | Spill Groove |
|---------------------|-----|--------------|
| MNW | NWP | X9 |

REIN+ GANGING CLIPS STANDARD FEATURES

- Black powder coated metal
- Tightens onto understructure using two wing nut bolts (included)

CHAIR GANGING BRACKET



| model | w | d | h | wt | cu ft | list |
|--------|-----|----|------|------|-------|-------|
| 1810-G | 2.5 | 25 | 1.25 | 0.02 | 0.04 | \$ 29 |

TABLE GANGING BRACKET

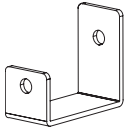

| model | w | d | h | wt | cu ft | list |
|---------|-----|----|------|------|-------|-------|
| 1810-TG | 2.5 | 25 | 1.25 | 0.02 | 0.04 | \$ 29 |

HOW TO ORDER

MODEL NUMBER

1810-G