

### Tools required

1. Large flathead screwdriver or pry bar
2. Drill with phillips bit.

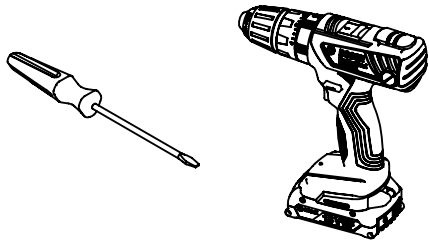

### Seat removal

1. Use large flathead screwdriver or pry bar to pry seat front up from base. **Be careful not to damage the fabric.**
2. After seat brackets (under seat) clear the front of base pull seat assembly up, forward and out.

### Gang bracket install

1. Align units in their final location.
2. Place gang brackets over sides of frames as shown.
3. Fasten brackets in place with provided screws.

### Seat Install

TIP - Install corner seats first.

1. Center seat on base.
2. Place rear of seat down into base.
3. Apply equal pressure left and right while pushing seat rearward.
4. After seat brackets clear base press seat down and in place.

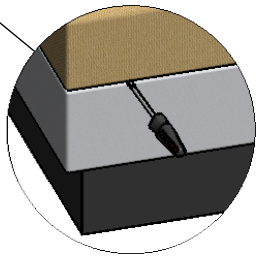
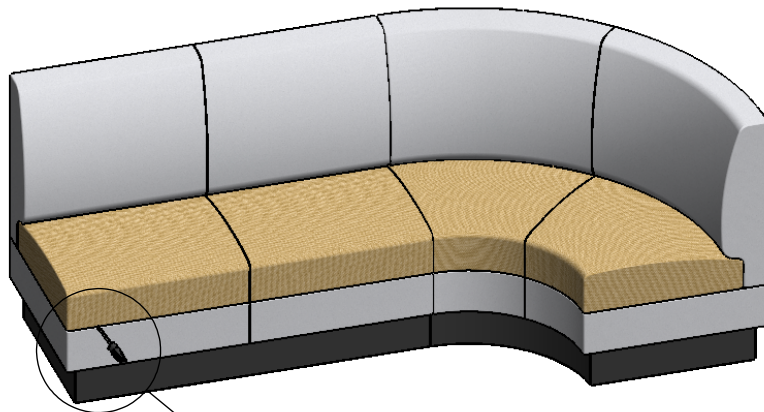

DETAIL A  
SCALE 1 : 12

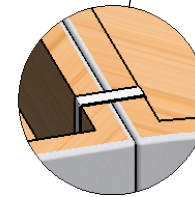
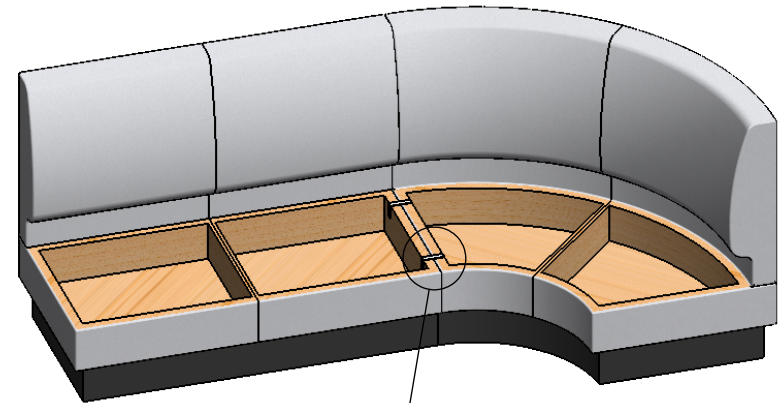

DETAIL B  
SCALE 1 : 8