

## Heya assembly instructions

---





## Important safety instructions

When using an electrical furnishing, basic precautions should always be followed, including the following:

This furnishing is made for commercial use only.

Read all instructions before using this furnishing:

## DANGER

To reduce the risk of electrical shock:

1. Always unplug this furnishing from the electrical outlet before cleaning.

## WARNING

To reduce the risk of burns, fire, electric shock, or injury to persons:

1. Unplug from outlet before putting on or taking off parts.
2. Close supervision is necessary when this furnishing is used by, or near children, invalids, or disabled persons.
3. Use the furnishing only for its intended use as described in these instructions.  
Do not use attachments not recommended by the manufacturer.
4. Never operate this furnishing if it has a damaged cord or plug, if it is not working properly, if it has been dropped or damaged, or dropped in water. Return the furnishing to a service center for examination and repair.
5. Keep the cord away from heated surfaces.
6. Do not use outdoors.
7. Use only SJT 18 AWG cord.
8. Risk of injury. Maximum load 75 pounds.

To reduce the risk of electric shock, this furnishing has a polarized plug (one blade is wider than the other). This plug will fit in a polarized outlet only one way. If the plug does not fit fully in the outlet, reverse the plug. If it still does not fit, contact a qualified electrician to install the proper outlet. Do not change the plug in any way.

**Note** – servicing is only to be performed by an authorized representative.

### Servicing of double-insulated products

In a double-insulated product, two systems of insulation are provided instead of grounding. No grounding means is provided on a double-insulated product, nor is a means for grounding to be added to the product. Servicing a double-insulated product requires extreme care and knowledge of the system, and is to be done only by qualified service personnel. Replacement parts for a double-insulated product must be identical to the parts they replace. A double-insulated product is marked with the words “DOUBLE INSULATION” OR “DOUBLE INSULATED”. The symbol (square within a square) is also able to be marked on the product.

### Save these instructions

## Heya bar height table assembly:

Tools required:

- Cordless drill
- 5/32" Allen wrench
- 3/16" Allen wrench
- 1/4" Allen wrench

1. This sheet covers the necessary steps to fully assemble a Heya bar height runoff table.
2. Begin by inserting the (1609755) 5/16-18 X 2" screw into the foot rail knuckle and threading into the table leg, making sure the knuckle has been mounted in the same orientation as shown in the view above. Repeat this step for the remaining table leg.
3. Next, slip the shortest length foot rail over one end of the knuckle. Align the mounting holes between the knuckle and foot rail and fasten the (1609077) 1/4-20 X 5/8" screws down. Slip the remaining open end of the foot rail over the end of the knuckle on another table leg and fasten down completely as shown in the view above.
4. Position the pair of legs onto the worksurface making sure the holes on the mount plate align with the pre-drilled holes on the worksurface. Fasten the mount plates to the worksurface using the supplied (1608904) #12 X 7/8" screws.

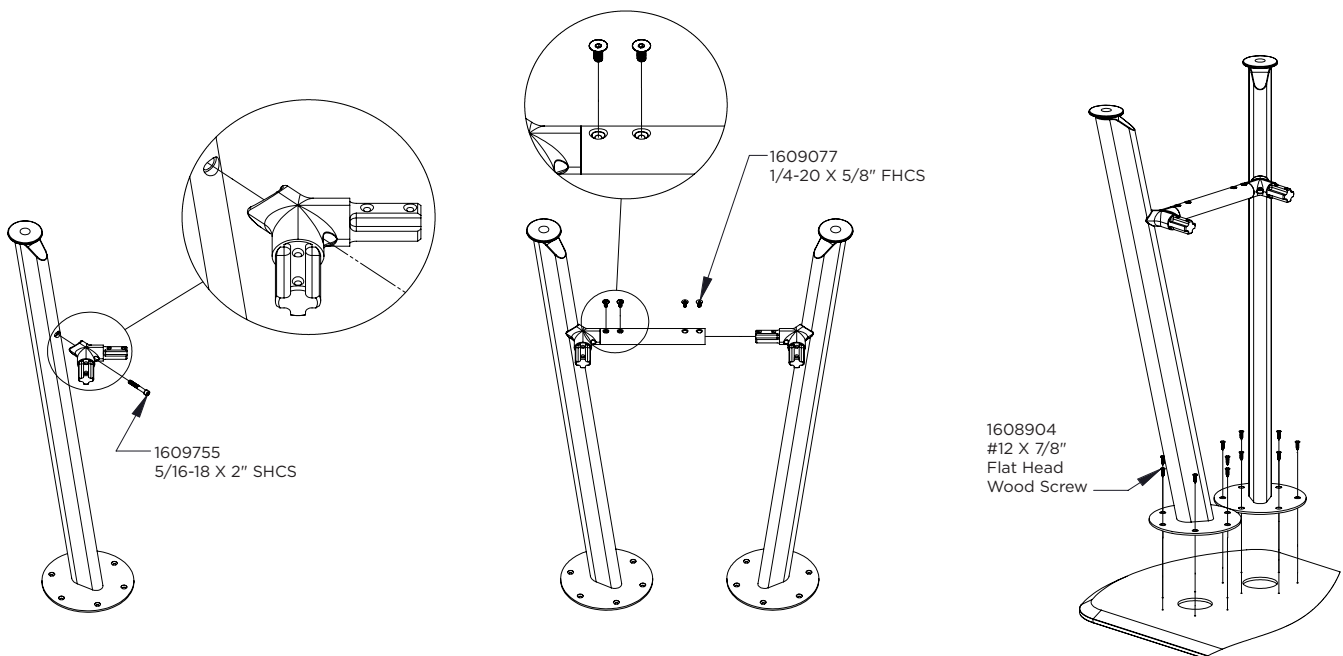

## Heya bar height table assembly:

1. Using the view above, fasten the table bracket to the media screen using the supplied 1/4-20 machine screws. Next, insert the (1609756) 1/4-20 X 1.5" screw into the mount puck and thread into the corresponding hole on the media screen. Making sure the threaded holes on the mount puck are located in the six o'clock position, tighten the screw down completely.
2. The table assembly can now be flipped over and rested onto the table bracket. Have the table slid away from the screen far enough such that the longer foot rails can be slipped over the mount pucks. The table can then be shifted back towards the screen so that the knuckles on the table legs are inserted into the foot rails. Align the holes between the foot rails and knuckles/ mount pucks, then fasten down using the (1609077) 1/4-20 X 5/8" screws. Lastly, fasten the table top down to the table bracket using the supplied (1413679) 1/4-20 X .75" screws as shown in the view above.

