

Intermix collaborative assembly

---



## Intermix collaborative table assembly

Position modesty assembly and end panels near final desired location. (DETAIL A)

Use 1/4-20 x 1 1/2" bolts from hardware kit (HK-138) to attach the modesty assemblies together (This is only done for the 108" and 120" units). (DETAIL B)

Use bolts from HK-138 to attach modesty assemblies to the end panels. The bolts should thread into insert nuts that are installed in the face of the end panels. (DETAIL C)

Take the modular screws from HK-146 and screw them into the (8) small holes on the bottom of the top, until the shoulder of the screw meets the surface. (DETAIL D)

Install joint fasteners to the routes in the bottom of the two top panels to tie them together. (Only used on 108" and 120" tops). (DETAIL E)

Take the top with the modular screws inserted, and set it over the top of the end panels. Slide the top so that the modular screws slide into place, under the lip of the metal connectors, that are inserted in the top of the end panels. (DETAIL F)

Take the screws from the HK-9's and run them through the L-brackets on top of the modesty panel assembly, to secure the top and to finish the assembly. (DETAIL G)

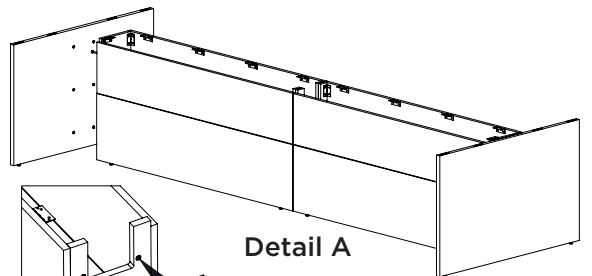

Detail A

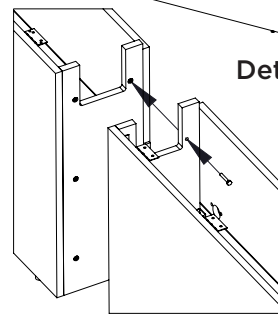

Detail B

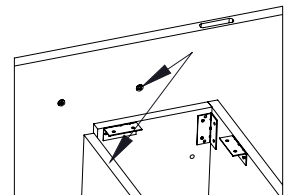

Detail C

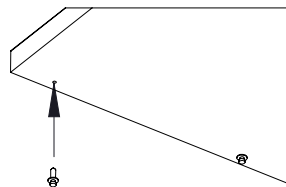

Detail D

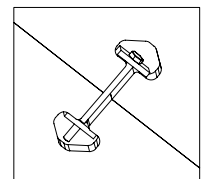

Detail E

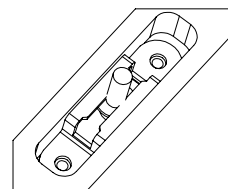

Detail F

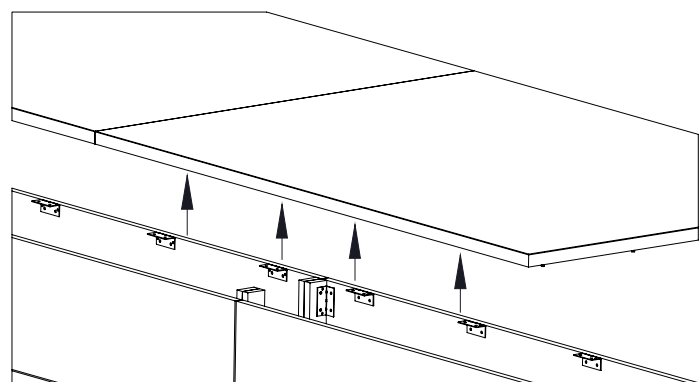
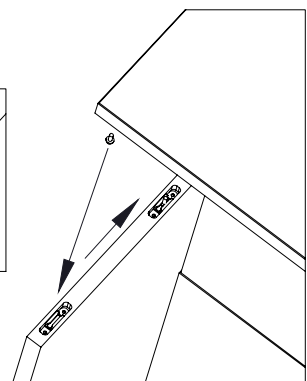

Detail G