

Slide out storage tower 6-1742SOSL1 / 6-1742SOSR1

Overall dimensions	17" w x 30" d x 42" h	Weight	215 lbs.
Exposed wood	Quartered veneer	Cubic feet	5.5

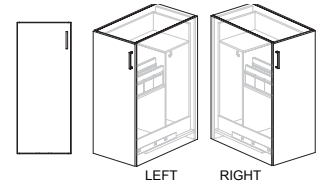

Slide out storage tower 6-1748SOSL1 / 6-1748SOSR1

Overall dimensions	17" w x 30" d x 48" h	Weight	240 lbs.
Exposed wood	Quartered veneer	Cubic feet	8

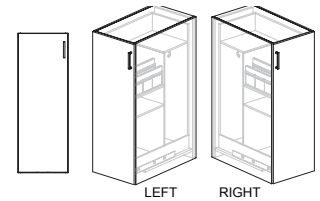

Standard features	Options available
<ul style="list-style-type: none"> Slide out storage unit Full door Coat hook One three section felt pocket One section felt pocket One stationary shelf (6-1742SOSL1 / 6-1742SOSR1) Two stationary shelves (6-1748SOSL1 / 6-1748SOSR1) 	<ul style="list-style-type: none"> USB power Storage tray File drawer Lock Pull style, finish, and location Felt pocket finish Outer case / inner case / door finish

Slide out storage tower 6-1742SOSL2 / 6-1742SOSR2

Overall dimensions	17" w x 30" d x 42" h	Weight	220 lbs.
Exposed wood	Quartered veneer	Cubic feet	5.5

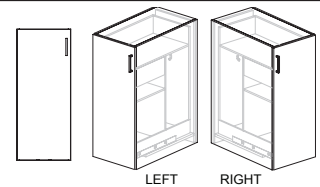

Slide out storage tower 6-1748SOSL2 / 6-1748SOSR2

Overall dimensions	17" w x 30" d x 48" h	Weight	245 lbs.
Exposed wood	Quartered veneer	Cubic feet	8

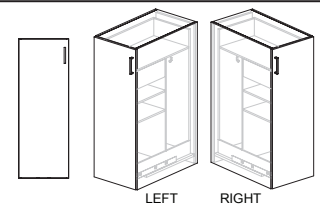

Standard features	Options available
<ul style="list-style-type: none"> Slide out storage unit Full door Full top shelf on slide out unit Coat hook Box drawer Two stationary shelves (6-1742SOSL2 / 6-1742SOSR2) Three stationary shelves (6-1748SOSL2 / 6-1748SOSR2) 	<ul style="list-style-type: none"> USB power Toolrail File drawer Lock Pull style, finish, and location Outer case / inner case / door finish



Slide out storage tower 6-1742SOSL3 / 6-1742SOSR3

Overall dimensions	17"w x 30"d x 42"h	Weight	205 lbs.
Exposed wood	Quartered veneer	Cubic feet	5.5

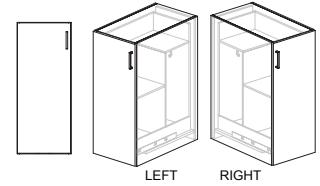

Slide out storage tower 6-1748SOSL3 / 6-1748SOSR3

Overall dimensions	17"w x 30"d x 48"h	Weight	230 lbs.
Exposed wood	Quartered veneer	Cubic feet	8

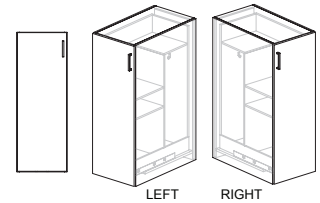

Standard features	Options available
<ul style="list-style-type: none"> Slide out storage unit Full door Coat hook Two stationary shelves (6-1742SOSL3 / 6-1742SOSR3) Three stationary shelves (6-1748SOSL3 / 6-1748SOSR3) 	<ul style="list-style-type: none"> USB power Storage tray Toolrail File drawer Lock Pull style, finish, and location Outer case / inner case / door finish

Slide out storage tower 6-1742SOSL1S / 6-1742SOSR1S

Overall dimensions	17"w x 22"d x 42"h	Weight	215 lbs.
Exposed wood	Quartered veneer	Cubic feet	11.5

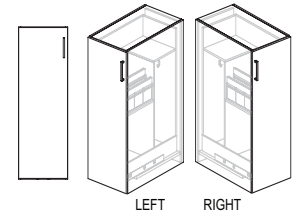

Slide out storage tower 6-1748SOSL1S / 6-1748SOSR1S

Overall dimensions	17"w x 22"d x 48"h	Weight	240 lbs.
Exposed wood	Quartered veneer	Cubic feet	13

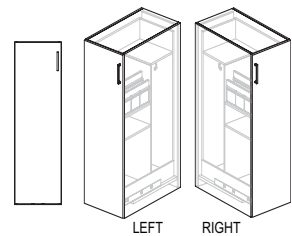

Standard features	Options available
<ul style="list-style-type: none"> Slide out storage unit Full door Coat hook One three section felt pocket One section felt pocket One stationary shelf (6-1742SOSL1S / 6-1742SOSR1S) Two stationary shelves (6-1748SOSL1S / 6-1748SOSR1S) 	<ul style="list-style-type: none"> USB power Storage drawer Lock Pull style, finish, and location Felt pocket finish Outer case / inner case / door finish



Slide out storage tower 6-1742SOSL2S / 6-1742SOSR2S

Overall dimensions	17"w x 22"d x 42"h	Weight	220 lbs.
Exposed wood	Quartered veneer	Cubic feet	11.5

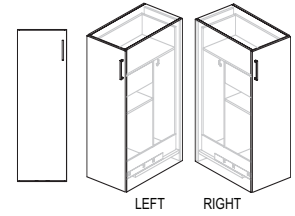

Slide out storage tower 6-1748SOSL2S / 6-1748SOSR2S

Overall dimensions	17"w x 22"d x 48"h	Weight	245 lbs.
Exposed wood	Quartered veneer	Cubic feet	13

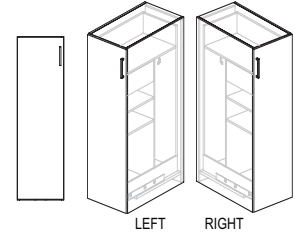

Standard features	Options available
<ul style="list-style-type: none"> Slide out storage unit Full door Full top shelf on slide out unit Coat hook Box drawer Two stationary shelves (6-1742SOSL2S / 6-1742SOSR2S) Three stationary shelves (6-1748SOSL2S / 6-1748SOSR2S) 	<ul style="list-style-type: none"> USB power Toolrail Storage drawer Lock Pull style, finish, and location Outer case / inner case / door finish

Slide out storage tower 6-1742SOSL3S / 6-1742SOSR3S

Overall dimensions	17"w x 22"d x 42"h	Weight	205 lbs.
Exposed wood	Quartered veneer	Cubic feet	11.5

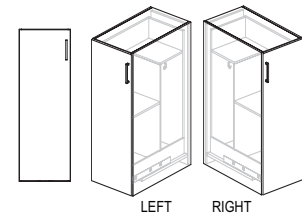

Slide out storage tower 6-1748SOSL3S / 6-1748SOSR3S

Overall dimensions	17"w x 22"d x 48"h	Weight	230 lbs.
Exposed wood	Quartered veneer	Cubic feet	13

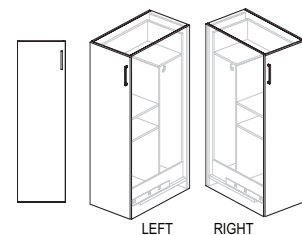

Standard features	Options available
<ul style="list-style-type: none"> Slide out storage unit Full door Coat hook Two stationary shelves (6-1742SOSL3S / 6-1742SOSR3S) Three stationary shelves (6-1748SOSL3S / 6-1748SOSR3S) 	<ul style="list-style-type: none"> USB power Toolrail Storage drawer Lock Pull style, finish, and location Outer case / inner case / door finish



Standard finish selection

<http://ofs.com/resources/finishes>

Outer case

- 3/4" Thick particle board core faced with TFL or veneer
- Cam and Bolt construction including pocket bores and wood screws

Inner slide out case

- 3/4" Thick particle board core on end, back, and bottom panels faced with TFL
- 1/2" Thick particle board core on shelves, top and divider panels faced with TFL
- Cam and Bolt construction including pocket bores and wood screws
- Heavy-duty under mount slides with soft closing feature as well as side stabilizing and soft stopping hardware
- Available in black or frosty white TFL with optional dry erase marker board back panel

Accessories

- Adhered PET felt backer with felt pocket and elastic strap overlay. (specific models only)
- Mitered box drawer (specific models only)
- Optional aluminum storage accessory tool rail (specific models only), PET storage tray, mitered filing drawer (letter filing front to back only) and USB power

Pulls

- Parallel or Bow
 - Parallel is available in satin nickel
 - Standard / studio powder coat finishes and polished aluminum

Glides

- Non-marring adjustable glides on outer case
- Soft wheel adjustable casters on inner slide out

Carton/packaging

- Unit is packed in a carton
- Cardboard edge protector is placed around the edges of the outer case