

Adler assembly





Table of contents

Height adjustable cantilever desk	3
Height adjustable L desk connection	4-5
H and O leg attachment	6
T riser	6
Removing drawer pedestals	7
Corner pedestal to open storage	8
Static back panel	9
Fold down back panel	10
Overlay worksurface	11
Wing end assembly	12
End panel	12-13
Support panel	14
Support base	15
Partial height modesty	15
Seat cushion	16
Straightener rail	17
Wallmount attachment	18
Shelf tower attachment	19
Task lighting	20

Height adjustable cantilever desk

Note: Cabinet back must be secured to wall with at least one bracket securing to a stud

1. Place cabinet into position along the wall and level worksurface. **Note:** It may be helpful to use the filler box from packaging to support the worksurface runoff end until the cabinet is attached to the wall.
2. Locate and mark center of wall studs or other structural member and align the L brackets in cabinet with center markings (**Figure A**). **Note:** At least one L bracket must connect to a structural wall component.
3. Attach L bracket to structural wall component using appropriate hardware provided by customer. If attaching to a wooden stud, a $\frac{1}{4}$ " x 2" long lag screw is recommended (**Figure B**).
4. Tighten bolts connecting L bracket to the cabinet bracket.
5. If adjacent storage unit is available, use $\frac{1}{4}$ " wood screws to attach to storage end panels for additional support (**Figure C**).

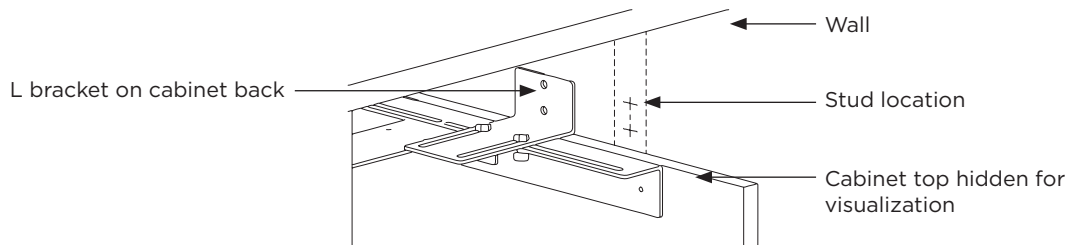

Figure A

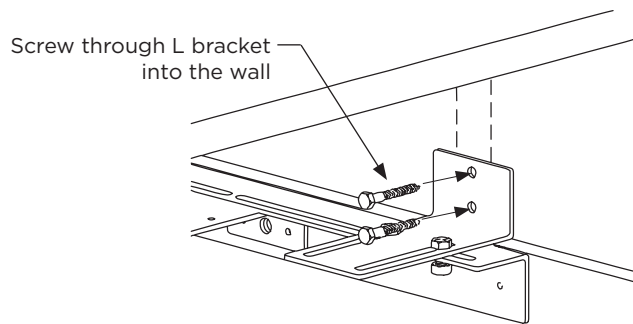

Figure B

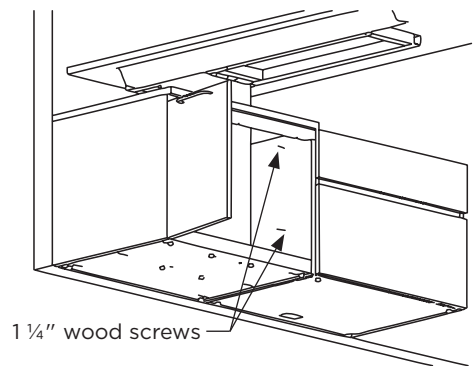
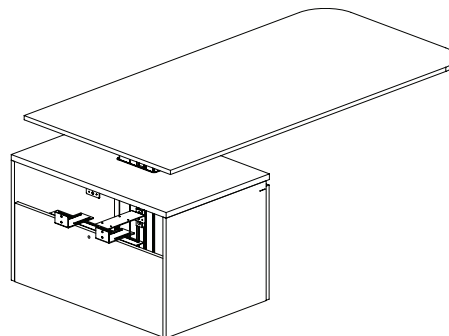

Figure C



Cabinet back reference

Height adjustable - ganging L groups

1. Place units into place and level, ensure that both units are the same height when leveled. Hold both tops flush and attach ganging plates with eight screws each. **(Figure A)**
2. Gang the bottom after the worksurface with three screws spread through the height of the unit inside either the desk leg or return/bridge back. **(Figure B)**

Continue to connecting connecting cables for L desks step.

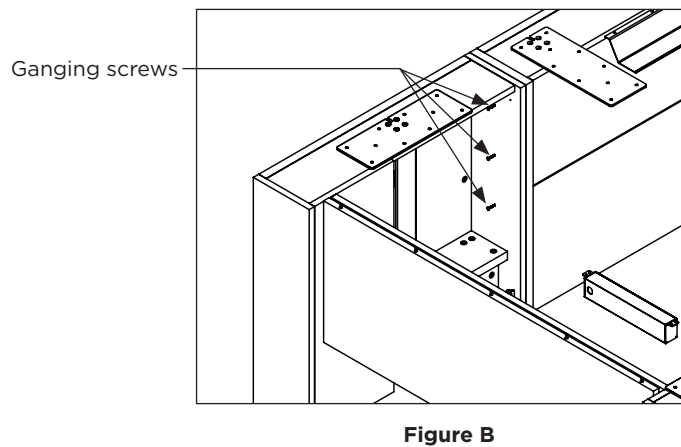
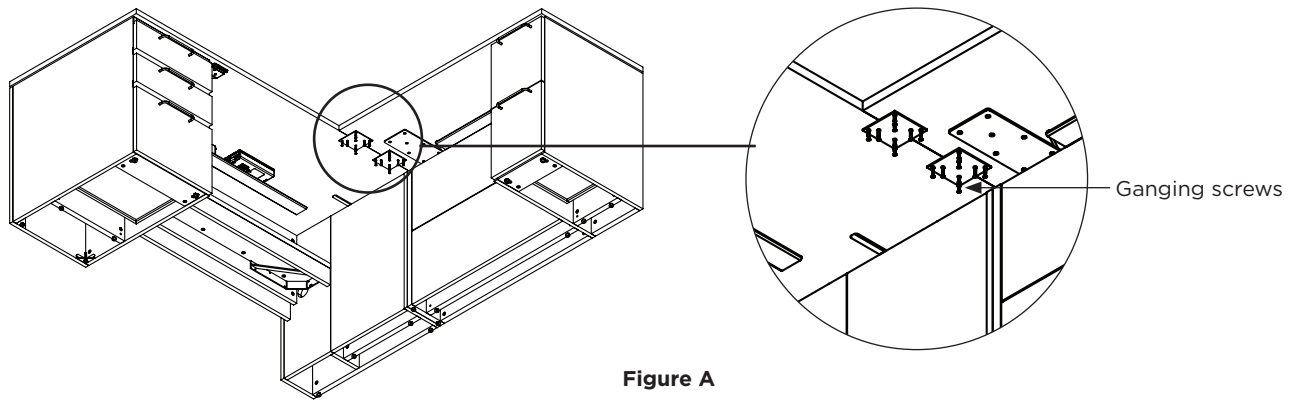

Height adjustable - connecting cables for L desks

1. Connect cables to the control box using the standard 3ft cables to the desk. Use the long 10ft cables to connect to the ajoined unit, run cables through wire trays and attach to surface with p-clips to avoid sagging. Coil extra cable and wire-tie in cable tray

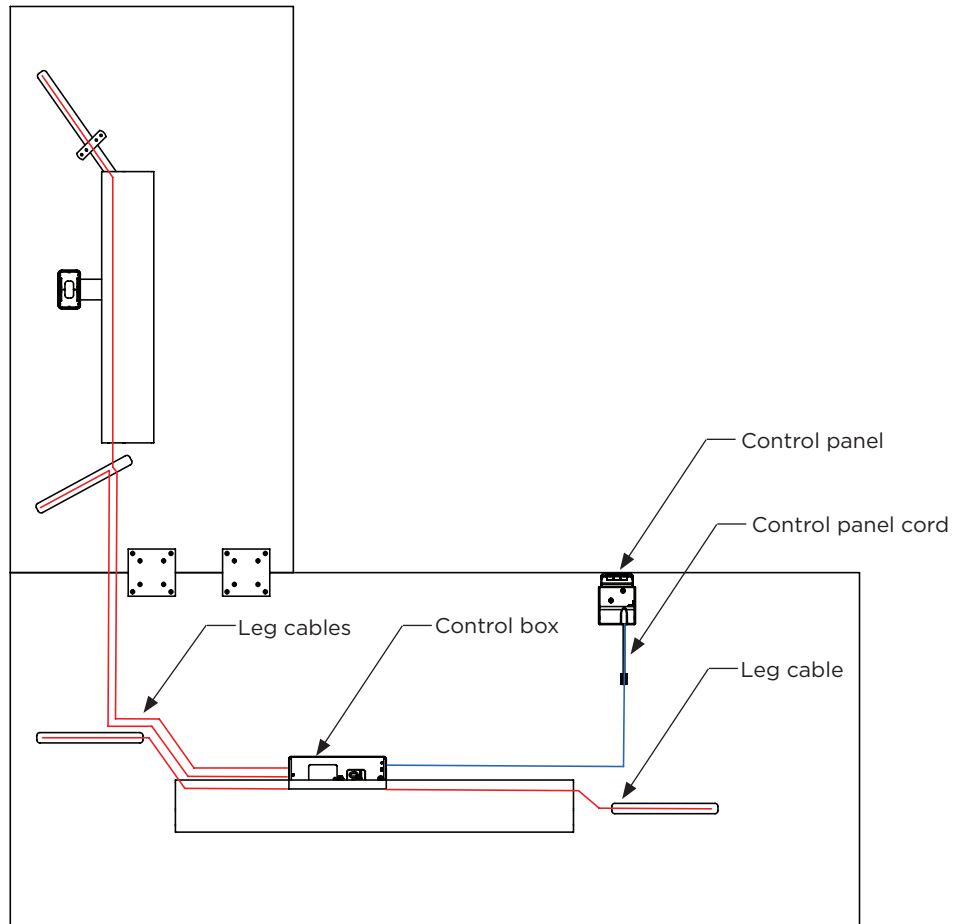

H and O leg attachment

1. Leg should set in $\frac{1}{8}$ " from edges and attached with #12 1" wood screws.

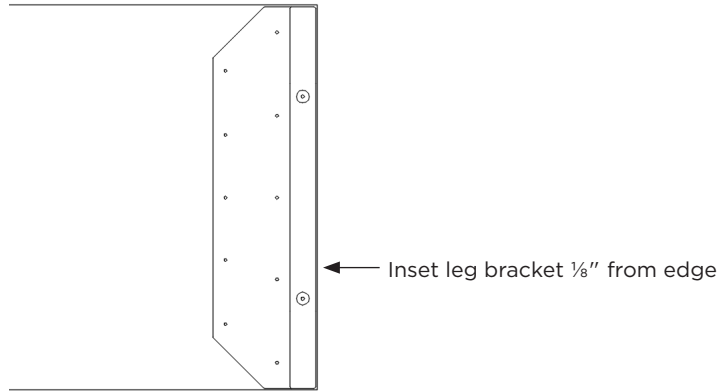

T riser

1. Mark center of worksurface and also at least 12" from back edge to align T riser support. Placing at least 12" from edge will ensure clearance of a grommet if specified.
2. Attach L brackets to T riser support with $\frac{5}{8}$ " wood screws.
3. Align T riser support with markings from step one and attach to the worksurface with $\frac{5}{8}$ " wood screws.

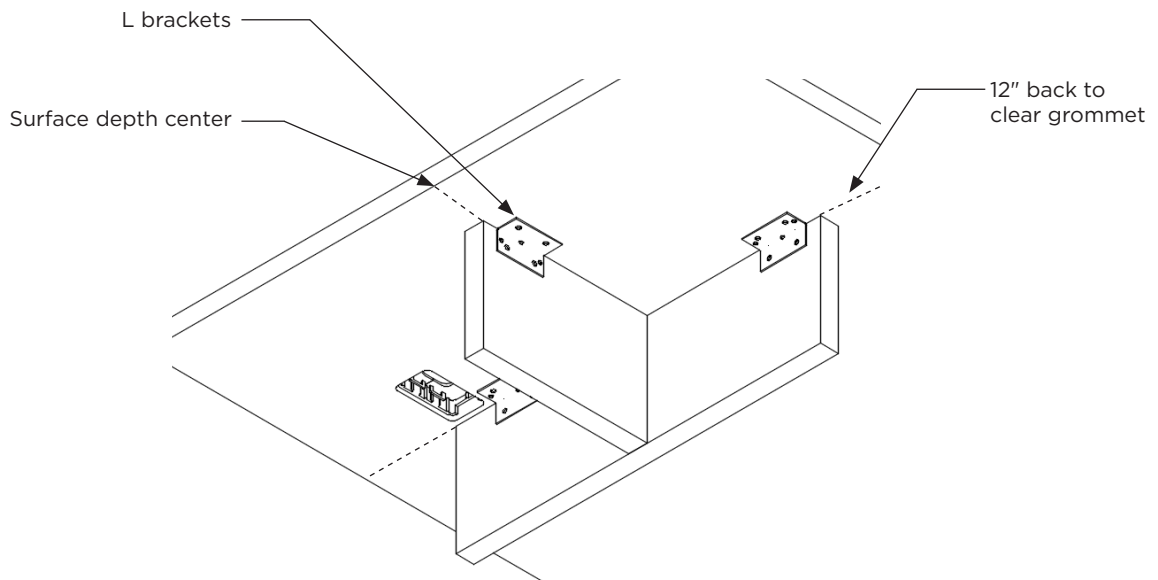

Removing pedestal drawers

1. Open drawer to full extension.
2. Push drawer release on right hand slide down and at the same time, push drawer release on the left hand slide up.
3. Pull drawer forward until free from slides.
4. Secure pedestal to top using screws.

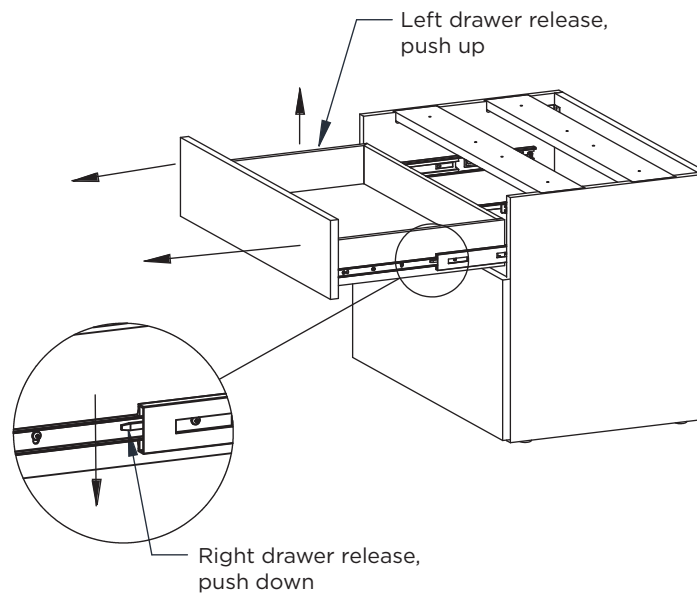

Corner pedestal to open storage

1. Slide open shelf cabinet up tight against the corner cabinet support back. The open shelf end panel should fit completely under the corner cabinet top (**Figure A**).
2. Attach open storage cabinet to corner cabinet with two 1 ¼" wood screws. Use two unused pin holes directly below shelf as attachment locations (**Figure B**).

Note: Open shelf pedestal for corner pedestals is ¾" wider than standard modular open shelf pedestals. If multiple open shelf pedestals are specified, ensure the correct one is installed.

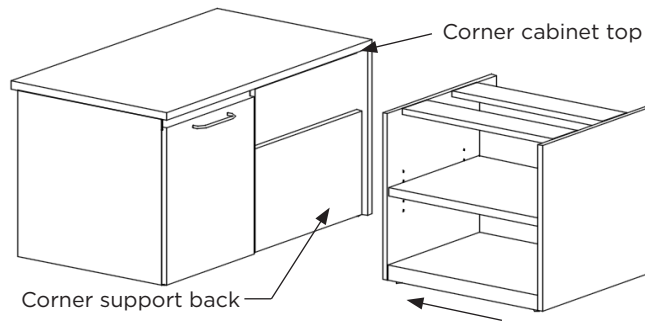

Figure A

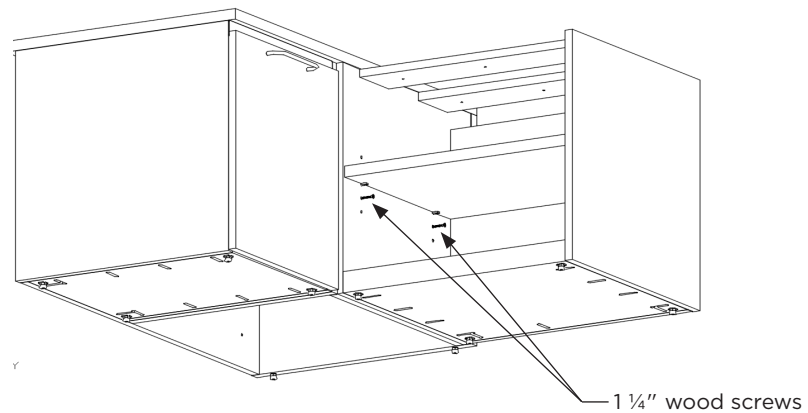

Figure B

Static back panel

1. Remove drawers to access back rails (**Figure A**). See [removing pedestal drawers](#) section for more information.
2. Align back panel flush to outside end and top edge of pedestal.
3. Use four 1 ¼" wood screws to attach pedestal to back panel (**Figure B**).

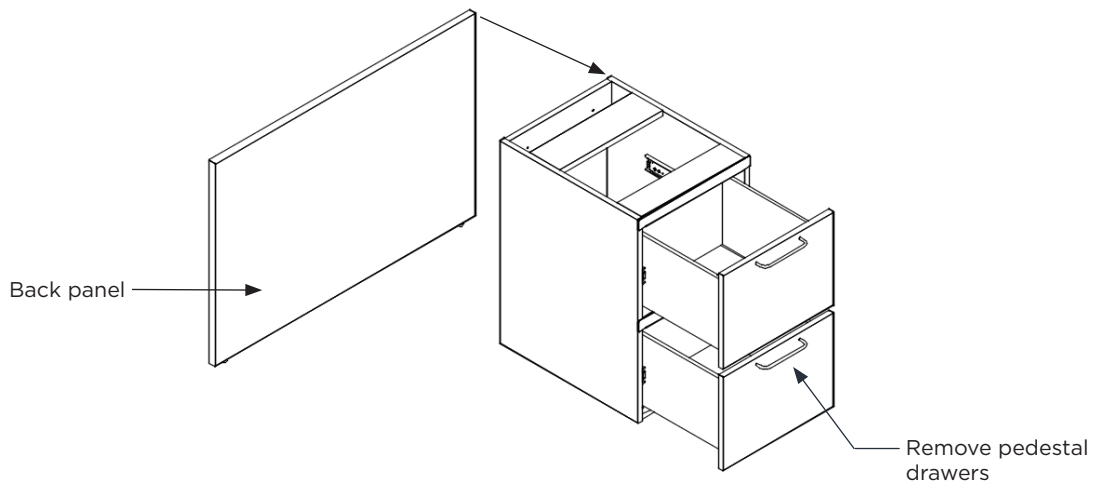

Figure A

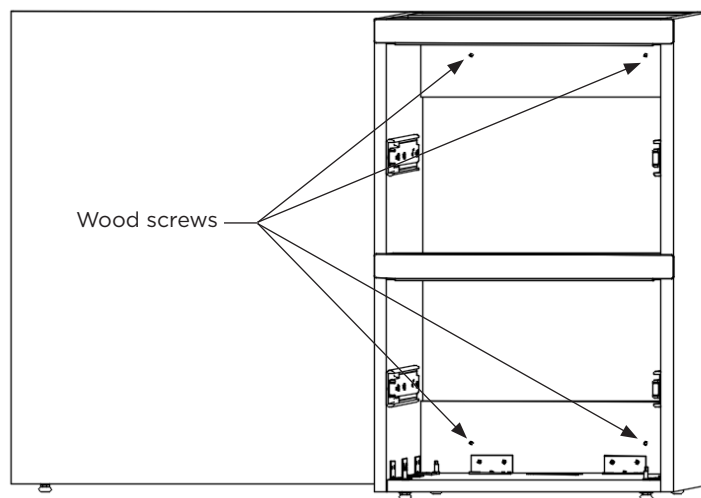

Figure B

Fold down back panel

1. Align fold down modesty end panel with adjoining pedestal or support end and attach with three 1 ¼" wood screws (**Figure A**).
2. Attach modesty to top using ⅝" wood screws. Attach through L brackets on both ends of the modesty (**Figure B**).
3. If installing a two door fold down modesty, attach cantilever shelf bracket in the center using ⅝" wood screws (**Figure C**).

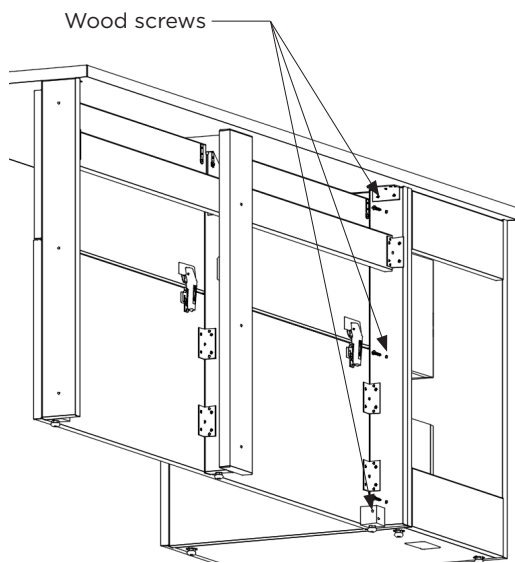

Figure A

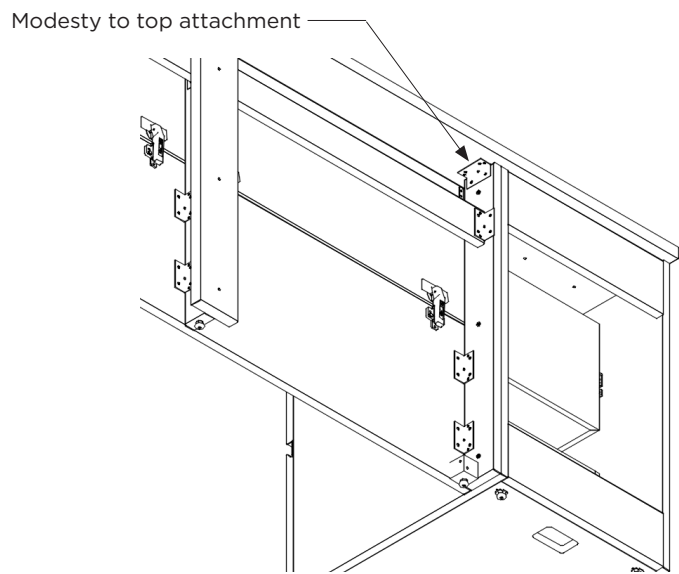

Figure B

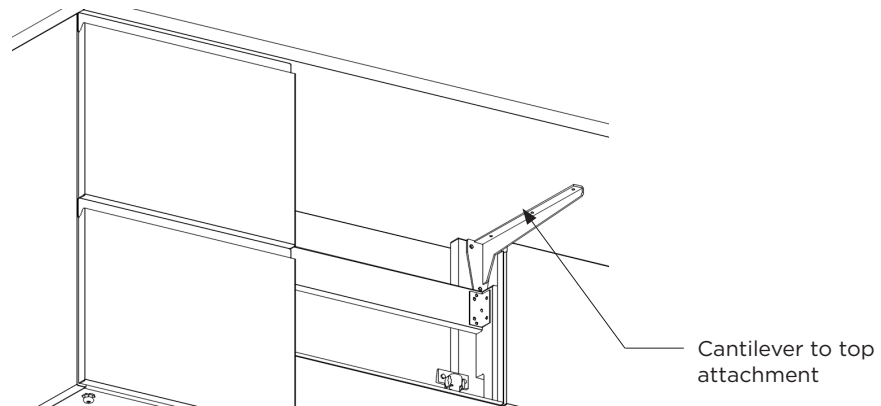

Figure C

Overlay worksurface

1. Remove drawer components to access top rails for attaching the top to the desk height pedestal. See [removing pedestal drawers](#) section for more information.

Note: If a back panel is specified, move to step 2. If no back panel is specified, move to step 3.

2. Attach L brackets (HK-10, shipped with back panel) to the top of the back panel (**Figure A**).
3. Place overlay top panel on unit and make sure edges are flush to back and end panels.
4. Use HK-276 hardware kit to attach non riser end of worksurface to the pedestal. HK-276 contains three 2 ¼" long wood screws and three 1 ¼" wood screws. **Note:** Use 2 ¼" screws on 1 ½" thick front rail only (**Figure B**).

Note: If no back panel is specified, this installation is complete. If a back panel is specified, move to step 5 to complete.

5. Attach back panel to top with ¾" wood screws provided with the HK-10 hardware kit. **Note:** 90 degree driver recommended due to small space (**Figure C**).

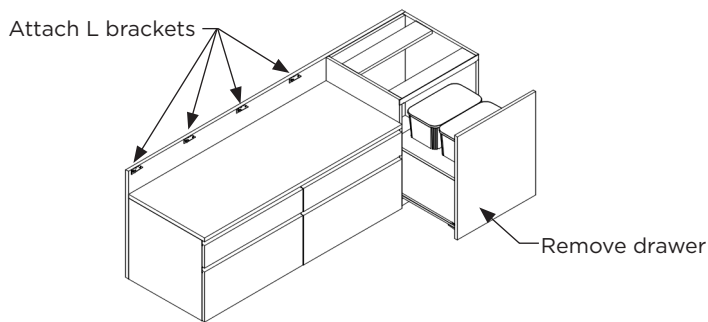

Figure A

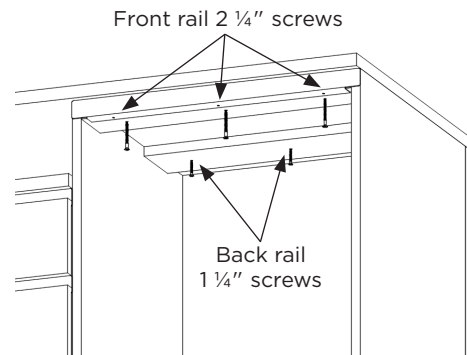

Figure B

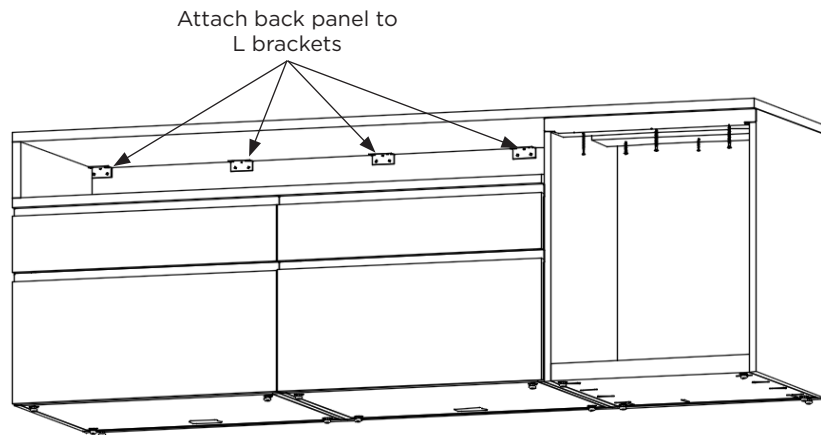
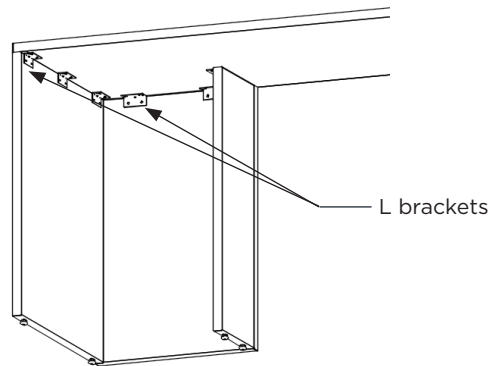

Figure C

Wing end assembly

1. Position wing end assembly flush to the front and side edge of the worksurface.
2. Screw L brackets to top using #10 x $\frac{5}{8}$ " pan head screws (HK-9).



End panel - no additional support

1. Position end panel flush to the front and side edge of the worksurface.
2. Screw L brackets to top using #10 x $\frac{5}{8}$ " pan head screws (HK-10).
3. Screw drop bracket to top and end panel using #10 x $\frac{5}{8}$ " pan head screws (HK-9).

Note: One drop bracket is used on 24"d worksurfaces, two drop brackets are used on 30"d and 36"d worksurfaces.

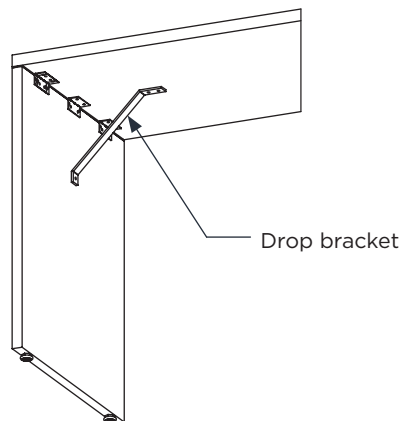

End panel - used with back panel

1. Position end panel flush to the front and side edge of the worksurface.
2. Screw L brackets to top using #10 x 5/8" pan head screws (HK-10).
3. Position modular back panel perpendicular against modular end panel and flush to back edge of worksurface.
4. Screw back panel to end panel using 25" L bracket with #8 x 5/8" flat head screws (HK-11) and screw L brackets to the worksurface using #10 x 5/8" pan head screws (HK-10).

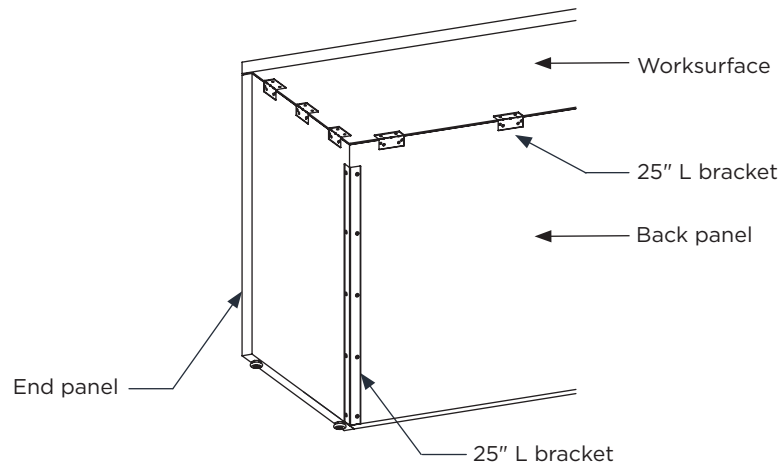

End panel/back panel - worksurface attachment

1. Attach end panel to worksurface using three L brackets evenly spaced.
2. Attach back panel to worksurface using two L brackets every 12" in spacing.
3. Use four #8 x 5/8" screws per bracket.

Note: Keep back edge of top and back face of modular back flush. Also keep outside face edge of end flush with edge of top.

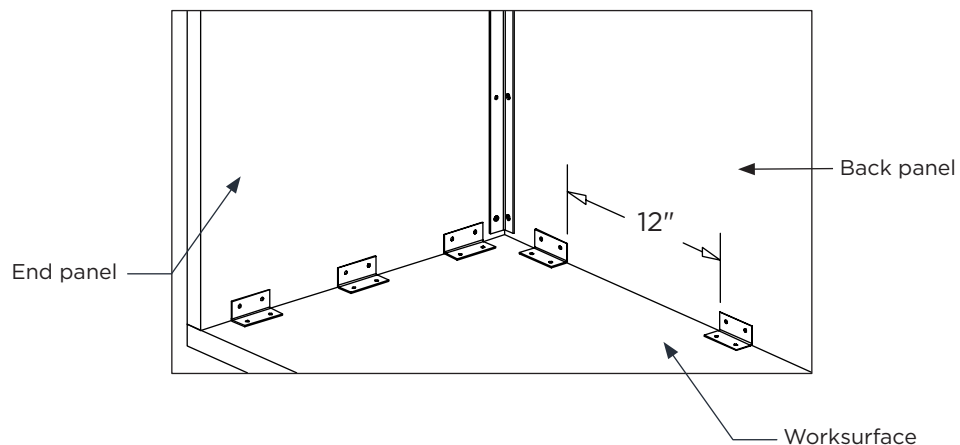

Support panel - used with back panel

1. Place back panel support in center of span between supports (pedestals, cantilever, etc).
2. Screw L brackets to the back panel and worksurface using #10 x 5/8" pan head screws (HK-10) and #8 x 5/8" flat head screws (HK-11).

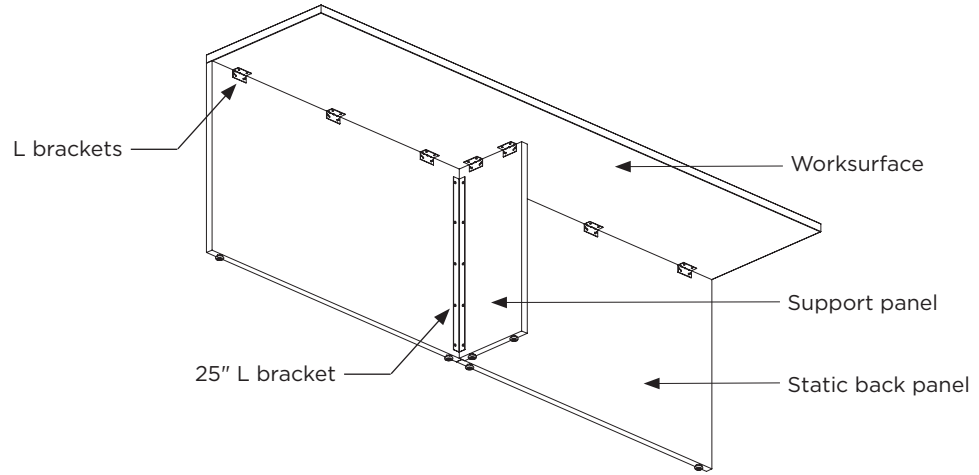

Support panel - used with end panel

1. Place support panel perpendicular to the end panel, flush with the back of the worksurface.
2. Screw to end panel and worksurface using #10 x 5/8" pan head screws (HK-10) and #8 x 5/8" flat head screws (HK-11).

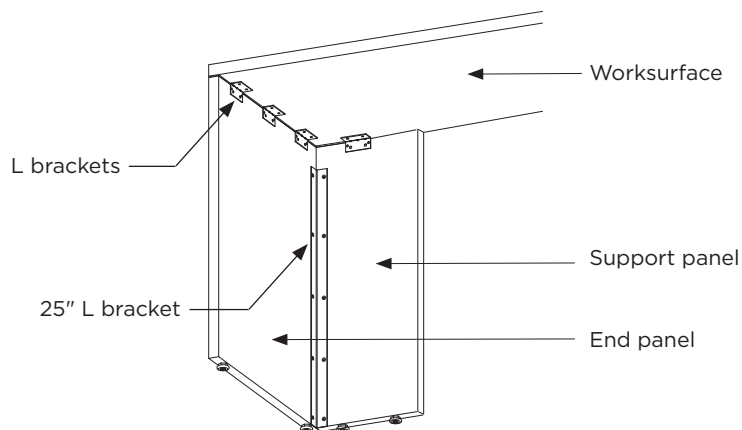

Support base

1. Position support base in center of open span.
2. Screw to underside of the worksurface using L brackets and #10 x 5/8" pan head screws (HK-9).

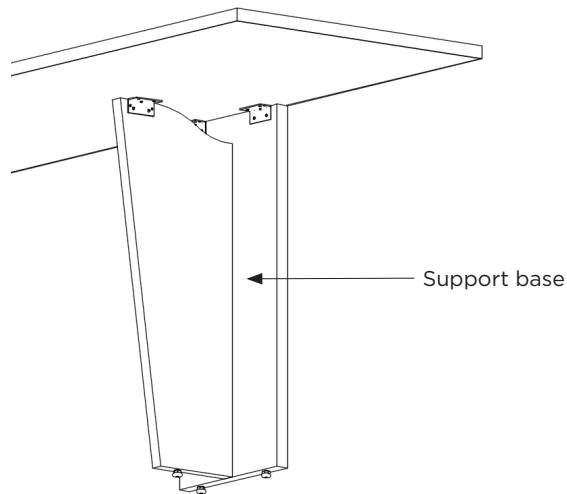

Partial height modesty

1. Attach L brackets to modesty panel using 1/4-20 x 5/8" bolts (**Figure A**). The modesty is pre drilled to locate the brackets.
2. Mark a parallel line minimum 2" in from approach edge. Align modesty bracket holes with marking and attach to top with provided wood screws (**Figure B**).

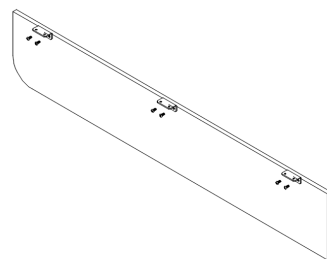

Figure A

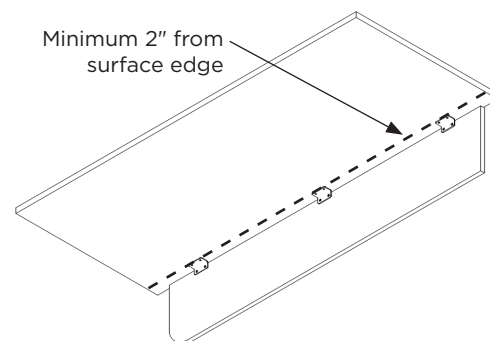

Figure B

Seat Cushion Installation

1. Check furniture installation drawing for cushion locations.
2. Peel protective backing from Dual-Lock strips to expose adhesive on the cushion (**Figure A**).
3. Position cushion where desired with back edge flush to back edge of the case. Usually the cushion will also be flush to the side of the case (**Figure B**).
4. Apply pressure to cushion to seat the adhesive.

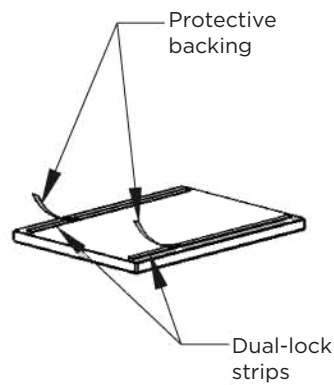

Figure A

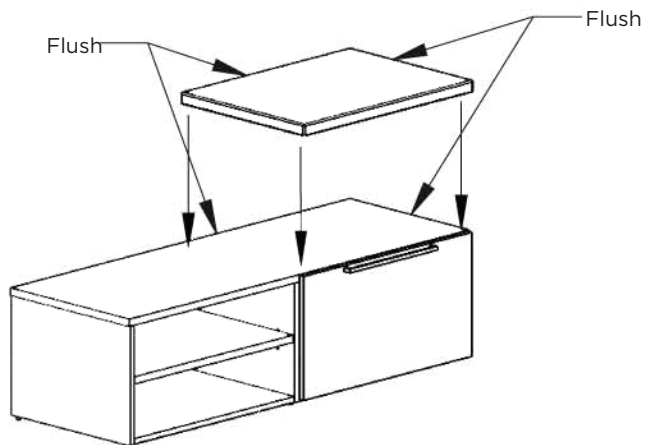

Figure B

Straightener Rail Installation

1. Create a workspace to allow you to reverse bow the worksurface. The workspace should be large enough to accommodate the worksurface size.
2. Place the worksurface upside down and add ¼" to ½" thick shims at each end, between your workspace surface and the worksurface you are applying the straightener rail to (**Figure A**).
3. Clamp your workspace surface and worksurface together near the center to create a slight reverse bow. Additional clamps may be needed depending on the worksurface length (**Figure A**).
4. Center the rail in the unsupported area and space as shown (**Figure B**).
5. Attach the straightener rail based on the worksurface depth using the provided hardware. Reference list below for sizing and placement.
 - **SPTR48** for 48-54" unsupported area use Hardware Kit **HK-21**
 - **SPTR54** for 55-60" unsupported area use Hardware Kit **HK-22**
 - **SPTR60** for 61-66" unsupported area use Hardware Kit **HK-23**
 - **SPTR66** for 67-78" unsupported area use Hardware Kit **HK-25**
6. Remove clamps and shims, and attach the worksurface to pedestals and/or supports as needed.

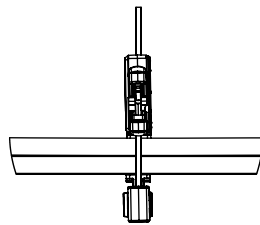

Figure A
Elevation view

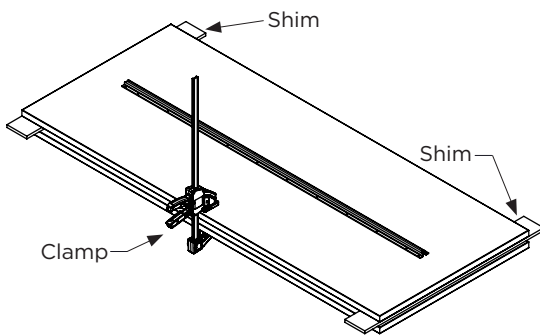

Figure A

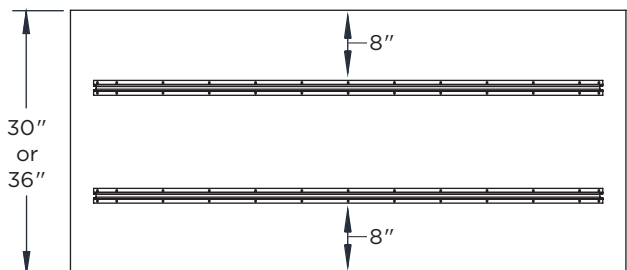
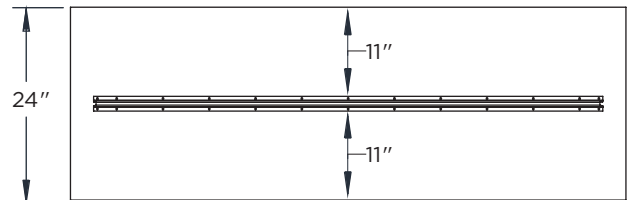

Figure B

Wallmount attachment

Note: These assembly instructions are used for both wallmount organizers and wallmount media panels.

1. Place the hanging bracket that will be attached to the wall into the hook on the organizer or media panel. Measure from the bottom edge of the organizer or media panel to the bottom edge of the hanging bracket. These measurements will then be transferred to the wall you intend to hang the unit on (**Figure A**).
2. Before transferring measurements to wall be sure unit below the organizer or wall panel is leveled and in its final position.
3. Transfer measurements to wall referencing top face of unit below as a starting point. Draw a level line to ensure brackets remain level when attached. Align bottom edge of bracket with line and attach with proper wall anchors (**Figure B**).
4. Hang organizer or media panel on the wall. Be sure all brackets are engaged (**Figure C**).

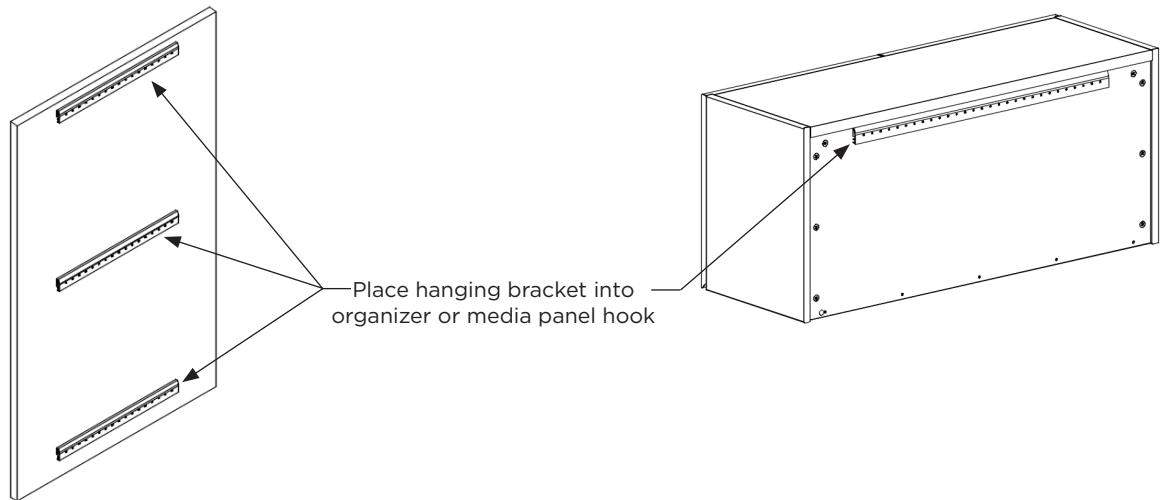

Figure A

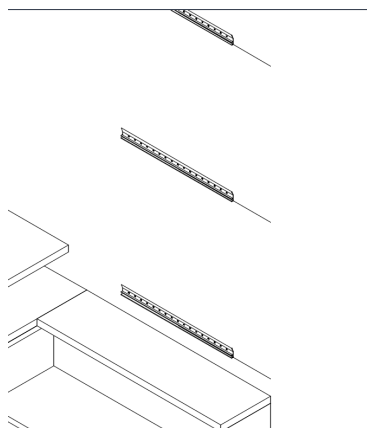

Figure B

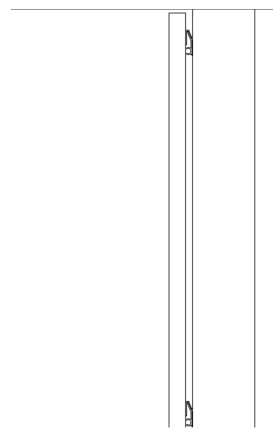
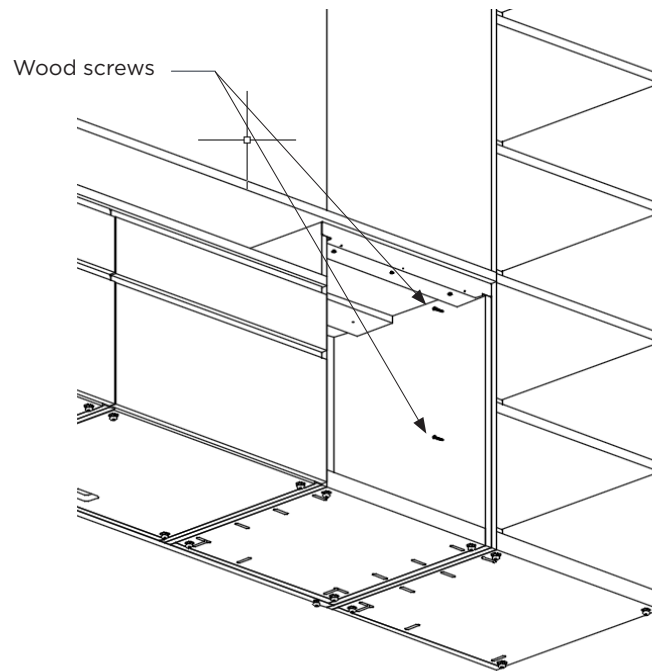

Figure C

Shelf tower attachment

1. Align shelf tower end panel flush with adjoining cabinet or tower end panel. Use two 1 ¼" wood screws to join these two end panels. Install the screws in drawer space of cabinet or near underside of top if open bookcase cabinet.



Task lighting

Thank you for choosing Häfele lighting. Your remote wireless switch will control your lights.

1. Tap - lights on / press & hold - brightness up
2. Press & hold - color temperature up (cooler)
3. Press & hold - color temperature down (warmer)
4. Press & hold - brightness down

For technical questions, you may contact Häfele's lighting technical services by calling 1-800-423-3531 and following the voice prompts.



Scan for installation guide