



Riff Tables

RIFF-NIC, BAR HEIGHT AND TENNIS TABLE
ASSEMBLY INSTRUCTIONS

ofs

Riff-Nic, Bar Height and Tennis Table Assembly Instructions

84" & 72" LONG

RIFF TABLE COMPONENTS

	QTY
1 Top	1
2 Leg Assembly	2
3 Support Assembly	1
4 Cross Rail	1
5 Brace	2
6 1000599/Leveler	4
7 #8 x 2 1/2" Pan Head Screws (HK-101)	10
8 #8 x 2" Pan Head Screws (HK-102)	4
9 #8 x 1 1/2" Pan Head Screws (HK-103)	4
10 #8 x 1 1/4" Pan Head Screws (HK-104)	8
11 #8 x 5/8" Pan Head Screws (HK-105)	20

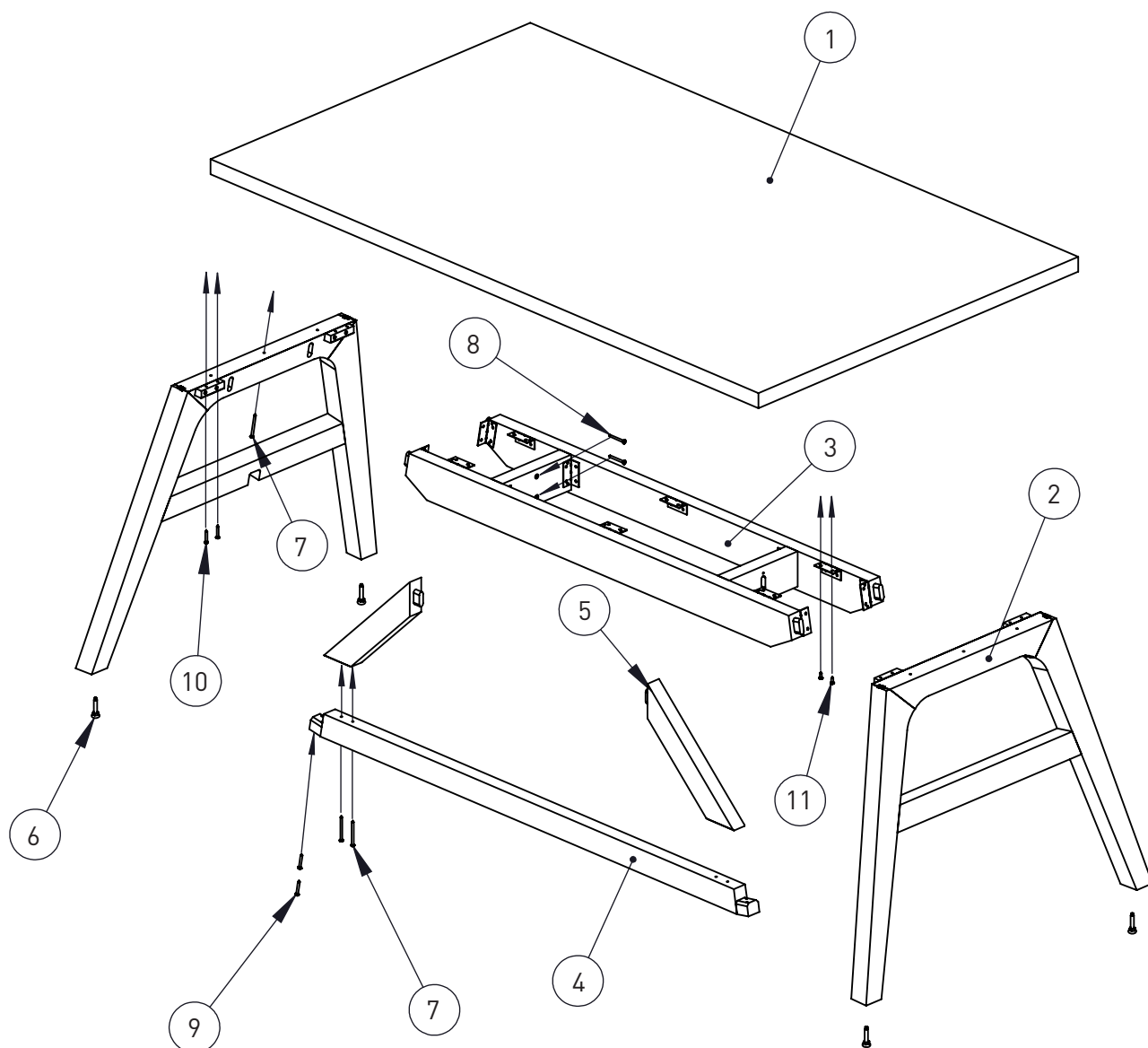

Riff-Nic, Bar Height and Tennis Table Assembly Instructions

96" & 108" LONG

RIFF TABLE COMPONENTS

	QTY
1 Top	1
2 Leg Assembly	2
3 Center Leg Assembly	1
4 Support Assembly	1
5 Cross Rail-Under	1
6 Cross Rail-Over	1
7 Brace	2
8 1000599/Leveler	6
9 #8 x 2 1/2" Pan Head Screws (HK-101)	13
10 #8 x 2" Pan Head Screws (HK-102)	6
11 #8 x 1 1/2" Pan Head Screws (HK-103)	4
12 #8 x 1 1/4" Pan Head Screws (HK-104)	16
13 #8 x 5/8" Pan Head Screws (HK-105)	28

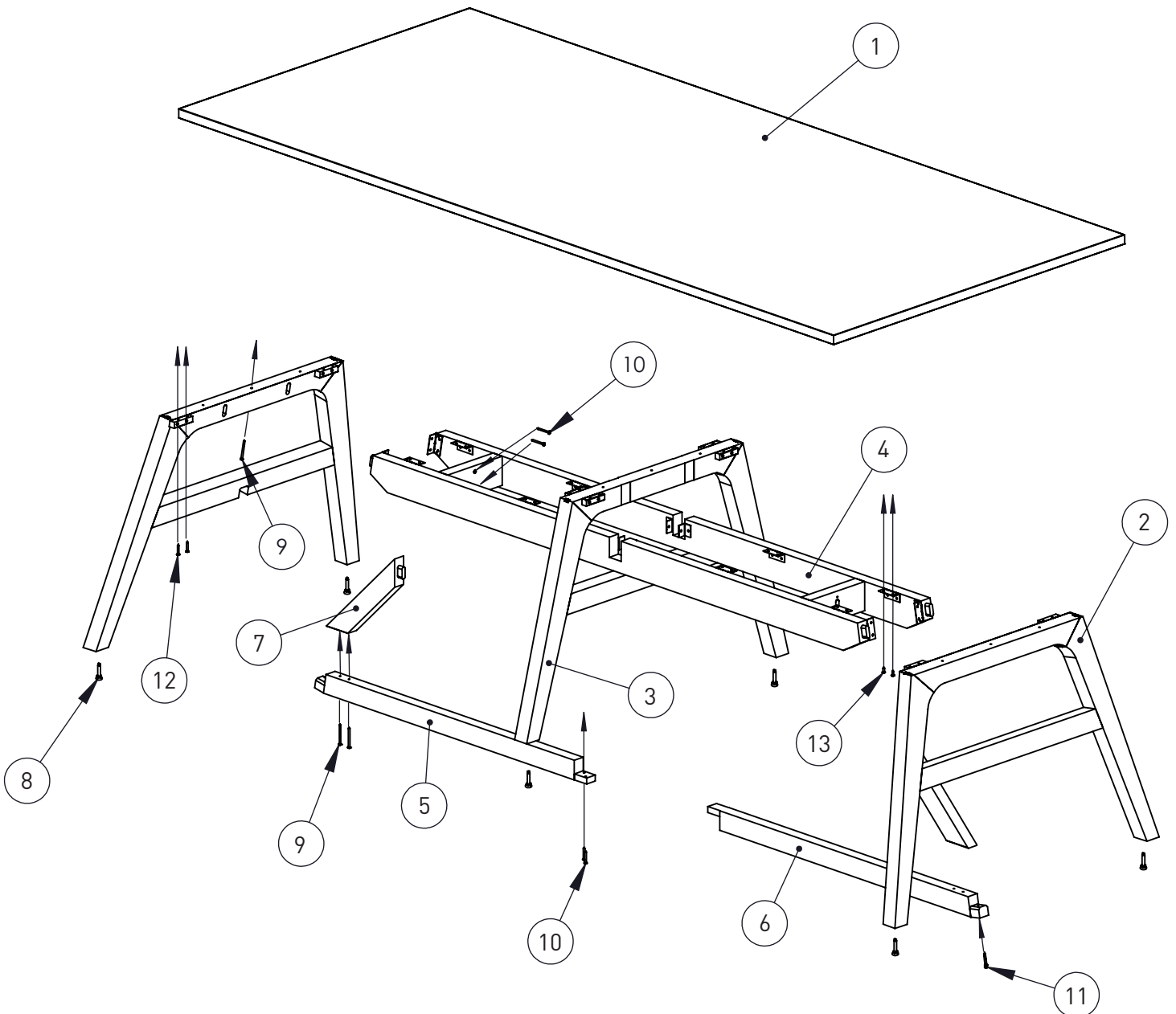

Riff-Nic, Bar Height and Tennis Table Assembly Instructions

STEP 1

1. Place Worksurface, bottom side up, on a non-marring surface.
2. Align Notches and slide Under Top Assembly onto Center Base (96" and 108" long tops only).
3. Connect End Bases to Under Top Assembly by inserting Tenons into mortises.
4. Secure Bases to Under Top Assembly with #8 x $\frac{5}{8}$ " Pan Head Screws (HK-105).

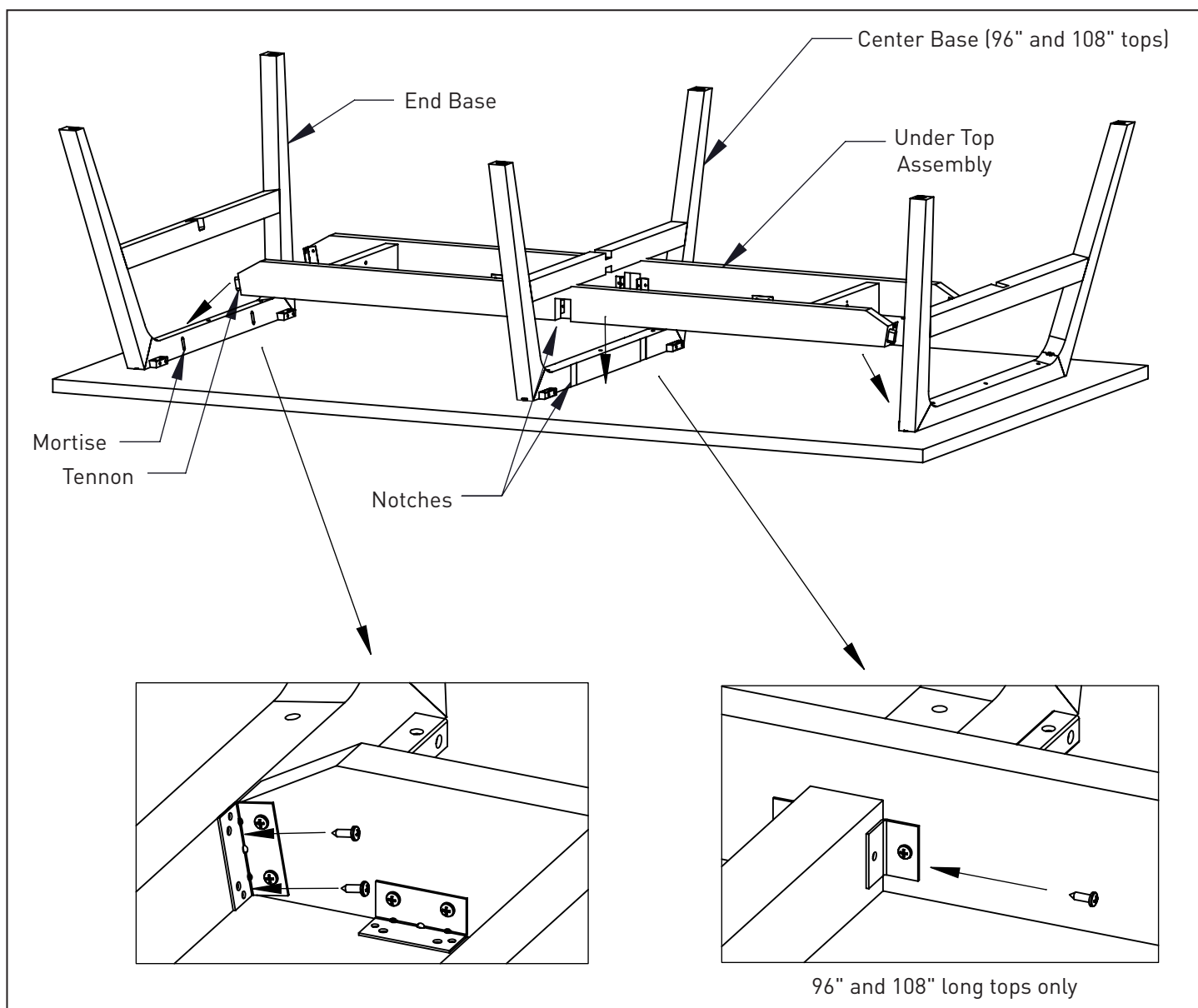

Riff-Nic, Bar Height and Tennis Table Assembly Instructions

STEP 2

1. Fit Cross Rail Angled Tennons into Mortise on bottom of Base Rail.
2. Straight Tennons fit on top and bottom of Center Base Rail (96" and 108" long tops only).
3. Secure Angled Tennons with #8 x 1 1/2" Pan Head Screws (HK-103).
4. Secure Straight Tennons with (2) #8 x 2" Pan Head Screws (HK-102).

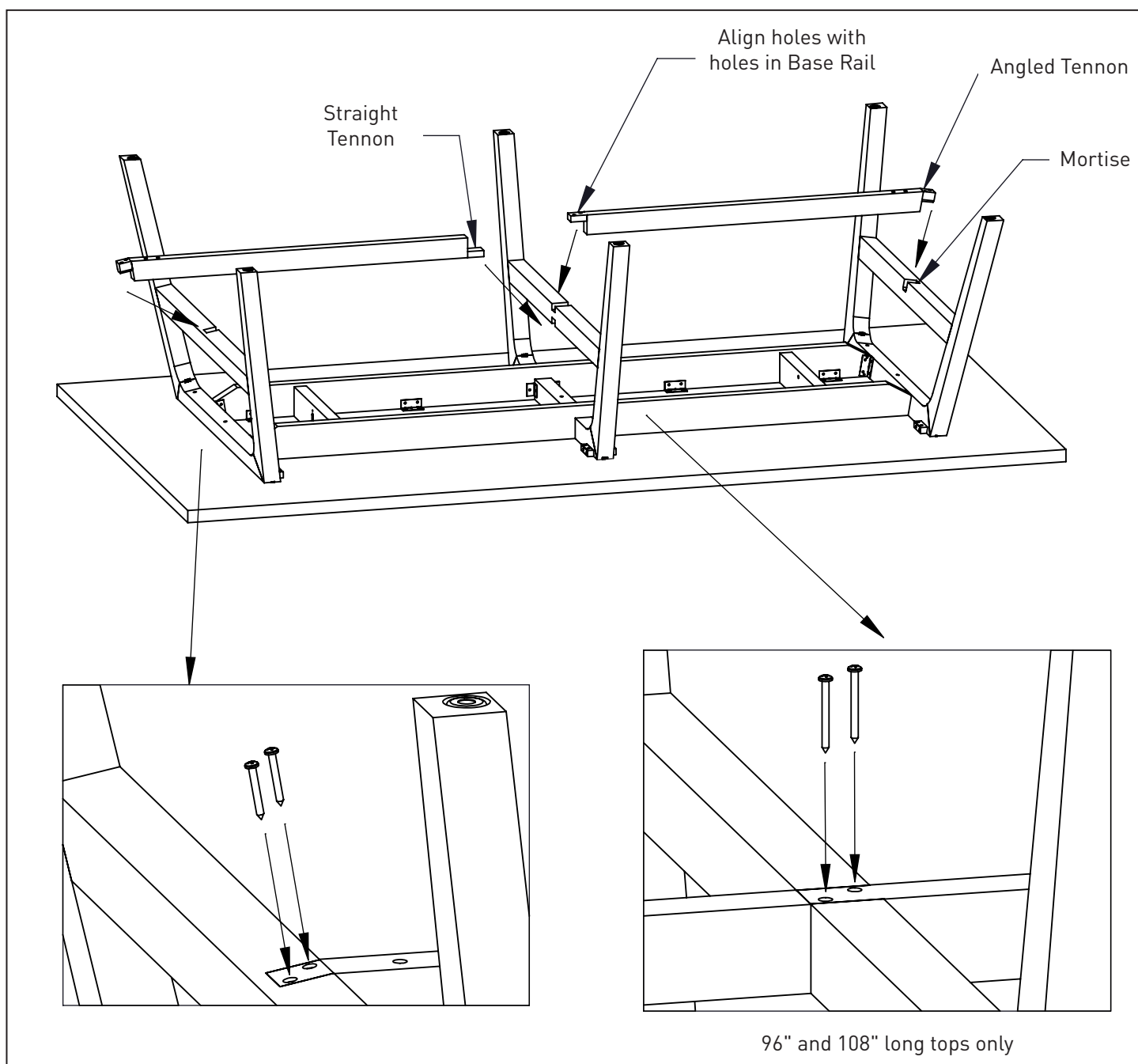

Riff-Nic, Bar Height and Tennis Table Assembly Instructions

STEP 3

1. Install Braces by inserting Tennon into Mortise.
2. Bottom edge of Brace should rest flush on Cross Rail.

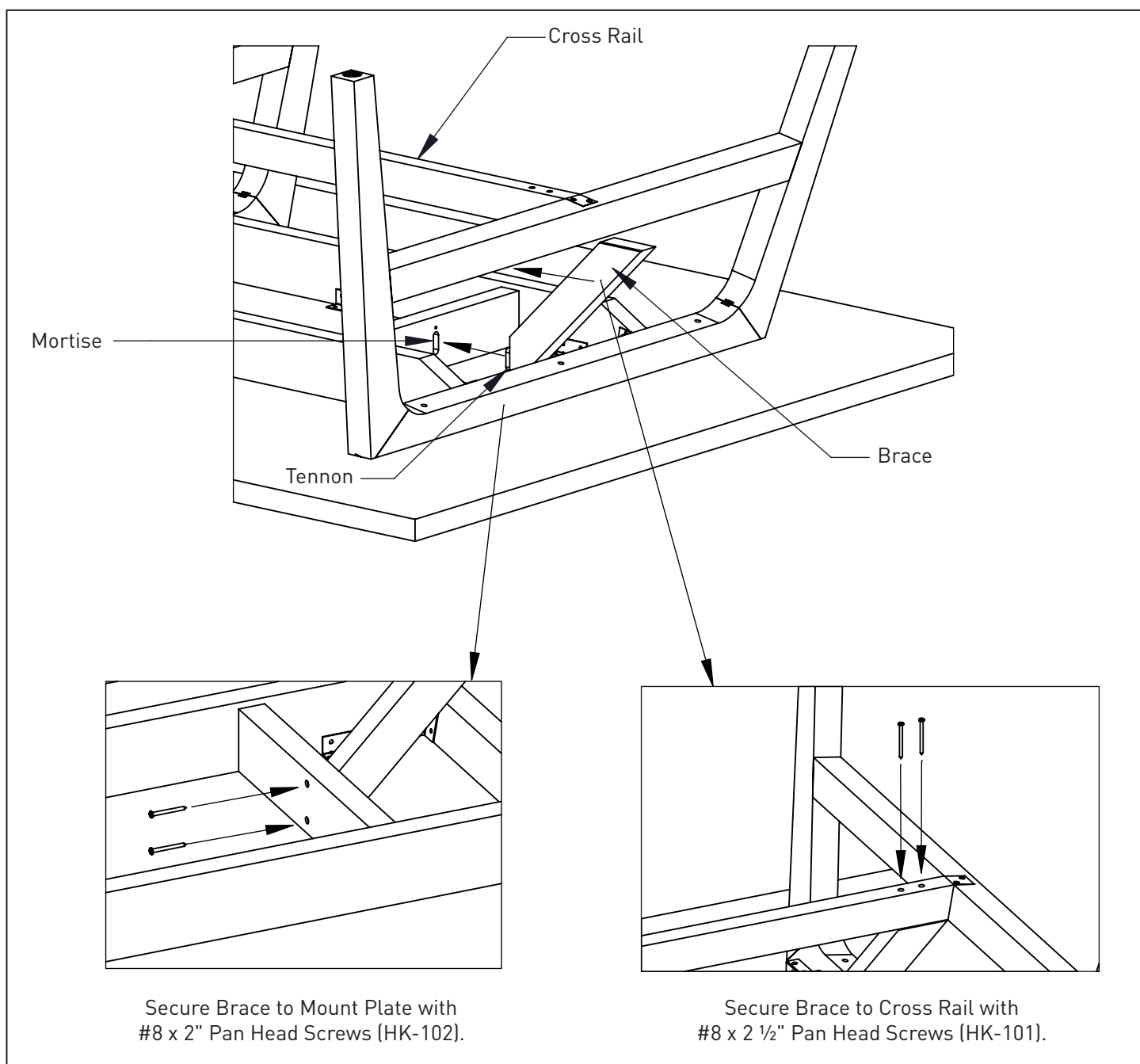

Riff-Nic, Bar Height and Tennis Table Assembly Instructions

STEP 4

1. Turn Base over and place in desired location.
2. Make Base level by adjusting Levelers.
3. Place Worksurface on Base and position so it is centered both directions.

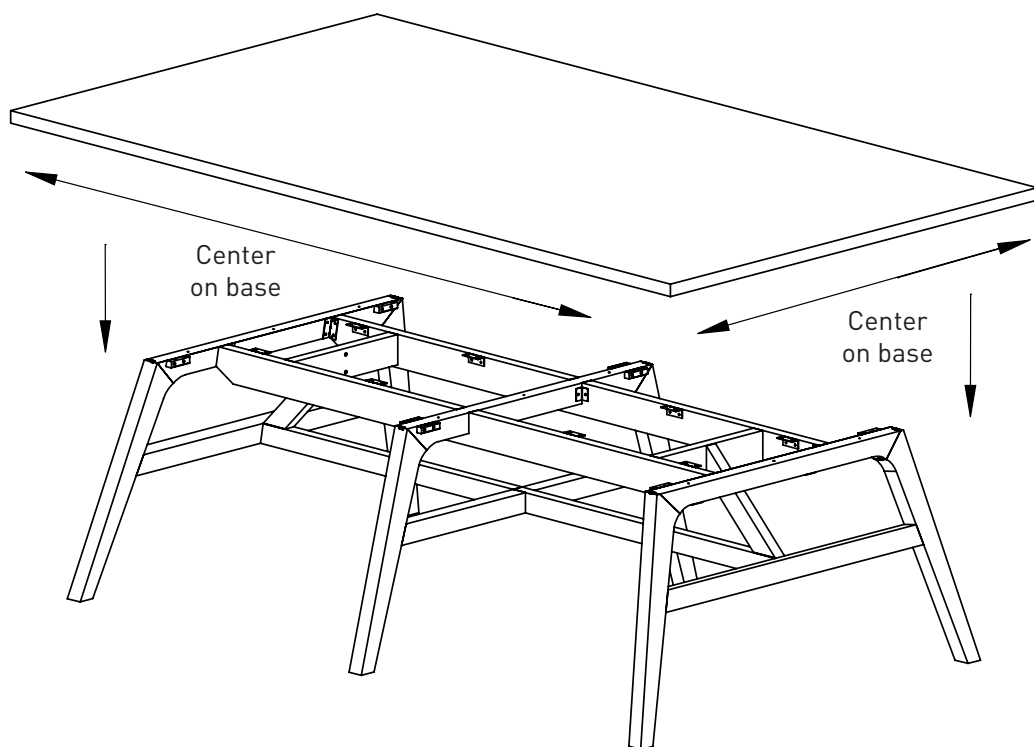

4. Secure Worksurface to Base by screwing #8 x $\frac{5}{8}$ " Pan Head Screws (HK-105) through the L-Brackets.
5. Use #8 x $1\frac{1}{4}$ " Pan Head Screws (HK-104) to secure Cleats to Worksurface.
6. Use #8 x $2\frac{1}{2}$ " Pan Head Screws (HK-101) to secure Bases to Worksurface.

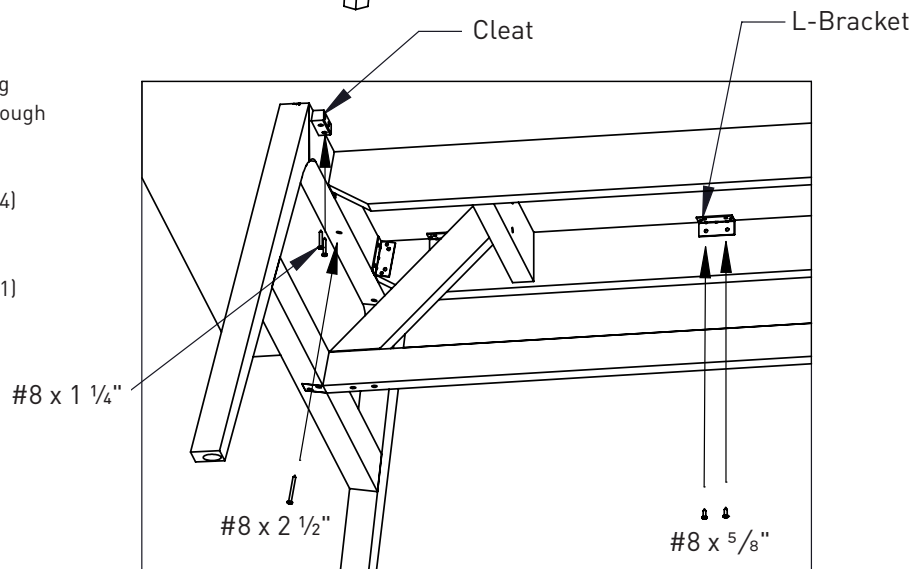

Riff Tables

RIFF-NIC, BAR HEIGHT AND TENNIS TABLE ASSEMBLY INSTRUCTIONS

