

OVERVIEW - MODULAR CASEGOODS

An extensive offering of modular components allows specifiers to create customized, private offices that address technology and collaborative work styles. Workwall and component height options combine to allow single-tier or multi-tiered office landscapes.

1 DESKS & WORKTABLES

A broad offering of desks and worktables address many applications including height adjustment and in-office meetings.

2 CONSOLES

Combine with a Desk in U-shape back or L-shape side workwall layouts. Offers work-in-process organization and a multi-tiered landscape.

3 CREDENZAS

Feature the overlay drawer style and are offered in both freestanding and workwall versions.

4 ACCESS KNEESPACE SUPPORT

Provide ample space and hinged doors allowing easy access to building power and data sources while concealing wires.

5 PEDESTALS & FILES

Designed to fit within a workwall and available in flush drawer with integrated center or top pull.

6 CABINETS

These units feature an integrated top pull and interior options including filing, technology and waste bin storage.

7 MODULAR CABINET TOPS

Offered in 6" incremental lengths, these worksurfaces are specified atop modular Pedestals, Files and Access Kneespace Panels.

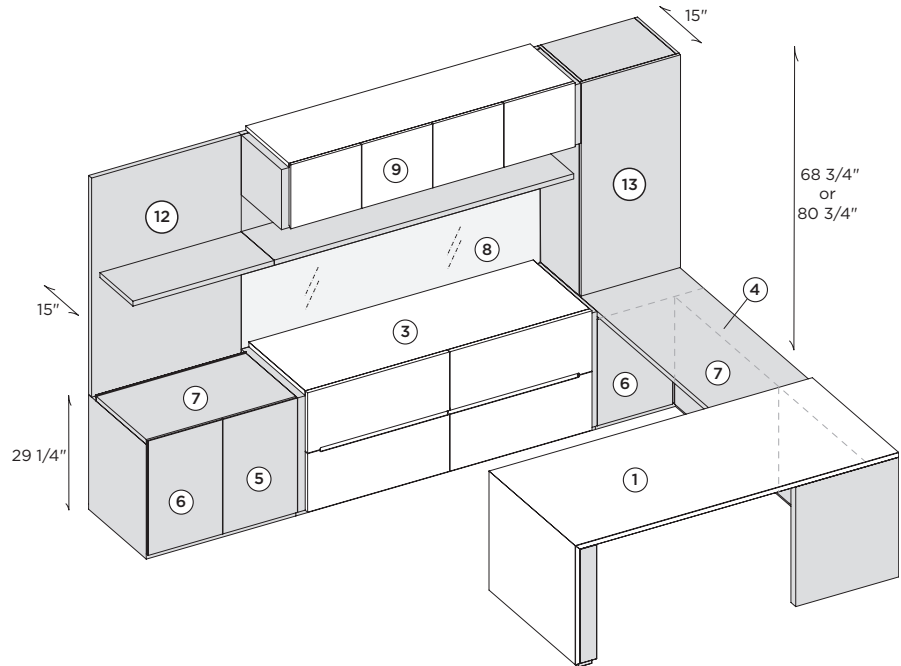

DESIGN & FINISH OPTIONS

- VENEER
- PAINT
- GLASS
- TEXTILE

Design Tip: To enhance the Slate aesthetic, specify Overlay Organizers above Overlay Credenzas and match the overlay finish - paint or veneer.

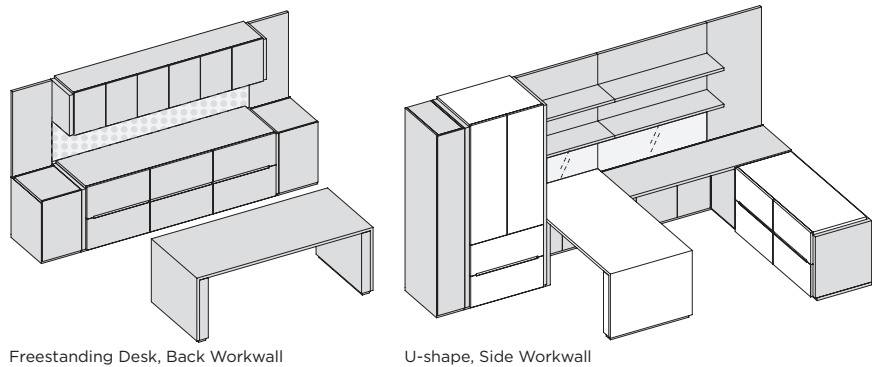

Design Tip: When specifying Workwall Tops, select the edge option to fit with both your workwall components and configuration – full, inset back or inset end.

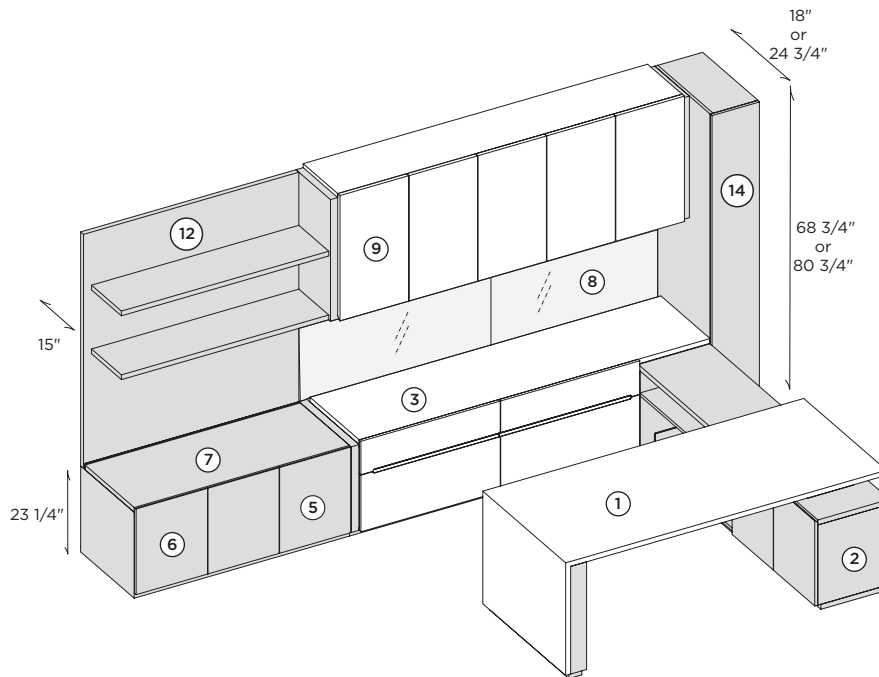

- 8 WALL PANELS**
Can be specified between Workwall Tops and Organizers and include veneer, tackable textile and magnetic glass material options.
- 9 WALLMOUNT ORGANIZERS**
Overhead storage units are offered in three heights and two door styles – overlay and flush.
- 10 WALLMOUNT OPEN SHELF ORGANIZER (NOT SHOWN)**
Overhead shelves provide a floating aesthetic and are offered in three heights to align with Organizer heights.
- 11 WALLMOUNT PANEL, PARTIAL & FULL (NOT SHOWN)**
Use these wall mounted panels at the end of a Workwall and next to Organizers or Shelves.
- 12 WALLMOUNT PANEL, WITH SHELF**
Use these wall mounted Shelves at the end of a Workwall and next to Organizers.
- 13 WORKSURFACE CABINETS**
Can be placed atop a standard height unit only and next to wall mounted Organizers or Shelves.
- 14 FREESTANDING STORAGE**
Available in two heights and depths, these units offer wardrobe, storage and server interior options.

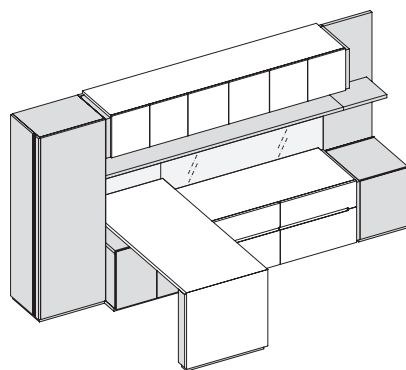

L-shape, Side Workwall

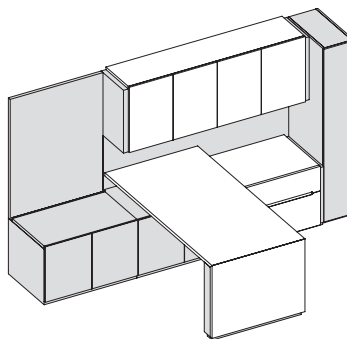

L-shape, Side Workwall

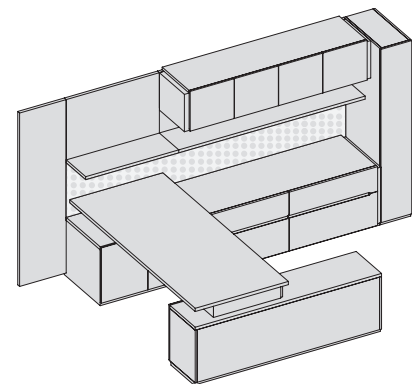

L-shape, Side Workwall w/ Console

PLANNING - MODULAR WORKWALLS AND COMPONENTS

Slate Modular Caseworks features desks, credenzas, wallmount organizers and storage designed to address a variety of work styles and spaces. Designing and specifying a Slate workstation can be easy when you follow the information provided below.

CONFIGURATIONS

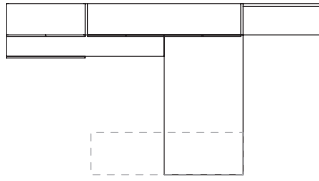

L-shape, Side Workwall

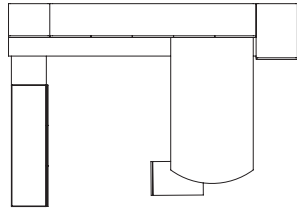

U-shape, Side Workwall

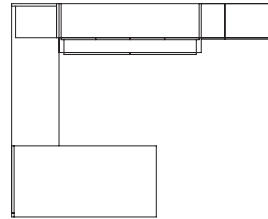

U-shape, Back Workwall

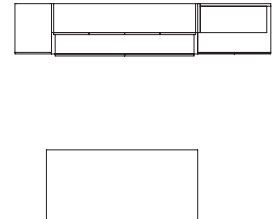

Freestanding Desk, Back Workwall

WORKWALL HEIGHTS

Slate modular caseworks are available in two workwall heights (68.75" & 80.75"), with three Lower Storage, Back Panel and Overhead combinations for each height. The workwall sections shown right illustrate dimensional information for each of the six workwall height combinations offered.

The six combinations offered are comprised of Lower Storage, Back Panels and Overhead Organizers and Shelves and labeled as A, B, C, D, E, & F throughout this section.

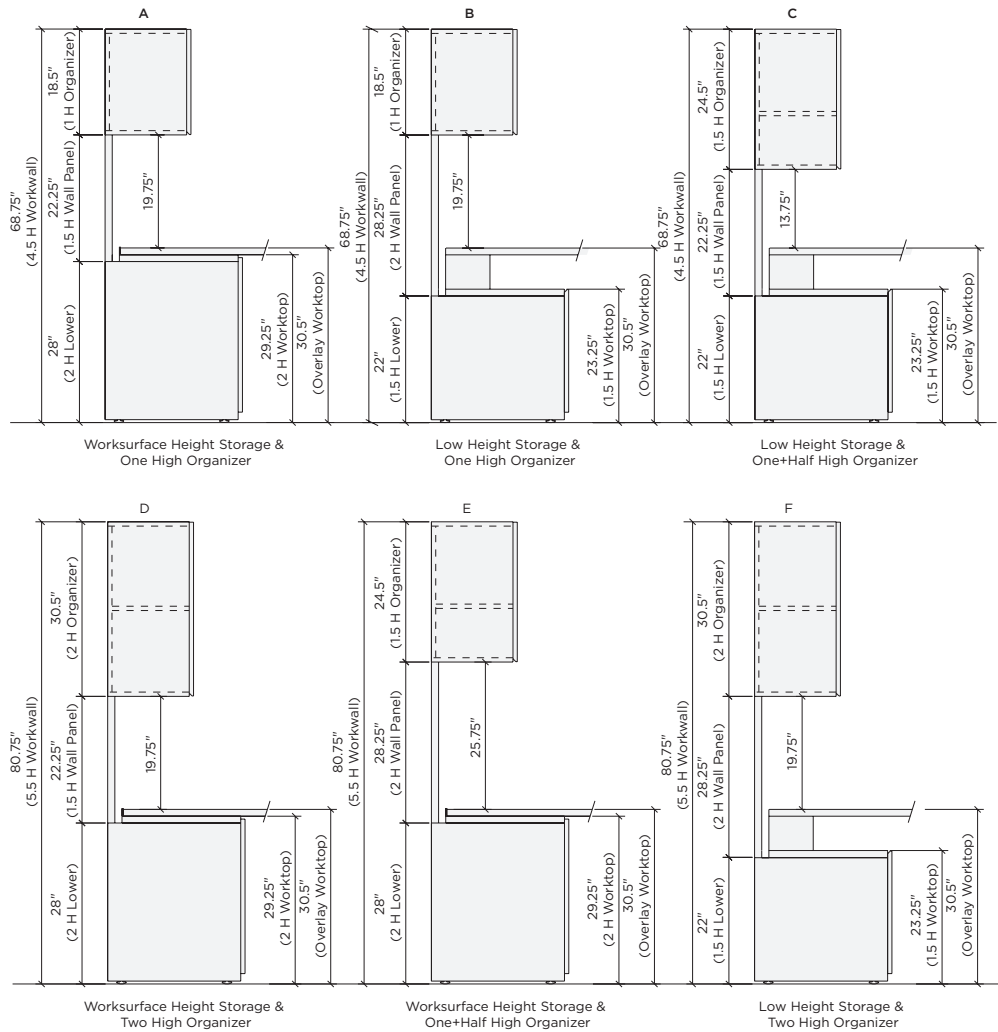

WORKWALL HEIGHTS

Follow the numerical logic shown in the diagrams on right to easily plan your Slate workwall components and heights. Numerical increments ranging from 1.5 to 5.5 have been assigned to each workwall component along with two overall heights - 4.5 and 5.5. The total of the numerical increments for each component in the workwall should always equal the overall height of the wall (4.5 or 5.5).

WORKWALL COMPONENTS:

The six workwall combinations (A, B, C, D, E, & F) are comprised of the following primary components: 1) Lower Storage - includes Credenzas and Return Components in worksurface height and low height and Access Kneespace Panels in worksurface height only. 2) Wall Panels - fill the space between Modular Cabinet Tops and Wallmount Organizers. 3) Wallmount Organizers and Shelves - offered in three heights.

WORKWALL ENDER OPTIONS:

Wall Panels, Full Height and Freestanding Storage units can be added to the end of the six workwall combinations. The diagrams shown right illustrate these optional heights and pairings.

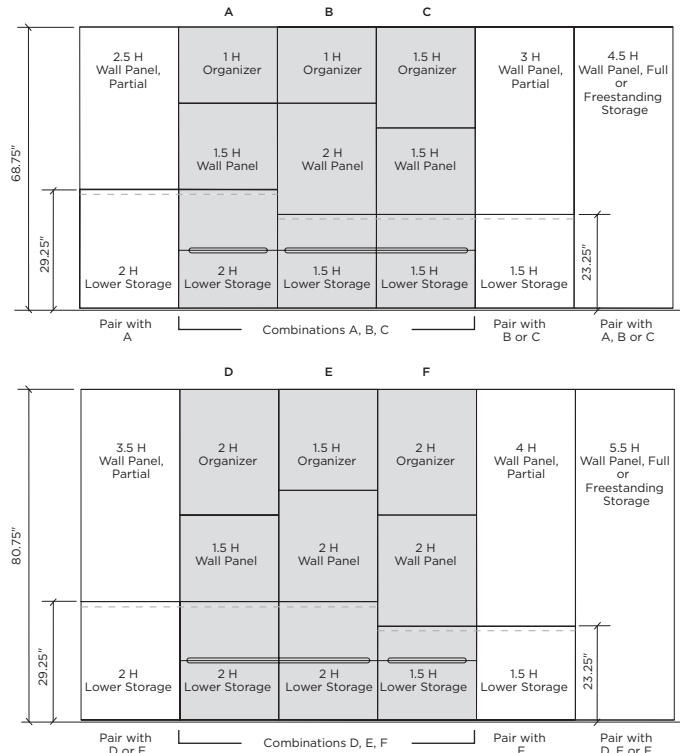

WORKWALL EXAMPLES:

Workwall examples at right illustrate the numerical logic that can be used to easily plan your workwall heights and component combinations.

WORKWALL DESIGN STEPS:

- 1) Select the overall workwall height - 68.75" (4.5 H) or 80.75" (5.5 H).
- 2) Choose the height and style of Credenza and/or Return Components - 1.5 H (low) or 2 H (worksurface).
- 3) Choose the style and height (1, 1.5, 2 H) of the overhead Organizer.
- 4) Select the height of the back panel that equals the difference between the overall workwall height and the total combined height of the Lower Storage and Wallmount Organizer selected.
- 5) Select the height of the Wallmount Panel (partial or full) or Freestanding Storage that aligns with the overall workwall height.

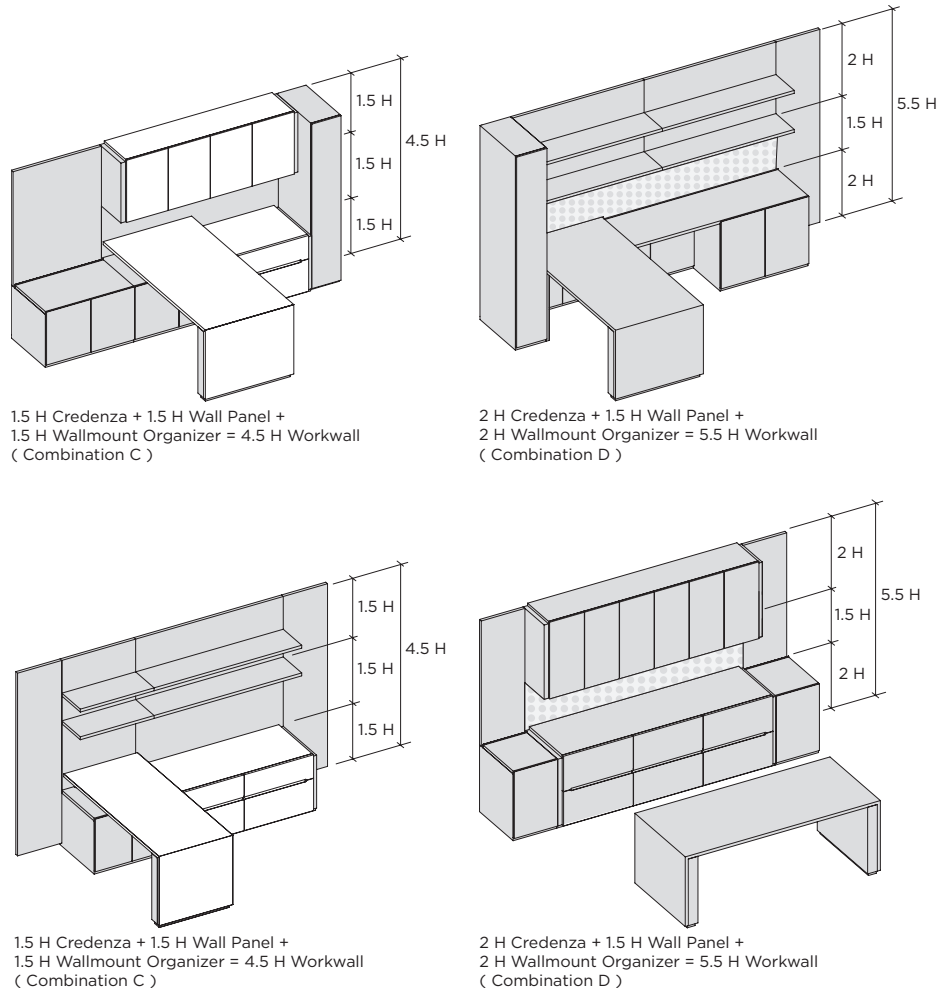

PLANNING - CREDENZA & RETURN COMPONENTS

Slate's creative offering of modular Credenza and Return Components support a multitude of design possibilities along with aesthetic and functional options.

APPLICATION

- ① MODULAR CABINET TOP
- ② ACCESS KNEESPACE SUPPORT
- ③ WORKWALL OVERLAY CREDENZA
- ④ PEDESTAL
- ⑤ LATERAL FILE
- ⑥ CABINET
- ⑦ CORNER DOCK PEDESTAL AND CABINET
- ⑧ CORNER TAKE-OFF PEDESTAL
- ⑨ CORNER CABINET
- ⑩ LOW CONSOLE

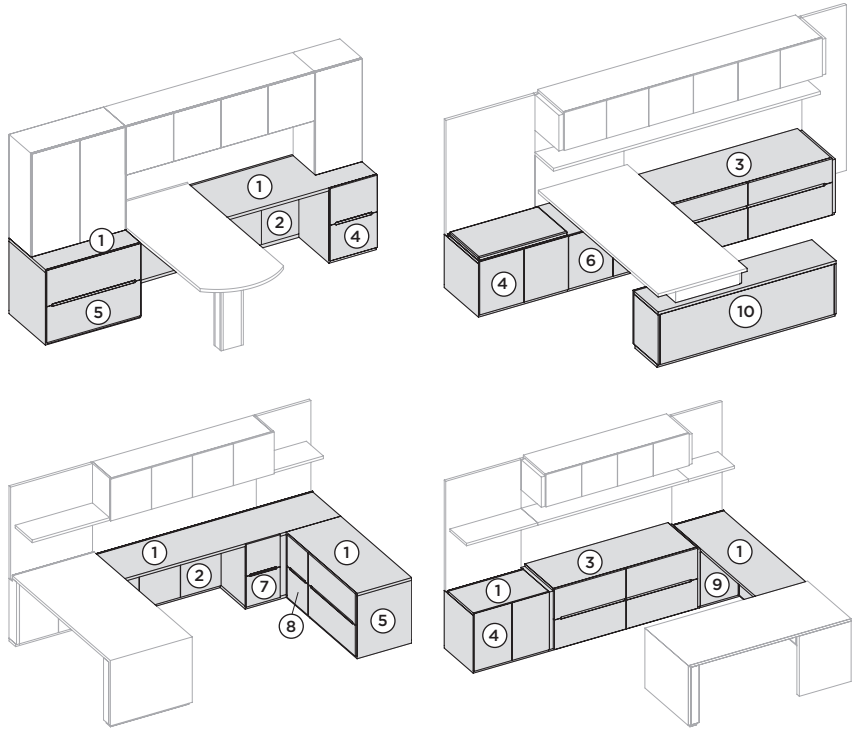

OVERLAY CREDENZA APPLICATION

Overlay Credenzas feature an expressed, overlay detail and an integrated center pull. Available in two heights – worksurface and low. Credenzas can be used alone or together with Full Drawer Pedestals which enhance the overlay aesthetic while adding functional options. See Drawer (Style 3) options below.

OVERLAY CREDENZA PLANNING

Overlay Credenzas are offered in two distinct versions – workwall and freestanding. Always specify the Workwall Overlay Credenza when these units are combined with Wall Panels and Organizers in workwall. For applications without Wall Panels, specify the Overlay Credenza.

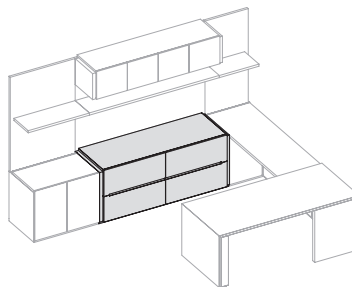

Workwall Overlay Credenza - Worksurface Height

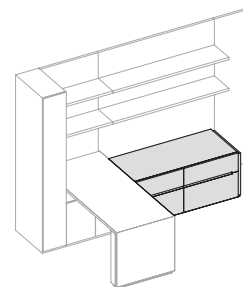

Workwall Overlay Credenza - Low Height

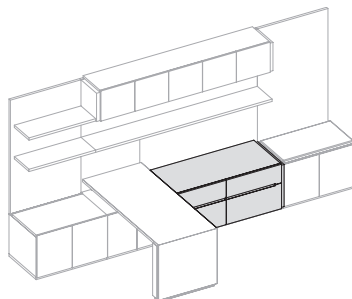

Workwall Overlay Credenza

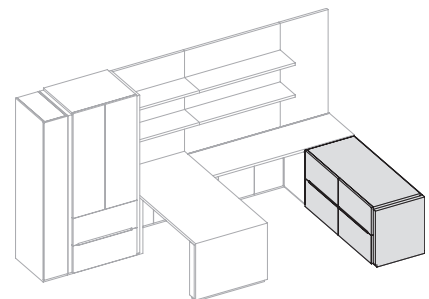

Overlay Credenza

RETURN COMPONENTS APPLICATION

Return Components include Modular Cabinet Tops, Access Kneespace Supports, Pedestals, Files and Cabinets. These components feature flat ends and plan in 6" incremental lengths.

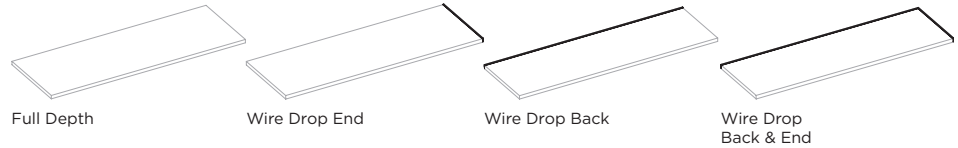

MODULAR CABINET TOPS

Modular Cabinet Tops sit atop Access Kneespace Supports, Pedestals, Files and Cabinets. Offered in worksurface height only and full depth or three wire drop options – back edge, end edge or back and end edges. Specify the Cabinet Top that fits the component and configuration as shown in the examples right.

- ① Full Depth
- ② Wire Drop - Back
- ③ Wire Drop - End
- ④ Wire Drop - Back & End

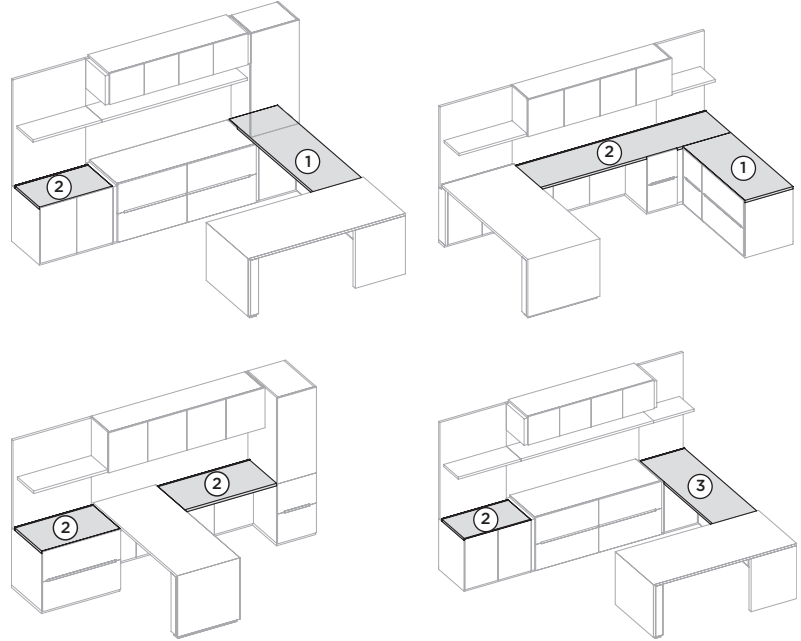

ACCESS KNEESPACE SUPPORT

Access Kneespace Supports provide wire management space, pass-thru ports and hinged doors for easy access to building power sources. Offered in worksurface height only, these units support a variety of configurations as shown right.

Design Tip: Specify the Corner Cabinet with pull-out technology or waste bin storage to utilize corner space in U-shape side and back workwalls.

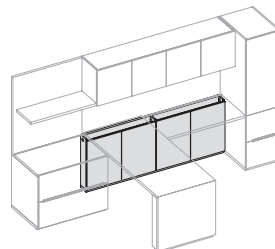

Access Kneespace Panels

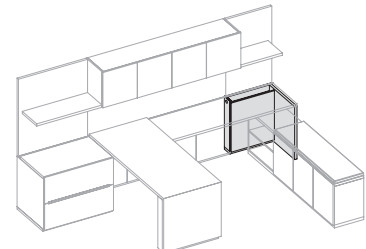

Access Kneespace w/ End Panel

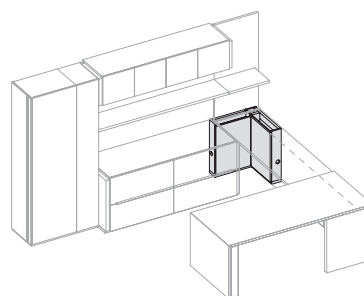

Access Kneespace Corner

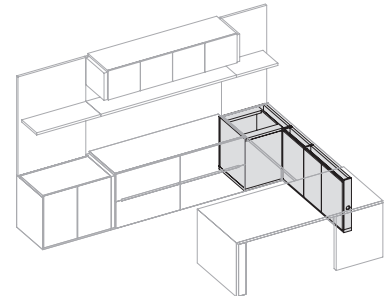

Access Kneespace Corner Cabinet

PEDESTALS, FILES AND CABINETS

These units fit below Modular Cabinet Tops and are offered in 18, 30 & 36 inch widths in both worksurface and low heights. Worksurface height units can be placed next to Access Kneespace Supports to create kneespace areas within the workwall.

These units offer both aesthetic and functional options as outlined in the Drawer Style and Pedestal Options section below.

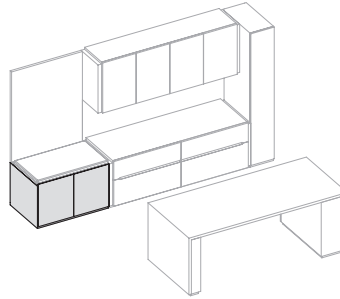

Pedestal and/or Cabinet, Low Height

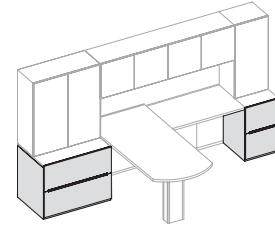

Lateral File and Pedestal, Worksurface Height

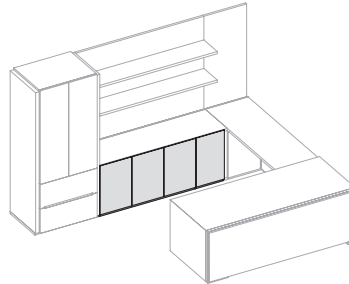

Pedestal and/or Cabinet, Worksurface Height

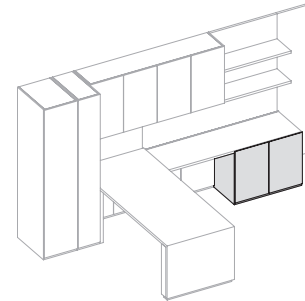

Pedestal and/or Cabinet, Worksurface Height

CORNER APPLICATIONS

An offering of docking units provide solutions for Credenzas, Return Components and Low Consoles placed 90 degrees to each other in corners.

LOW HEIGHT OVERLAY CORNER DOCK

Use this unit to connect Low Consoles to a U-shape back or side workwall as shown in the examples right.

CORNER DOCK PEDESTAL

Offered in worksurface and low heights, this unit connects to Overlay Credenzas or Corner Take-off Pedestals in a corner as shown right.

CORNER TAKE-OFF PEDESTAL

Always specify a Corner Take-off Pedestal next to the Corner Dock when specifying Flush Drawers that converge in a corner as shown right. Offered in both worksurface and low height.

- ① Corner Dock Pedestal
- ② Corner Take-off Pedestal
- ③ File
- ④ Overlay Credenza

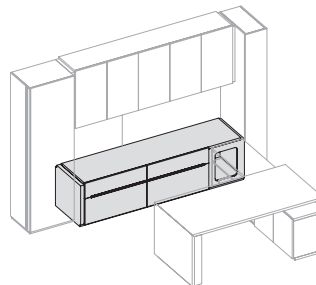

Overlay Corner Dock Credenza

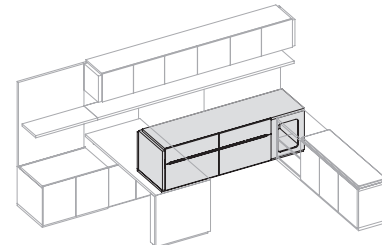

Overlay Corner Dock Credenza

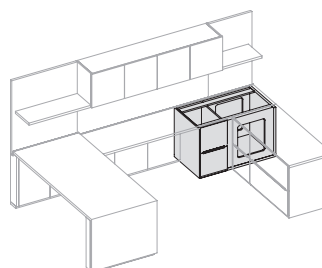

Corner Dock Pedestal

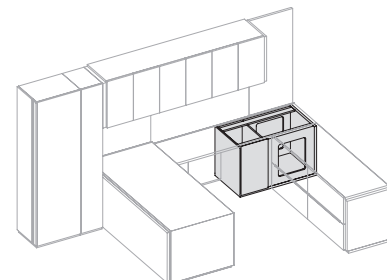

Corner Dock Pedestal

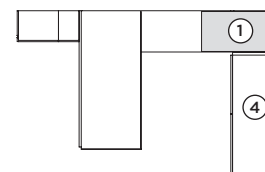
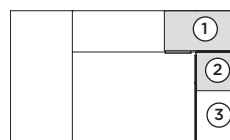

DRAWER STYLE & PULL OPTIONS

Slate offers four distinctive Drawer Styles providing both aesthetic and functional options.

The Drawer Styles illustrated right are separate styles and should not be used together in the same workstation with the exception of Drawer Style 4 which combines styles 1 and 3 to enhance the overlay aesthetic. See Typical Workstations for design examples.

- ① Overlay Drawer (Style 1) is offered on worksurface and low height Credenzas, features lateral file drawer and hinged cabinet options.
- ② Flush Drawer (Style 2) is offered on modular pedestals and files in both worksurface and low heights.
- ③ Full Drawer (Style 3) offers a minimalist aesthetic with drawers concealed behind the cabinet face. These cabinets are also available with technology and waste bin storage options.
- ④ Overlay Drawer with Full Drawer (Style 4) combines Styles 1 and 3 to enhance the overlay aesthetic and integrates functional options.

Design Tip: Always match overhead Organizer style with Drawer style as shown in the examples right - Overlay Organizer with Overlay Credenza or Flush Organizer with Flush Drawer.

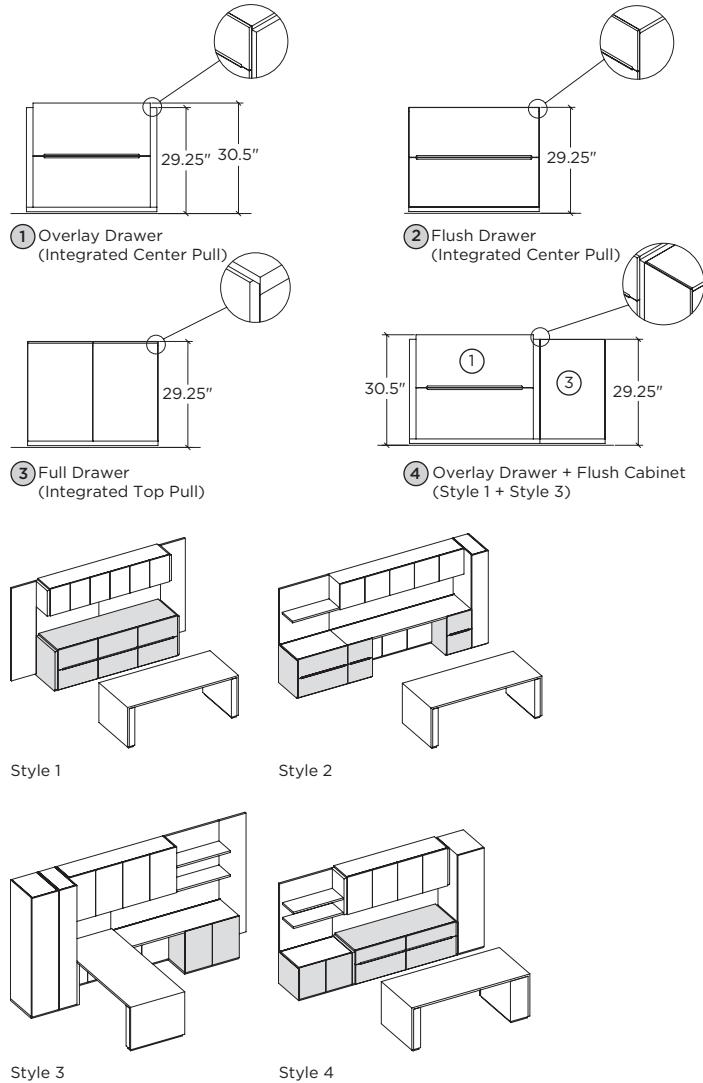

PEDESTAL OPTIONS

The Flush Drawer (Style 2) is offered in a box/box/file or file/file drawer configuration. The Full Drawer (Style 3) is offered with the following options: box/box/file, technology tray/box/file, tech pullout or waste bin pullout as shown right.

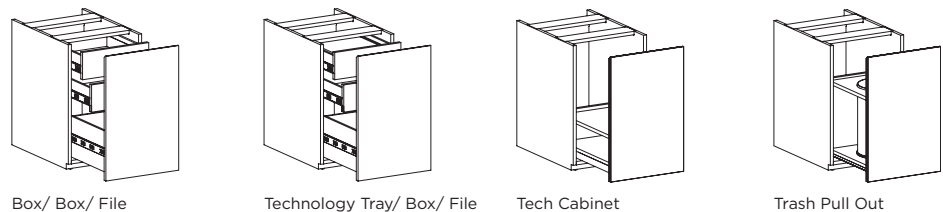

FILE CAPACITY

All OFS filing configurations meet standard file tab clearance of 1.25" above the file frame as recommended by our file frame suppliers.

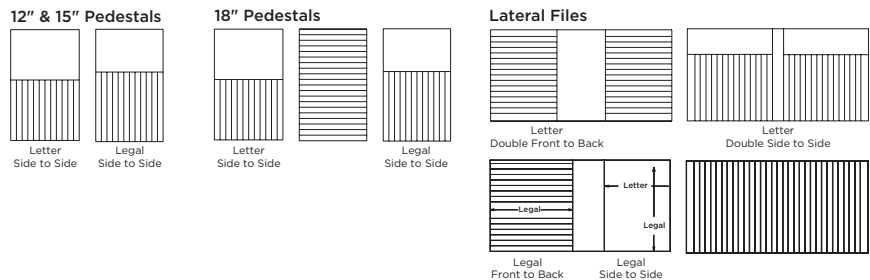

PLANNING - WALLMOUNT ORGANIZERS, PANELS & WORKSURFACE CABINETS

Slate's offering of Organizer, Wall Panel and Worksurface Storage expresses modern, architectural aesthetics and supports tailored workwall solutions.

WALLMOUNT ORGANIZERS AND PANELS APPLICATION

- ① WALL PANELS
- ② WALLMOUNT ORGANIZERS
- ③ WALLMOUNT OPEN SHELF ORGANIZER
- ④ WALLMOUNT PANEL, PARTIAL
- ⑤ WALLMOUNT PANEL, FULL
- ⑥ WALLMOUNT PANEL, WITH SHELF
- ⑦ WORKSURFACE CABINETS

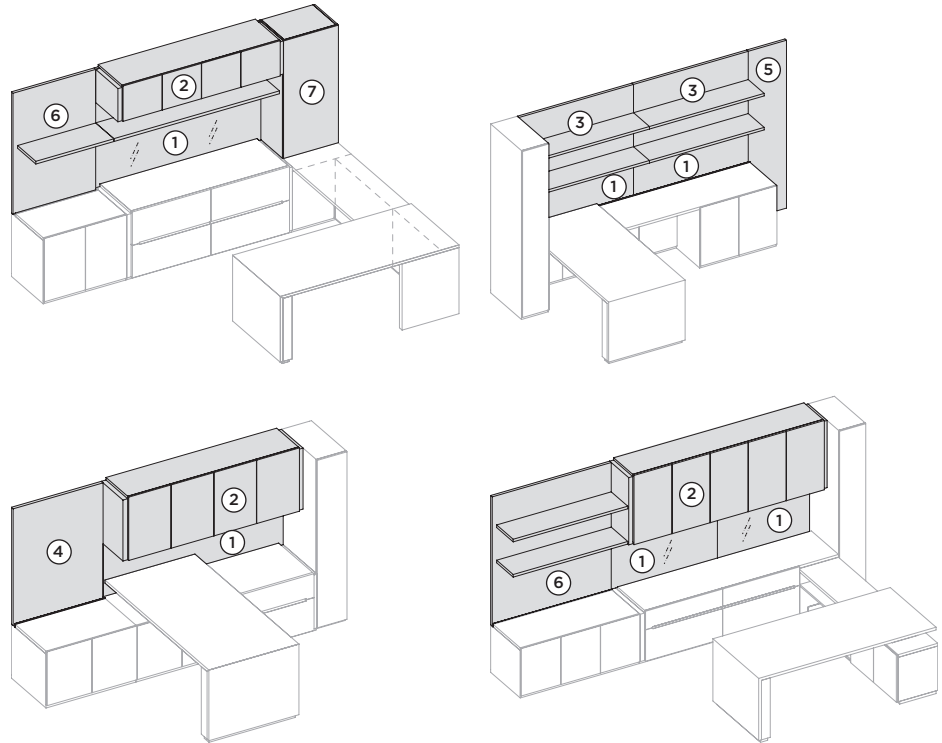

ORGANIZER PLANNING

These wall mounted units plan on 6" increments and feature flat ends. Available in three heights (1, 1.5, & 2) and one depth (binder), along with a selection of door styles and material options.

Design Tip: Combine the Overlay style cabinet and floating shelf with Wall Panels and floating shelf to create a minimalist workwall aesthetic.

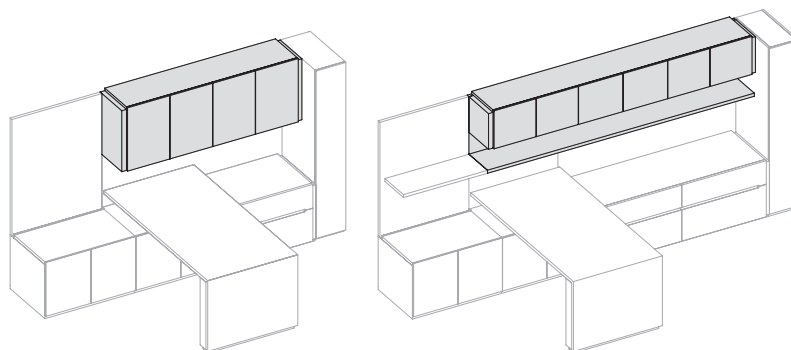

ORGANIZER FEATURES & OPTIONS

Organizers are offered in two door styles – Overlay and Flush.

Overlay style units are offered in a full cabinet or a cabinet with floating shelf. The Overlay style can be specified with painted doors and a veneer chassis or all veneer.

The Flush style door is available in paint, veneer or back painted glass with a veneer chassis.

Design Tip: When specifying Open Shelf and Hinged Door Organizers together in a workwall, always specify the same height (1, 1.5 or 2) to align cabinets and shelves vertically.

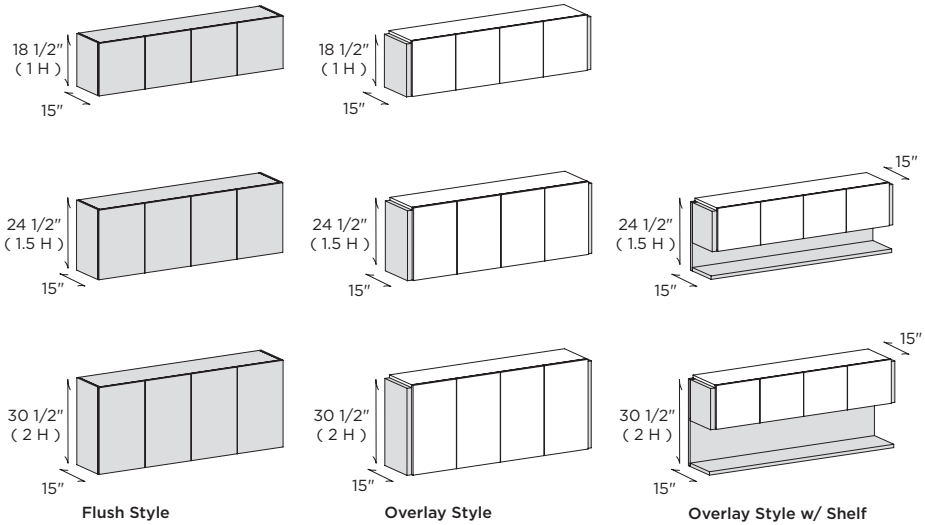

ORGANIZER SHELF PLANNING

Open Shelf Organizers are available in veneer and are offered in three heights (1, 1.5, & 2) and one depth (binder).

Use separately or together with any style of hinged door Organizer of the same height (1, 1.5 or 2). For configuration examples, see Organizer Applications on page 799.

Design Tip: To create a minimalist aesthetic, specify any Wallmount Wall Panel next to Open Shelf Organizers at the end of the workwall.

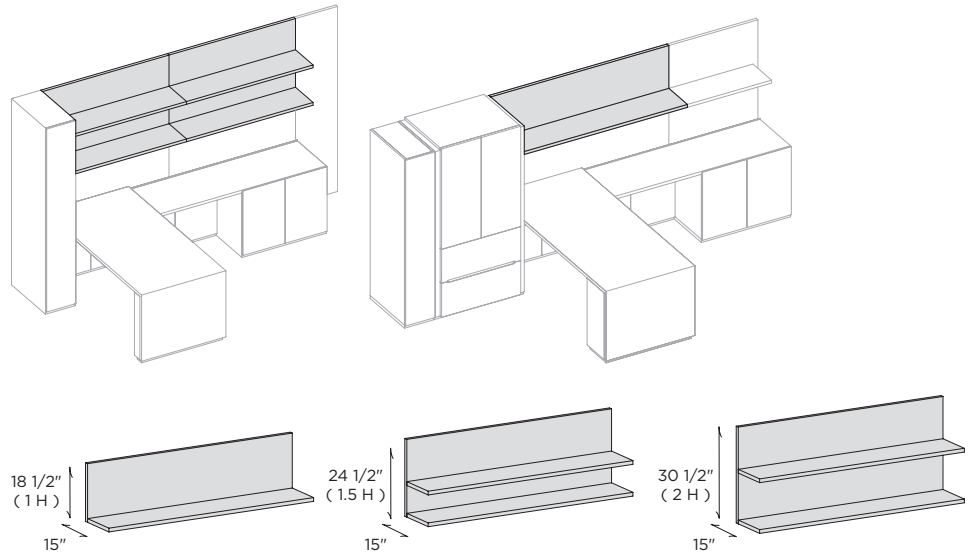

TASK LIGHT OPTION

A recessed LED task light with an integrated switch is available on the underside of both hinged door and open shelf Wallmount Organizer units.

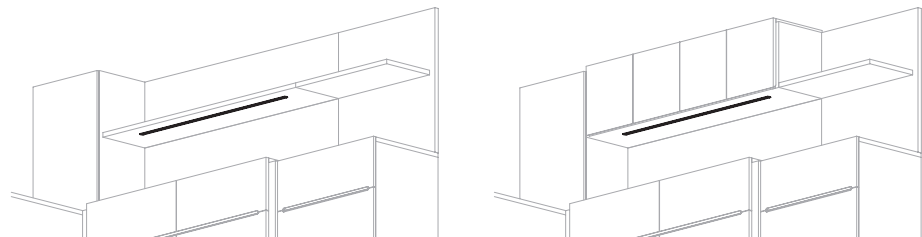

WALL PANEL PLANNING

Wall Panels fill the space between Wallmount Organizer units and lower storage with Modular Cabinet Tops. Wallmount Panels are offered in two heights to fit with the various component and workwall height combinations and illustrated in the Workwall Height Planning section (see page 792). Available in 6" incremental lengths, the total length of the Wall Panels should always match the total length of Wallmount Organizers.

WALL PANEL MATERIAL OPTIONS

Wall Panels are available in three material options - veneer, magnetic backpainted glass or tackable textile. The magnetic glass panels can be specified in either a writeable gloss finish or a non-writeable, satin finish.

Design Tip: For a magnetic and writeable glass surface always specify the gloss white finish. Satin etch glass is magnetic but not writeable.

NOTE: When planning a Slate Wall System, please ensure the walls are flat across the face. If there is movement in the walls, the panels/shelves will not line up properly.

Finish Key

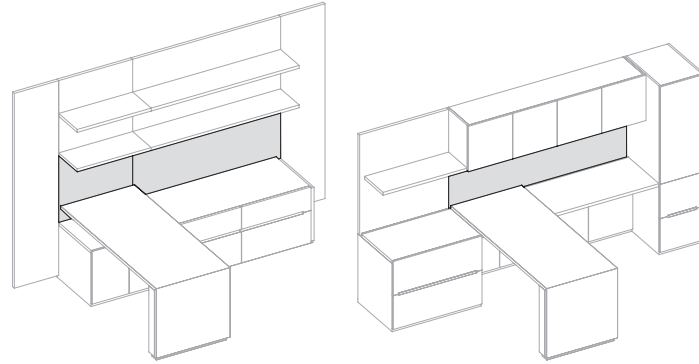
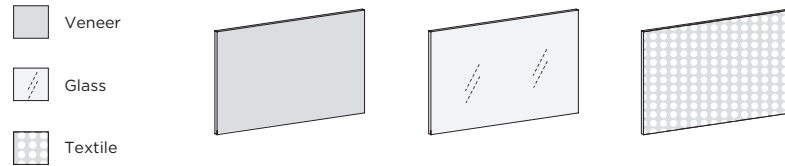

WALLMOUNT PANELS W/SHELF (FULL & PARTIAL) PLANNING

Wall Panels with shelves fit at the end of a workwall only and can be placed next to hinged door or open shelf Organizers with Wall Panels below.

Specify with a single shelf only or with the addition of an intermediate shelf. The single shelf aligns with the lower shelf or cabinet bottom and the intermediate shelf aligns with the upper shelf of Organizers and Wall Panels with shelves. Choose from three shelf heights (1, 1.5 or 2 H) and always specify the numerical shelf height which matches the Organizer numerical height to align shelves vertically.

Wall Panels with shelves are offered in four heights to fit with the various component and workwall height combinations and are illustrated in the Workwall Height Planning section (see page 792).

Design Tip: Combine the Overlay style cabinet and floating shelf with Wall Panels and floating shelf to create a minimalist workwall aesthetic.

NOTE: When planning a Slate Wall System, please ensure the walls are flat across the face. If there is movement in the walls, the panels/shelves will not line up properly.

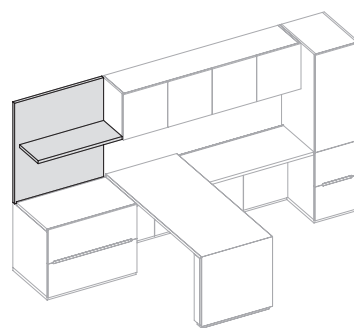

Wall Panel, Partial w/ Single Shelf

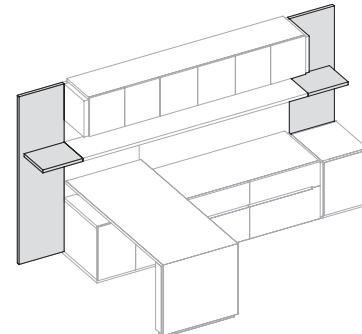

Wall Panel, Full & Partial w/ Single Shelf

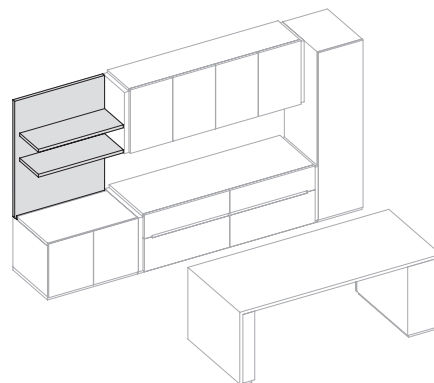

Wall Panel, Partial w/ Single & Intermediate Shelf

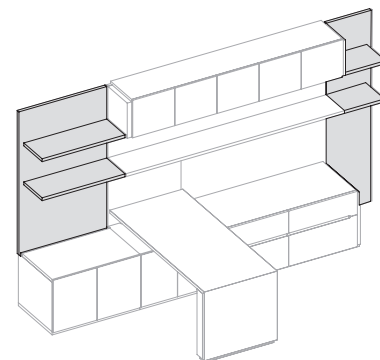

Wall Panel, Partial & Full w/ Single and Intermediate Shelf

WALLMOUNT PANELS (FULL & PARTIAL) PLANNING

Wall Panels (partial height) fit at the end or center of a workwall and Wall Panels (full height) only fit at the end of a workwall. Both partial and full height Wall Panels can be placed next to hinged door or open shelf Organizers with Wall Panels below.

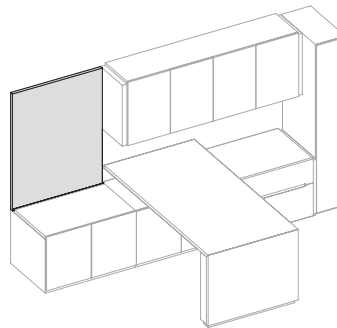

Wall Panel, Partial Height

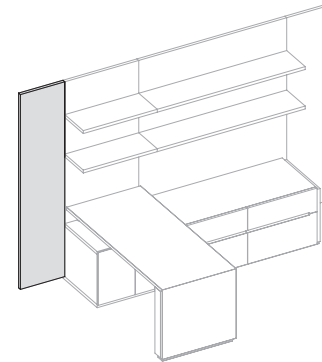

Wall Panel, Full Height

WORKSURFACE CABINET PLANNING

These units fit atop standard height Modular Cabinet Tops only and can be placed anywhere along the workwall providing extra storage above the worksurface.

Offered in three widths (18, 24, 36 inches) and two depths (letter and legal), these units pair well both hinged door and open shelf Organizers in all of the configurations.

Design Tip: Place 24"W Worksurface Storage units atop Return Components in U-shape Back and Side Workwalls to maintain vertical alignment of Overlay Credenzas with Overlay Organizers with hinged doors.

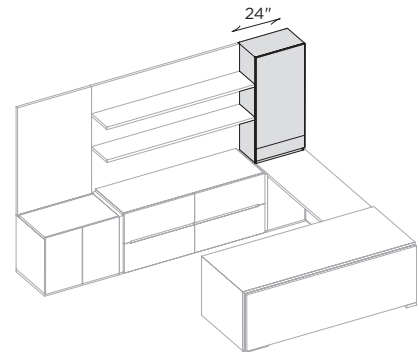
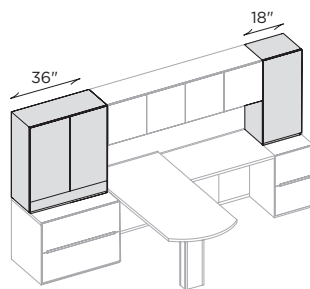
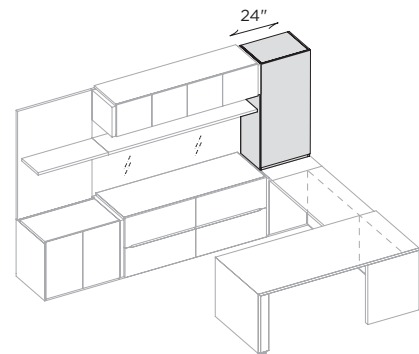
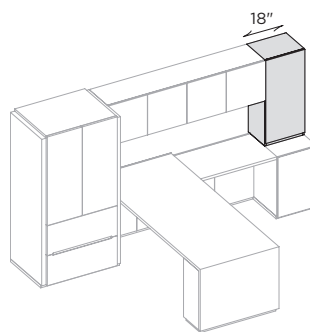

WORKSURFACE CABINET FEATURES

Worksurface Cabinets are available in two styles - Storage and Wardrobe.

Storage Cabinets feature adjustable shelves to maximize vertical space above the worksurface.

Wardrobe Cabinet interiors feature a hook (18"W) or rod (36"W) along with a mirror and drawer for personal items.

Design Tip: When specifying next to a hinged door Organizer, match Worksurface Storage Cabinet depth with Organizer depth.

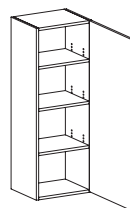

Single Door Storage Cabinet

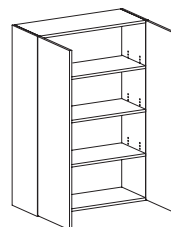

Double Door Storage Cabinet

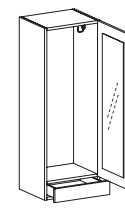

Single Door Wardrobe Cabinet

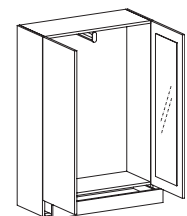

Double Door Wardrobe Cabinet

PLANNING - DESKS AND WORKTABLES

Slate's offering of Desks and Worktables address a variety of applications including in-office meetings, technology and height adjustment.

DESK APPLICATION

Desks feature a variety of table desk solutions and combine with Slate workwalls in many configurations.

FREESTANDING DESK

Slate's offering of freestanding desks include table, double pedestal, single pedestal and height adjustable options. These desks pair well with back workwalls in large or small office settings.

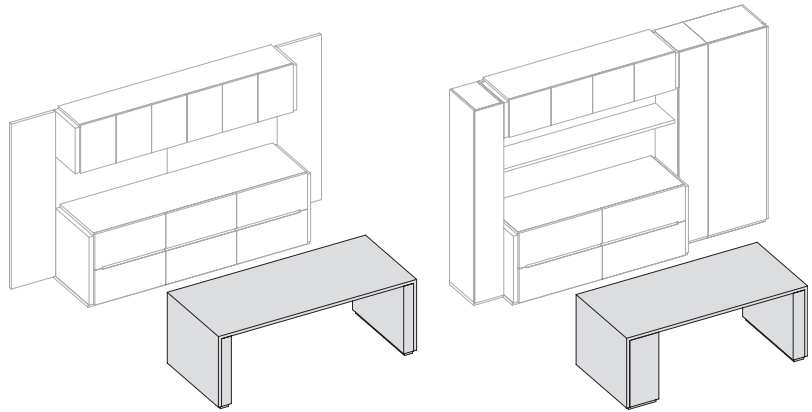
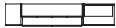

Overlay Table Desk

Overlay Single Pedestal Desk

RUN-OFF DESK

Available with panel, post or pedestal support options, Run-off Desks pair with a Modular Cabinet Top or a Low Console. Run-off Desks can be placed "off module" along a Modular Cabinet Top and feature a stepped workspace.

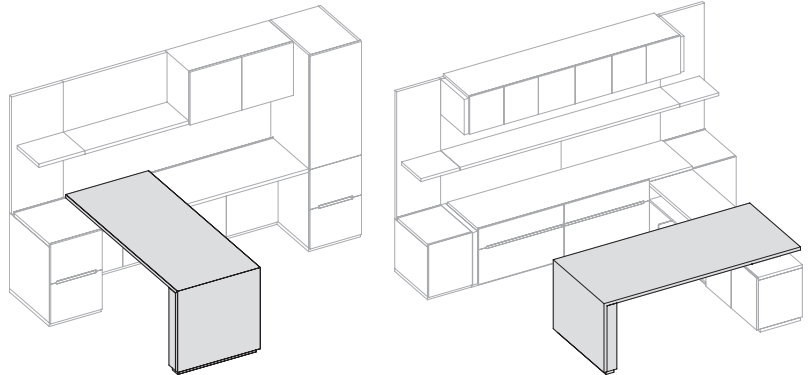
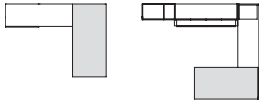

Overlay Run-off Desk (Panel End)

Overlay Run-off Desk (Panel End)

CONSOLE DESK

The Console Desk is always used with a Low Console in an L-shape sideworkwall and can be paired with either workspace or low height storage components. A Modular Cabinet Top supports the workwall end and the Low Console supports the opposite end. Specify either a Tech Spacer or Tech Drawer to connect desk top and Low Console.

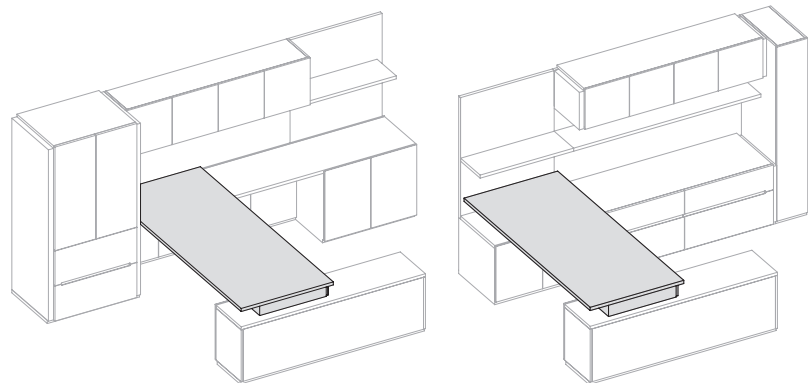
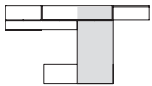

Console Desk
(2 H Lower Storage)

Console Desk
(1.5 H Lower Storage)

WORKTABLE APPLICATION

Worktables are offered in two heights and feature a variety of support, modesty and pedestal options. Featuring access wall panels or access cabinets, Worktables are available for both workwall and non-workwall configurations.

Worktables with access cabinets are available in both worksurface and low heights. Worktables with access kneespace supports and height adjustment are offered in worksurface height only.

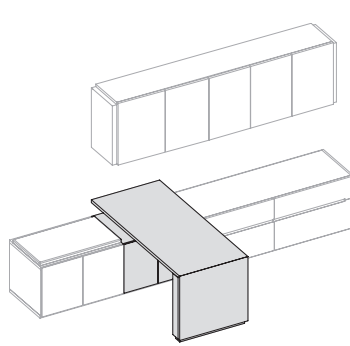

Overlay Worktable
(Access Cabinet, 1.5 H)

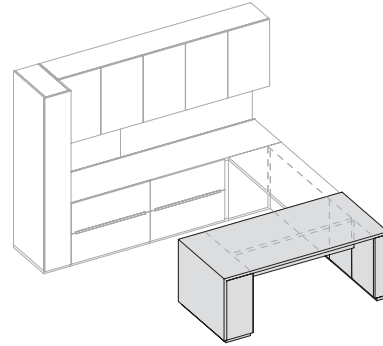

Overlay Worktable
(Access Kneespace)

OVERLAY WORKTABLES

Overlay Worktables are available with access wall panels and cabinets and height adjustment. Specify these non-workwall Worktables for layouts and offices without Wall Panels above the worksurface.

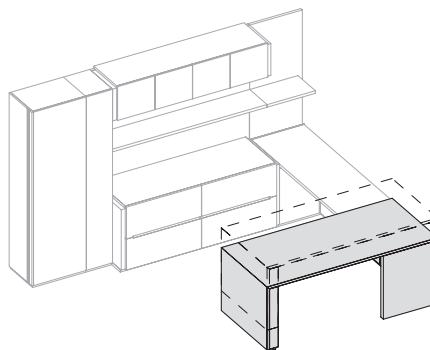
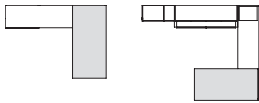

Overlay Worktable
(Height Adjustable)

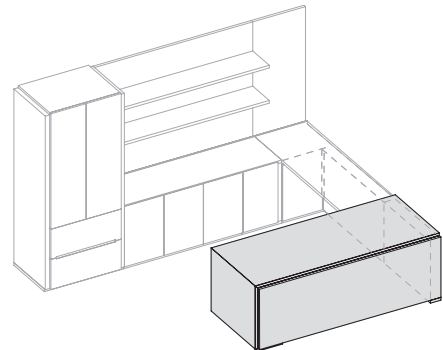

Overlay Worktable
(Access Kneespace, Full Modesty)

WORKWALL OVERLAY WORKTABLES

Workwall Overlay Worktables are available with access wall panel, access cabinet and height adjustment options. Designed for use along the workwall, these worktables feature a wire management drop space and should always be paired with a Wall Panel above.

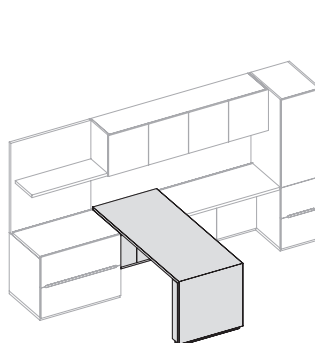
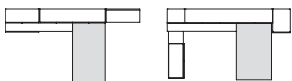

Workwall Overlay Worktable
(Access Kneespace)

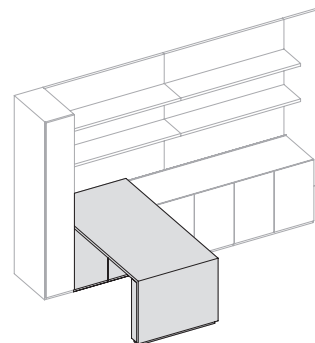

Workwall Overlay Worktable
(Access Cabinet, 2 H)

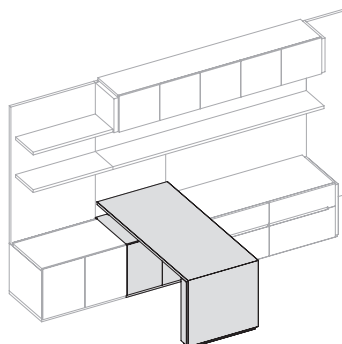

Workwall Overlay Worktable
(Access Cabinet, 1.5 H)

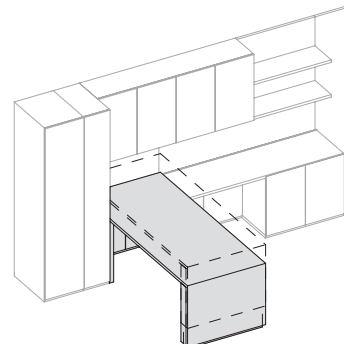

Workwall Overlay Worktable
(Height Adjustable)

POST-SUPPORT WORKTABLES

Post-support Worktables feature a flush worksurface and are offered with Access Kneespace Supports in worksurface height only for both workwall and non-workwall configurations.

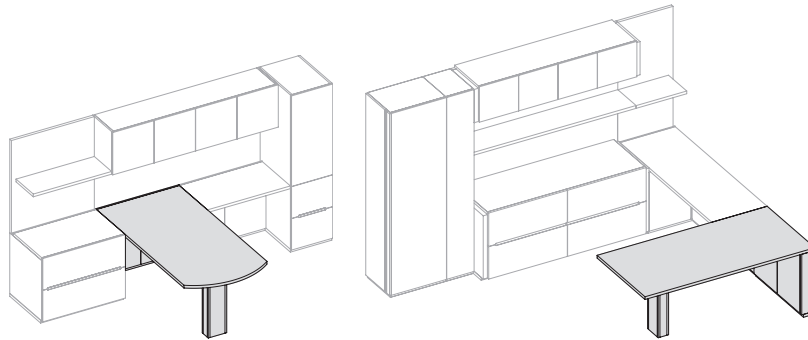
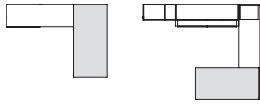

Workwall Worktable w/ Post Support

Worktable w/ Post Support

DESK & WORKTABLE FEATURES AND OPTIONS

DESK & WORKTABLE SUPPORTS

Desks and Worktables feature a variety of support, modesty and pedestal options. Overlay Desks and Worktables feature a mitered desk top with panel, pedestal and height adjustable options.

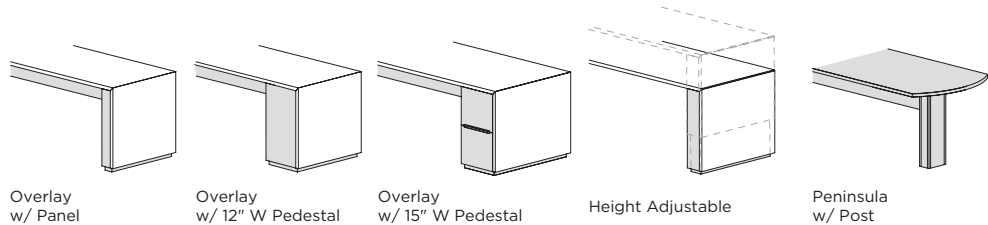

Overlay
w/ Panel

Overlay
w/ 12" W Pedestal

Overlay
w/ 15" W Pedestal

Height Adjustable

Peninsula
w/ Post

DESK & WORKTABLE PEDESTAL OPTIONS

Desk and Worktable Pedestals are offered in two drawer styles to coordinate with the Drawer Styles outlined on page 798. The 12"W pedestal features an integrated side pull and offers a space-saving solution at the desk including concealed box and file drawers. The 15"W box/file pedestal features an integrated center pull and flush drawer face and coordinates with Drawer Style 2. Both pedestal styles offer a technology charging and storage tray option.

Design Tip: For extra storage at the desk, select the 12"W pedestal for Desks paired with Drawer Styles 1, 3 or 4 in a workwall.

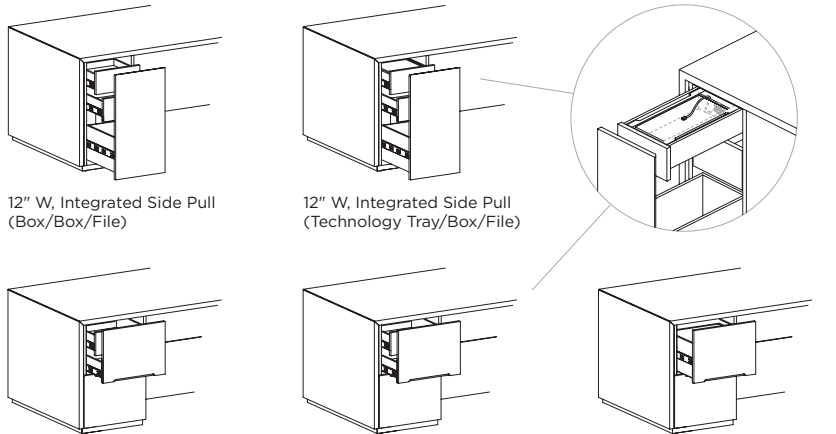

12" W, Integrated Side Pull
(Box/Box/File)

12" W, Integrated Side Pull
(Technology Tray/Box/File)

15" W, Integrated Center Pull
(Box/Box/File)

15" W, Integrated Center Pull
(Technology Tray/Box/File)

15" W, Integrated Center Pull
(File/File)

DESK & WORKTABLE MODESTY

Modesty Panels (partial height) are standard on all Desks and Worktables except for Run-off Desks which are only available without a modesty panel. The Overlay Desk is available with a full modesty along with pedestal options.

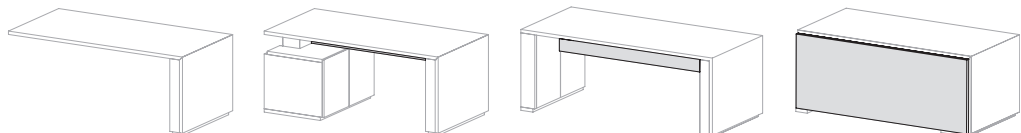

No Modesty
(Runoff Desks)

Partial Height Modesty
(Low Height,
Cabinet Worktables)

Partial Height Modesty
(Access Panel
& Cabinet Worktables)

Full Height Modesty
(Overlay Worktable)

DESK HEIGHTS

Overlay Worktables feature a stepped top (30.5" H) to accentuate the overlay detail and Post-support Worktables feature flush tops (29.5" H).

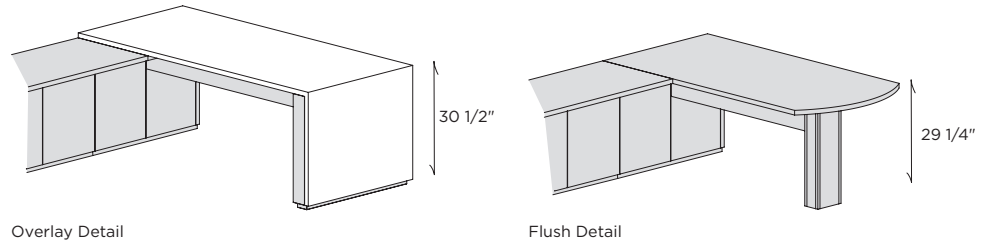

EDGE DETAIL

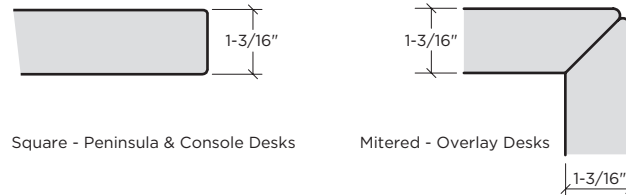

LOW CONSOLE APPLICATION

Low Consoles connect with Run-off and Console Desks, supporting work-in-process organization and a multi-tiered workspace. The components outlined in the key below combine with Low Consoles to create U-shape back and L-shape side workwall layouts.

- ① Low Console
- ② Run-off Desk
- ③ Console Desk
- ④ Low Height Corner Dock, Credenza
- ⑤ Low Height Workwall Credenza
- ⑥ Tech Spacer or Tech Drawer

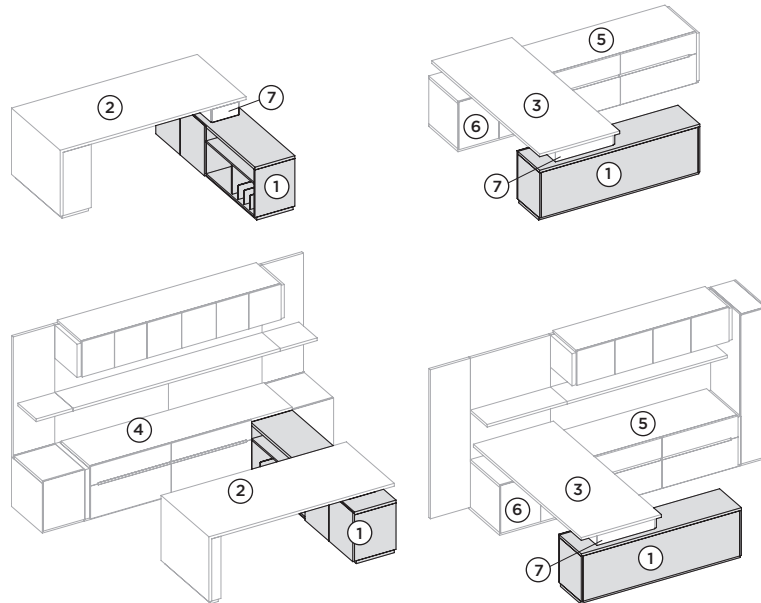
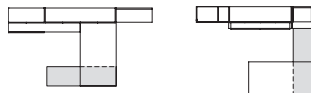

LOW CONSOLE FEATURES & OPTIONS

Low Consoles feature paper trays and open storage for small printers, binders, files or personal items. A hinged cabinet and cable chase support wire management and easy access. Select either a Tech Spacer or Tech Drawer with the Low Console and specify the Cushion separately.

- ① Open Storage
- ② Divided Storage
- ③ Shelf with Paper Trays
- ④ Technology Cabinet
- ⑤ Technology Drawer
- ⑥ Technology Spacer
- ⑦ Cushion

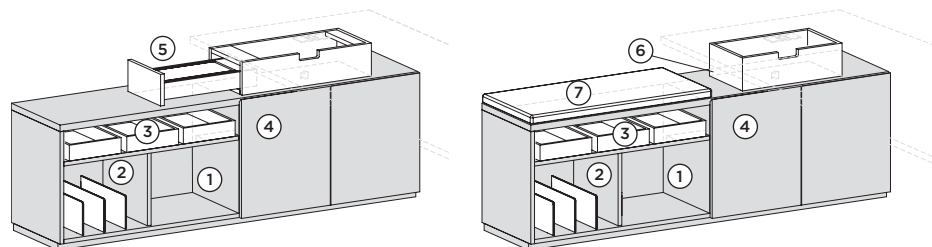

PLANNING - FREESTANDING STORAGE AND FILES

Slate's Freestanding Storage and File offering includes innovative media display and slide-out server solutions. A selection of wardrobe, bookcase and file units offer personal and archival storage options.

FREESTANDING STORAGE, WORKWALL APPLICATION

- ① Storage Cabinet, Wardrobe
- ② Storage Cabinet, File/File
- ③ Overlay Storage Cabinet w/ Lateral File
- ④ Slide-out Server
- ⑤ Single Sided Wall Unit, Workwall
- ⑥ Bookcase, Workwall

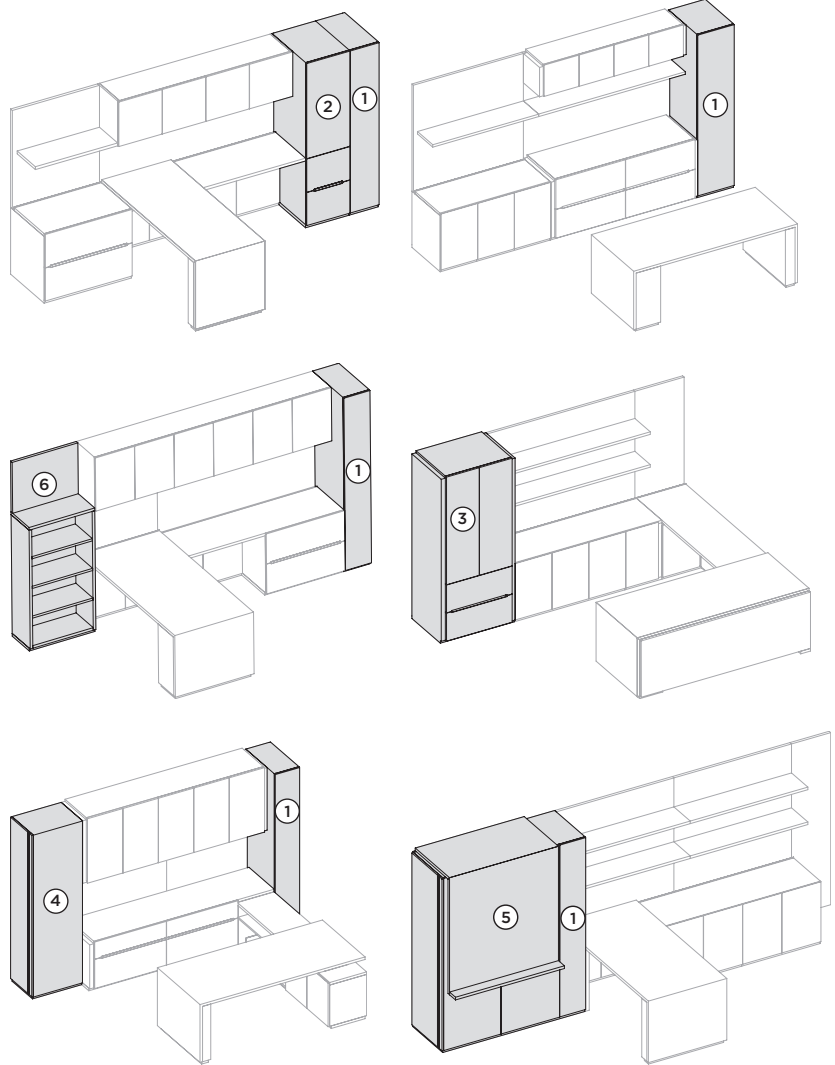

FREESTANDING STORAGE APPLICATION

- ⑦ Single-sided, Wall Unit, Freestanding

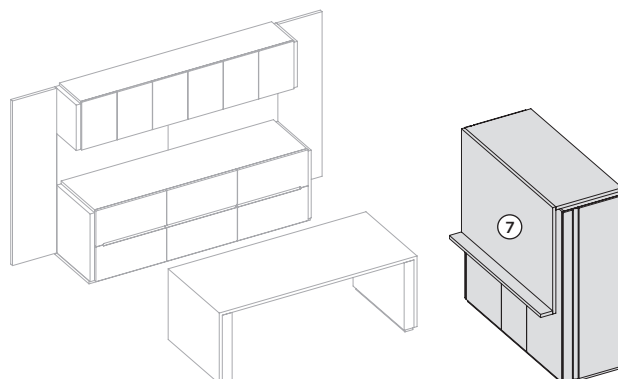

WORKWALL STORAGE CABINET PLANNING

TALL STORAGE CABINET

Tall Storage Cabinets with File drawers feature Drawer Style 2 and should always be paired with Drawer Style 2 modular storage components in the same workwall. Available in two heights (68.75" & 80.75") and one size (18"W x 24"D).

Design Tip: Always match the height of Freestanding Storage units with overall height of workwall.

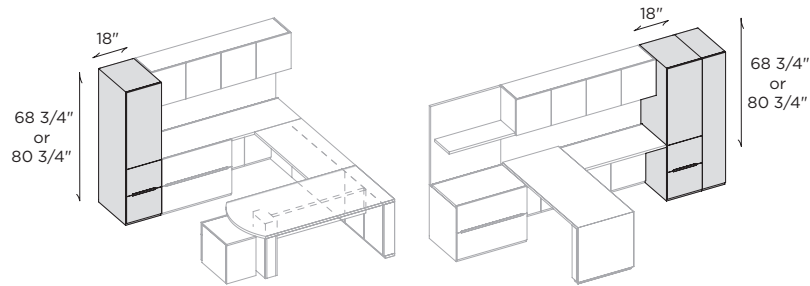

WARDROBE CABINET

Wardrobe cabinets are offered in both 18" and 24" depths to coordinate with Slide-out Server (18"D) and Single-sided Wall Units or Overlay Cabinet (24"D) depths. Always match the depth of storage cabinets used side by side in a workwall. Different depths of cabinets can be used in the same workwall when placed on opposite ends.

Design Tip: Different depths of cabinets can be used in the same workwall when placed on opposite ends.

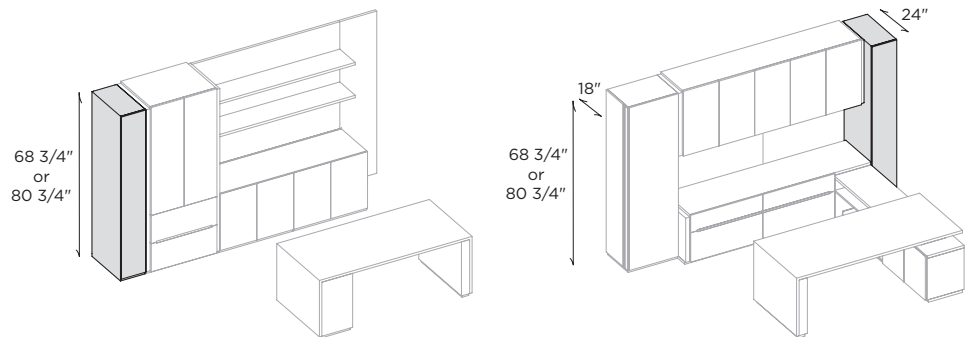

OVERLAY CABINET

Overlay Cabinets with lateral file drawers feature Drawer Style 1 and should always be paired with Drawer Style 1 or Style 3 modular storage components in the same workwall.

Available in two heights to align with the workwall heights and two widths (30"W and 36"W) and one depth (25.25"D).

Design Tip: To accentuate the Overlay detail on these units, pair with Organizers with open shelves or flush doors.

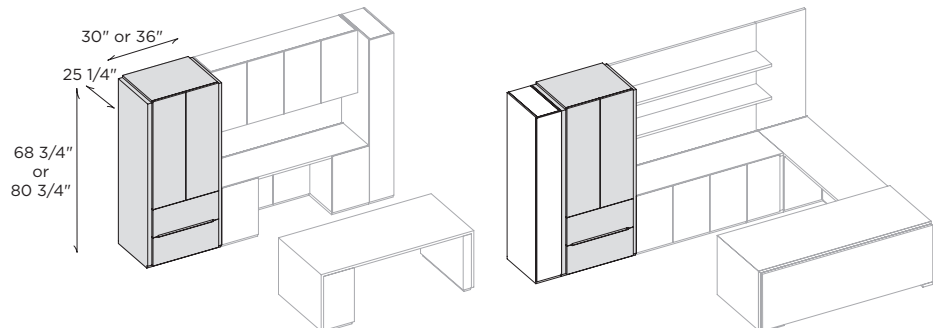

SLIDE-OUT SERVER

Slide-out Servers include a counter top, waste bin and storage spaces to support in-office beverage and food service.

These units are handed and are always placed at the end of a workwall. Available in two heights (68.75" & 80.75") and one size (18"D x 24"W). Specify separately or together with a wardrobe cabinet of equal height and depth (18").

Design Tip: The Slide-out server cabinet requires a minimum space of 24" between the end of the unit and an adjacent wall or object.

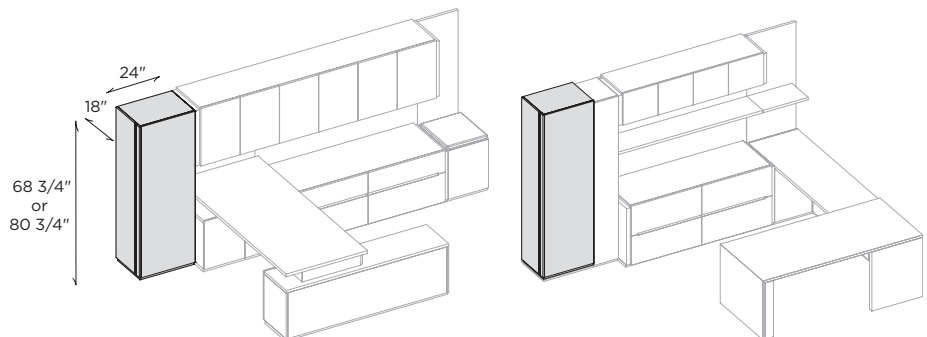

SINGLE-SIDED, WALL UNIT

Single-sided, Wall Units integrate technology and a slide-out server into the workwall. An Overlay Panel displays flat screen monitor/s and a lower cabinet provides technology storage, along with wire management and access. These Units are handed and always placed at the end of a workwall. Available in two heights (68.75" & 80.75") and two widths (54/66"W x 24"D).

Design Tip: Specify separately or together with a wardrobe cabinet of equal height and depth (24").

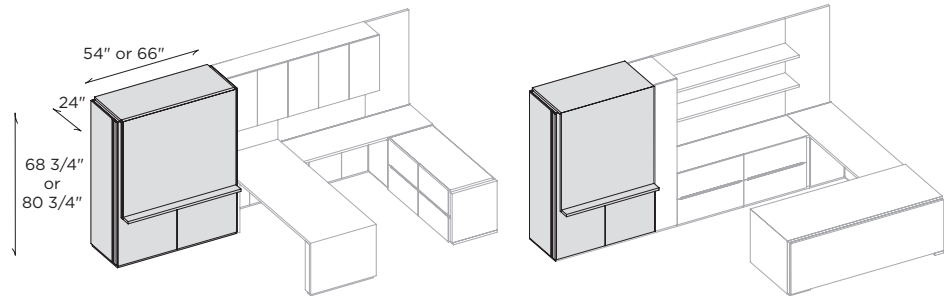

BOOKCASE

Bookcases are unhandled and offered in one depth (14.25") and two widths (30/36"W). Bookcases are offered in two heights (68.75" and 80.75") and have been designed to align with Wallmount Organizer heights (1, 1.5 or 2 H). Specify the Bookcase unit that aligns with the Organizer height selected as shown right and as outlined in the Pricelist.

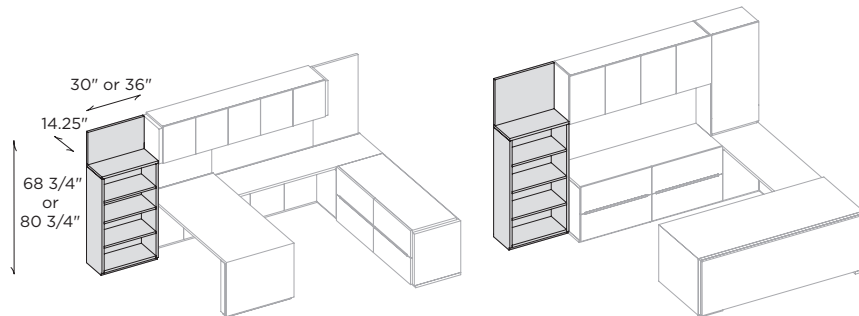

MODULAR LATERAL FILES

Modular Lateral Files feature Drawer Style 2 and can be used in both freestanding and workwall applications. Order Modular Cabinet Tops separately and specify a full depth top for freestanding or a top with wire drop, back edge for workwalls.

When placing same height file units side by side in a row, specify a full depth top equal to the total width of the file units. When placing different height file units side by side in a stepped row, specify the same width top for each. See examples shown right.

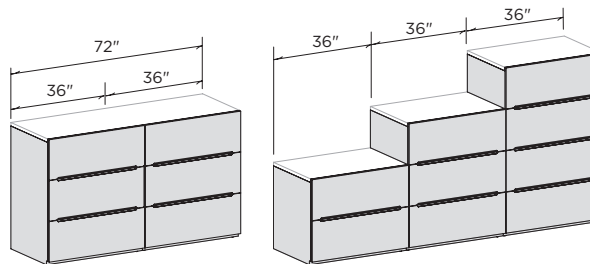

FINISHES

Slate's finish offering includes composite veneer, paint, glass and textile options supporting a broad range of design possibilities.

Create a workstation in all veneer or contrast veneer and paint. Back Panels can be a tackable textile, magnetic glass or veneer.

Several examples of finish options and combinations are shown below. See the Price List for the complete finish offering for each component.

FINISH KEY

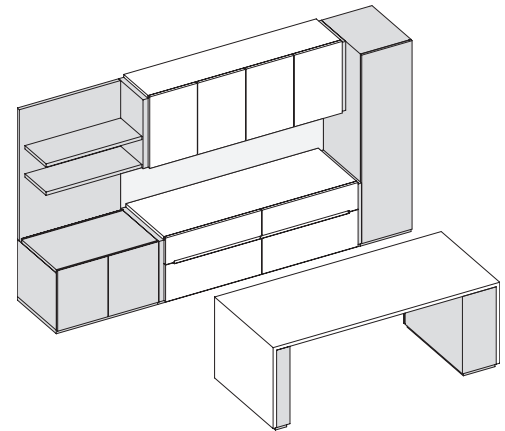
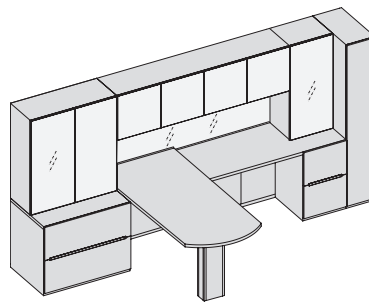
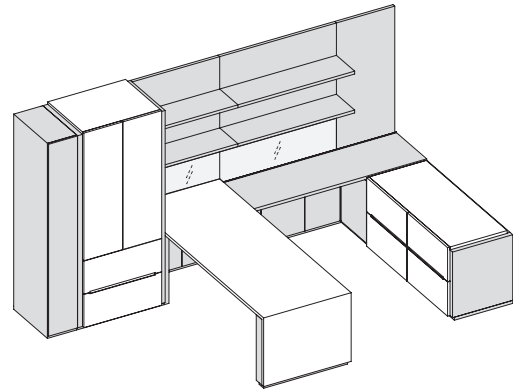
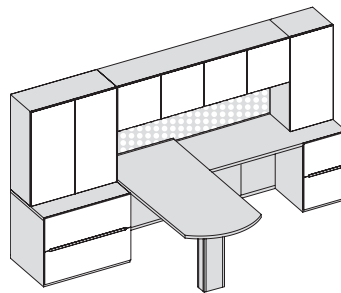
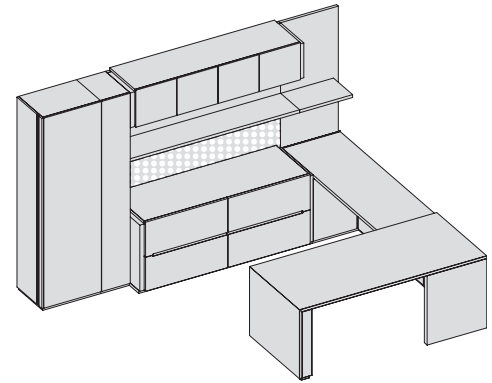
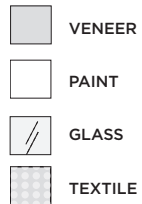

GRAIN DIRECTION

Slate is offered in composite veneers featuring a horizontal grain direction which accentuates the modern architectural aesthetic. Modular Cabinet Tops and Bridges can be specified short or long grain. Several examples of grain direction are shown in the workstation illustrations below.

FINISH KEY

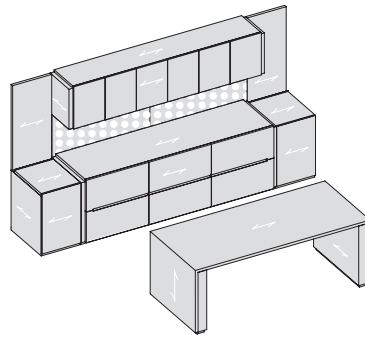
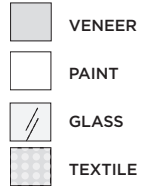

Freestanding Desk, Back Workwall

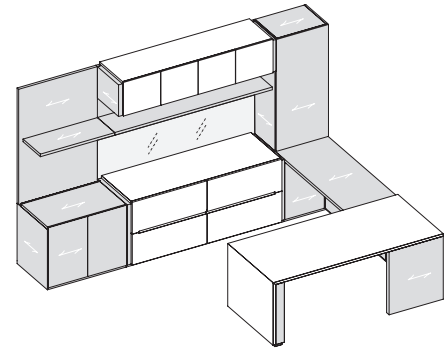

U-shape, Back Workwall

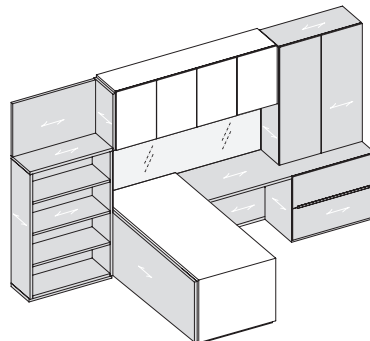

L-shape, Side Workwall

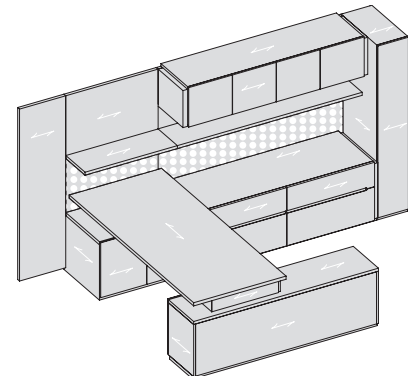

L-shape, Side Workwall

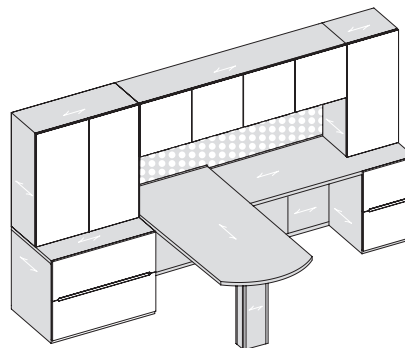

L-shape, Side Workwall

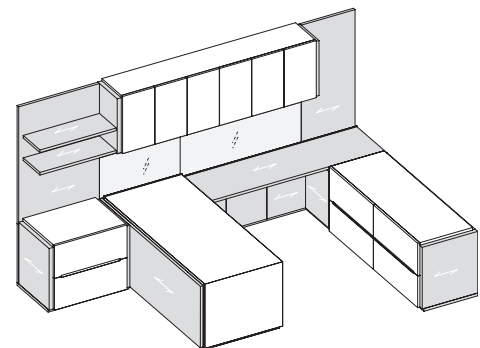

U-shape, Side Workwall