

Obeya light assembly instructions

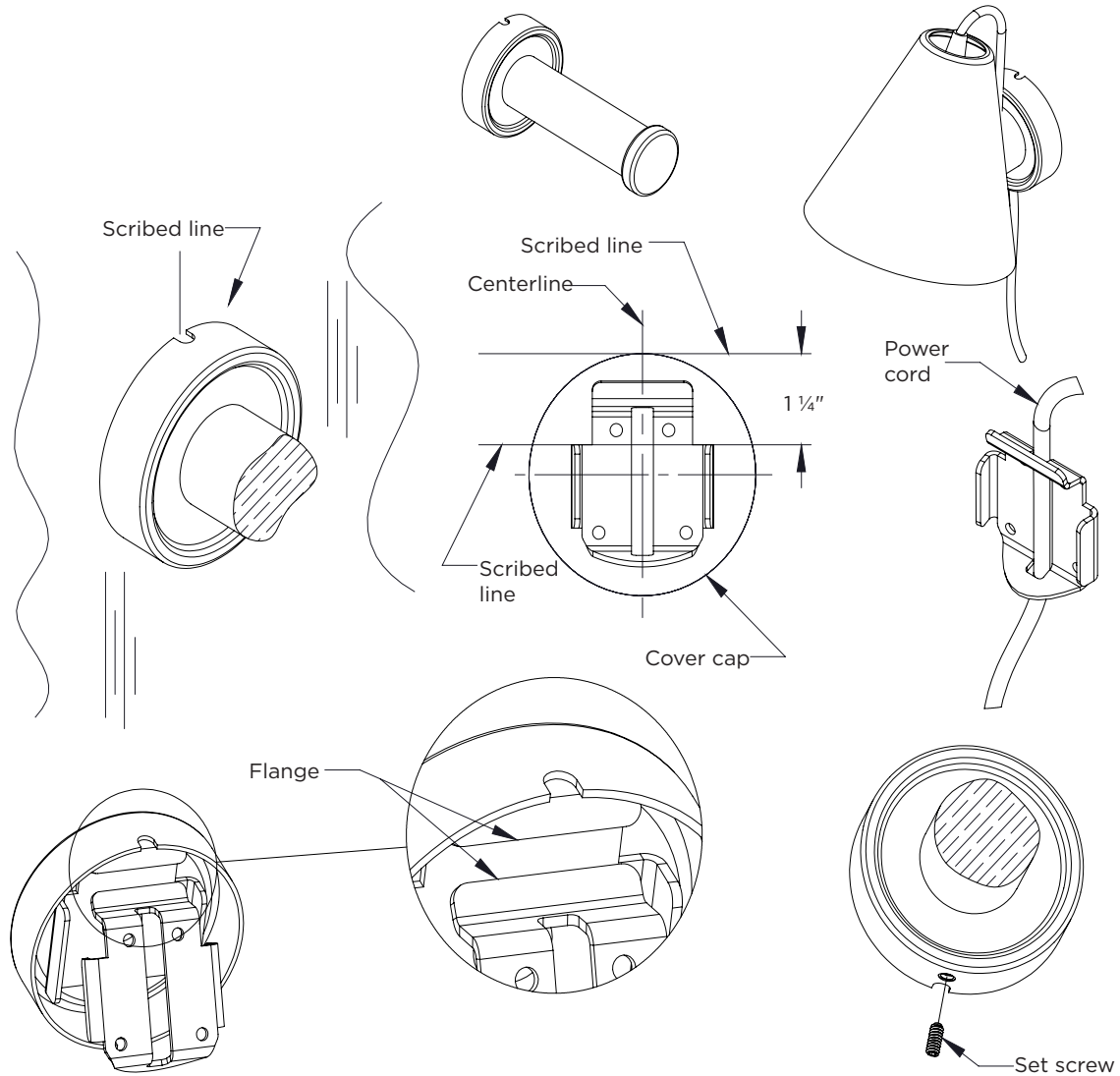

Wall mount light accessory installation

This sheet covers the necessary steps to install either the Accessory Lamp or Accessory Light Hanging Pole.



1. Begin by positioning the Accessory Lamp or Light Pole in its desired installed location. Next, scribe a line along the top edge of the cover cap and also mark the center location of the power cord slot, as shown in the view above. Set the Lamp or Light Pole to the side, and scribe an additional line 1 1/4" below the horizontal line. Also, continue the vertical centerline downward, as shown in the view above.
2. With the positioning lines marked, slip the power cord into the notch of the wall mount bracket and then place the bracket onto the wall as shown in the view above. Position the bracket as shown and then fasten to the wall utilizing the four mount holes.
3. Next, tilt the Lamp or Light Pole upward and slide down onto the wall mount bracket. The flange inside the cover cap needs to engage onto the upper most flange of the wall mount bracket as shown above. Once the Lamp or Light Pole has been engaged onto the wall mount bracket, tilt downward and apply slight pressure downward to fully seat in place. Lastly, thread the set screw into the bottom of the cover cap and then fully tighten. The power cord can then be adjusted upward or downward as needed.