

## Staks panel connections

---





## Table of contents

Overview	3
Inline panel connection	4-5
2-way panel connection (left)	6-7
2-way panel connection (right)	8-9
T panel connection	10-11
3-way panel connection	12-13
4-way panel connection	14-15

## Panel overview

- After placing panels, determine which end will be your left end and right end

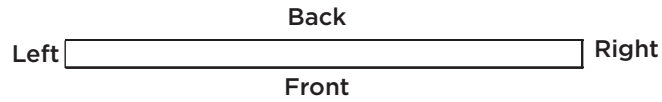

## Typical machine code reference:

- **Note:** Machine codes and clean seam connectors shown below are based on panels being the same height. Reference the following pages to determine the correct machine code for you panel connections
- **Note:** Panel ends or faces that do not connect to another panel will always be machine code A

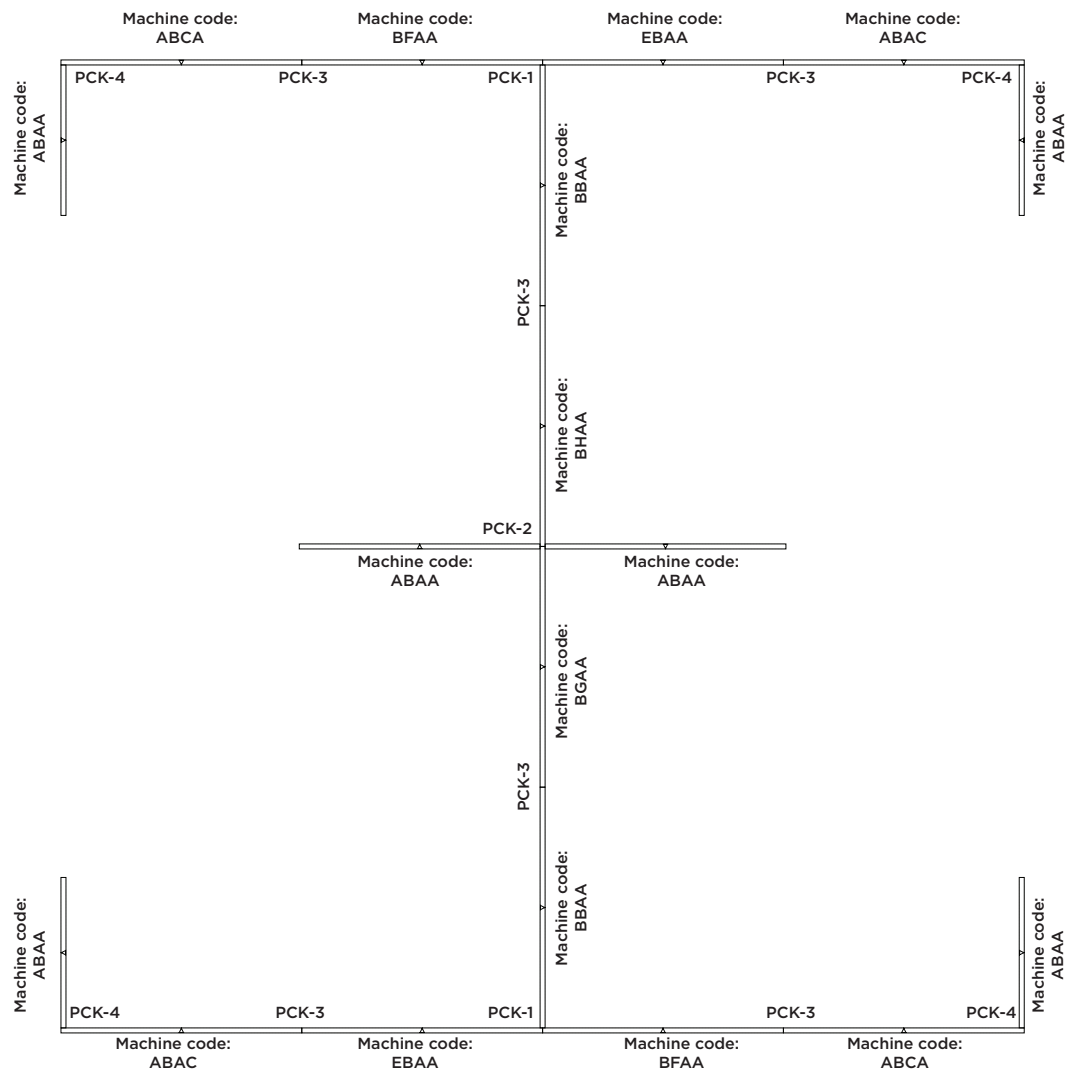

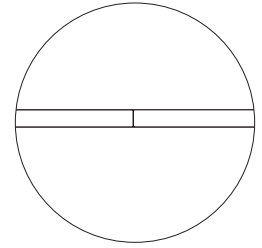

**Inline connection - overview**

**Panel codes**

**B** - 2-way shallow clip or shoulder screw

**B33** - 2-way shallow clip or shoulder screw (33" high/low)

**B42** - 2-way shallow clip or shoulder screw (42" high/low)

**Clean seam connector**

**PCK-3** - Inline panel to panel connector kit for 42"h or 48"h panels

**PCK-7** - Inline panel to panel connector kit for 33"h panels



Panel location reference

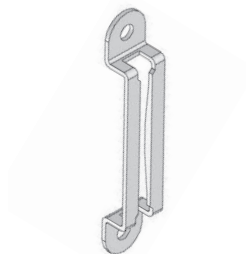

Panel clip



1" shoulder screw

PCK-3 / PCK-7 components

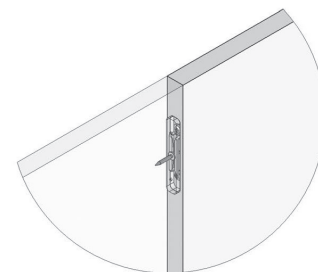
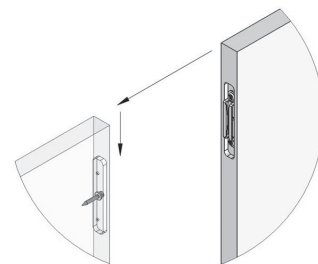

Panel connection reference

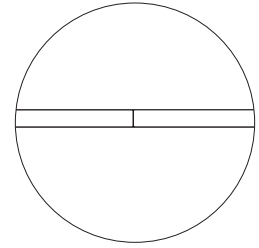

## Inline connection - configurations

### 42" h and/or 48" h panel connections

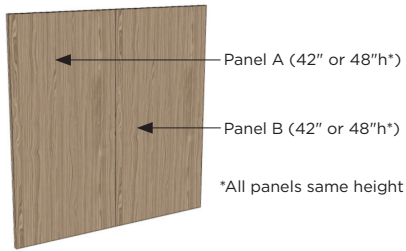

#### Two 48" h or two 42" h panels

- Panel A right panel code:
- (B) 2 way shallow clip or shoulder screw
- Panel B left panel code:
- (B) 2 way shallow clip or shoulder screw
- Connector kit:
- PCK-3

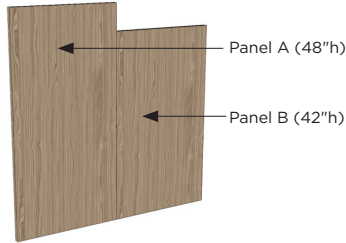

#### 48" h down to 42" h panel

- Panel A right panel code:
- (B42) 2 way shallow clip or shoulder screw (42" high/low)
- Panel B left panel code:
- (B) 2 way shallow clip or shoulder screw
- Connector kit:
- PCK-3

### 33" h panel connections

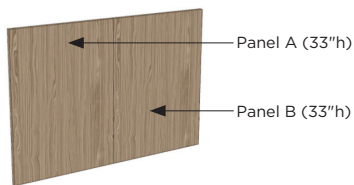

#### Two 33" h panels

- Panel A right panel code:
- (B) 2 way shallow clip or shoulder screw
- Panel B left panel code:
- (B) 2 way shallow clip or shoulder screw
- Connector kit:
- PCK-7

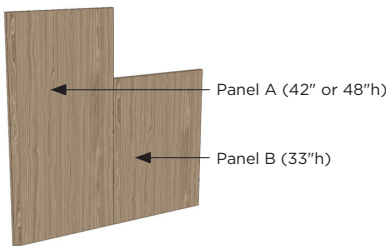

#### 42" h or 48" h panel down to 33" h panel

- Panel A right panel code:
- (B33) 2 way shallow clip or shoulder screw (33" high/low)
- Panel B left panel code:
- (B) 2 way shallow clip or shoulder screw
- Connector kit:
- PCK-7

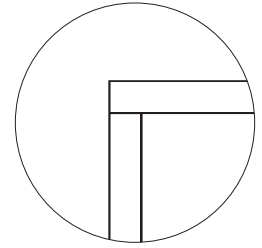

**2 way connection (left hand) - overview**

**Panel codes**

- B - 2-way shallow clip or shoulder screw
- C - Left shoulder screw
- C33 - Left shoulder screw (33" high/low)
- C42 - Left shoulder screw (42" high/low)

**Clean seam connector**

- PCK-4 - T and L connector kit for two 42" or 48" panels
- PCK-8 - T and L connector kit for two 33" panels

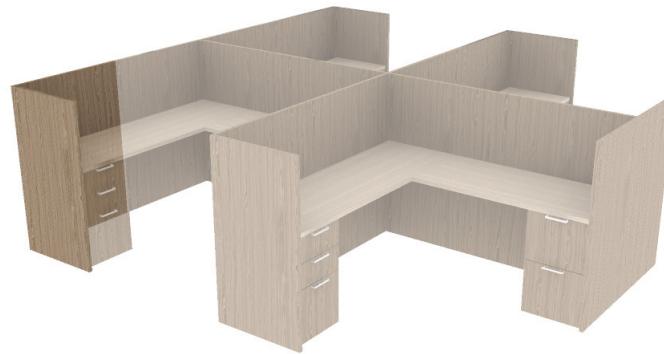

Panel location reference

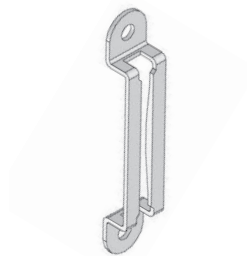

Panel clip

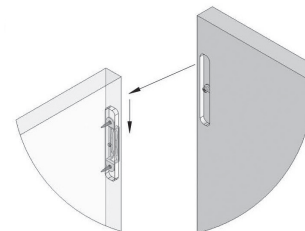

3/8" shoulder screw

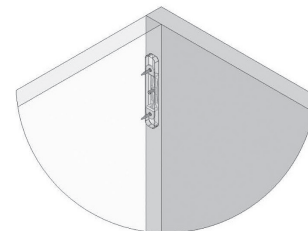

PCK-4 / PCK-8 components

Panel connection reference

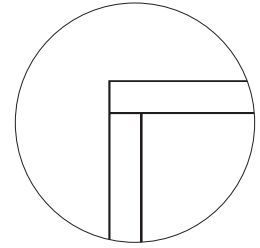

## 2-way connection (left hand) - configurations

### 42" h and/or 48" h panel connections

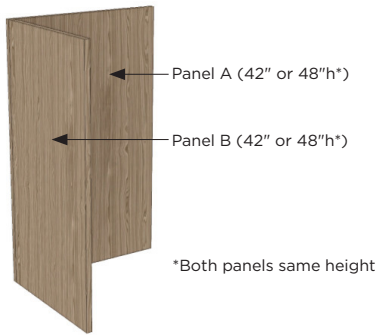

#### Both panels 42" h, or 48" h

Panel A front panel code:

- (C) left shoulder screw

Panel B left panel code:

- (B) 2 way shallow clip or shoulder screw

Connector kit:

- PCK-4

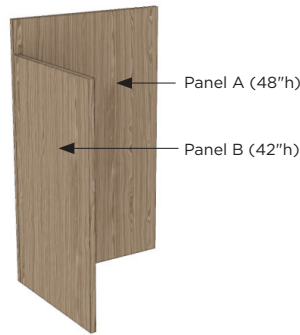

#### 48" h with 42" h wing panel

Panel A front panel code:

- (C42) left shoulder screw (42" high/low)

Panel B left panel code:

- (B) 2 way shallow clip or shoulder screw

Connector kit:

- PCK-4

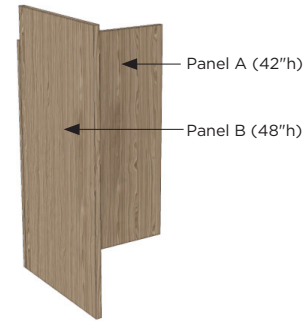

#### 42" h with 48" h wing panel

Panel A front panel code:

- (C) left shoulder screw

Panel B left panel code:

- (B42) 2 way shallow clip or shoulder screw (42" high/low)

Connector kit:

- PCK-4

### 33" h panel connections

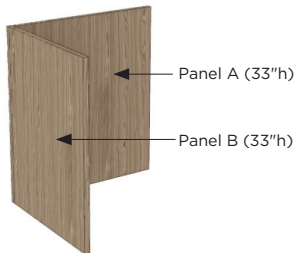

#### Two 33" h panels

Panel A front panel code:

- (C) left shoulder screw

Panel B left panel code:

- (B) 2 way shallow clip or shoulder screw

Connector kit:

- PCK-8

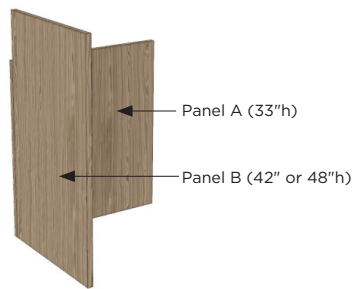

#### 33" h with 42" h wing panel

Panel A front panel code:

- (C) left shoulder screw

Panel B left panel code:

- (B33) 2 way shallow clip or shoulder screw (33" high/low)

Connector kit:

- PCK-8

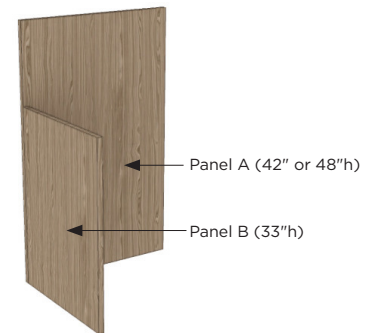

#### 42" h or 48" h with 33" h wing panel

Panel A front panel code:

- (C33) left shoulder screw (33" high/low)

Panel B left panel code:

- (B) 2 way shallow clip or shoulder screw

Connector kit:

- PCK-8

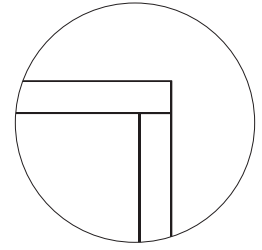

**2 way connection (right hand) - overview**

**Panel codes**

- B - 2-way shallow clip or shoulder screw
- D - Right shoulder screw
- D33 - Right shoulder screw (33" high/low)
- D42 - Right shoulder screw (42" high/low)

**Clean seam connector**

- PCK-4 - T and L connector kit for two 42" h or 48" h panels
- PCK-8 - T and L connector kit for two 33" h panels



Panel location reference

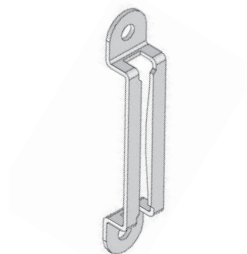

Panel clip

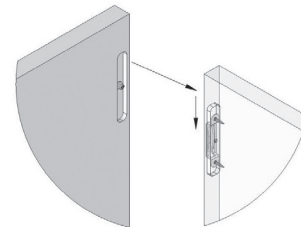

3/8" shoulder screw

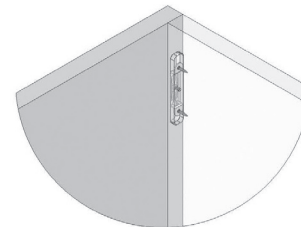

PCK-4 / PCK-8 components

Panel connection reference



## 2-way connection (left hand) - configurations

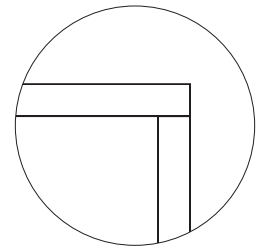

### 42" h and/or 48" h panel connections

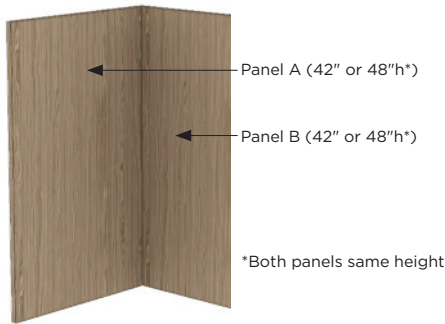

#### Both panels 42" h, or 48" h

- Panel A front panel code:  
 • (D) right shoulder screw  
 Panel B left panel code:  
 • (B) 2 way shallow clip or shoulder screw  
 Connector kit:  
 • PCK-4

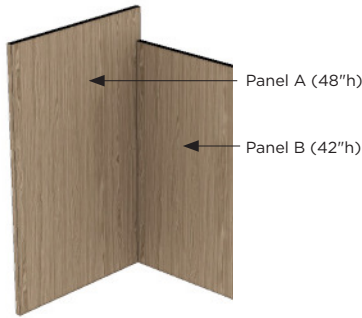

#### 48" h with 42" h wing panel

- Panel A front panel code:  
 • (D42) right shoulder screw (42" high/low)  
 Panel B left panel code:  
 • (B) 2 way shallow clip or shoulder screw  
 Connector kit:  
 • PCK-4

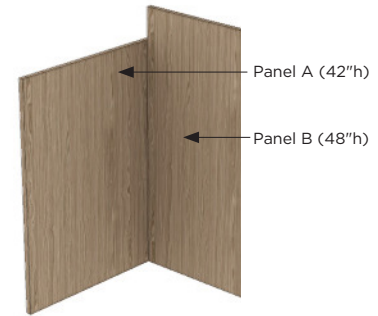

#### 42" h with 48" h wing panel

- Panel A front panel code:  
 • (D) right shoulder screw  
 Panel B left panel code:  
 • (B42) 2 way shallow clip or shoulder screw (42" high/low)  
 Connector kit:  
 • PCK-4

### 33" h panel connections

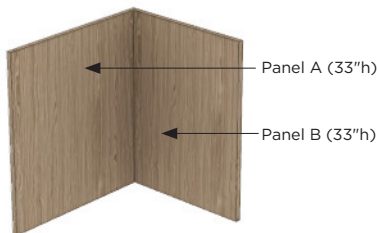

#### Two 33" h panels

- Panel A front panel code:  
 • (D) right shoulder screw  
 Panel B left panel code:  
 • (B) 2 way shallow clip or shoulder screw  
 Connector kit:  
 • PCK-8

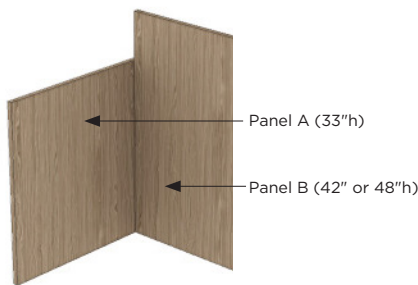

#### 33" h with 42" h wing panel

- Panel A front panel code:  
 • (D) right shoulder screw  
 Panel B left panel code:  
 • (B33) 2 way shallow clip or shoulder screw (33" high/low)  
 Connector kit:  
 • PCK-8

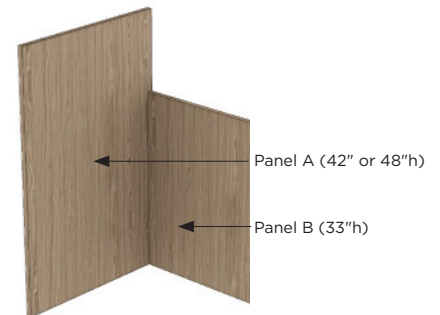

#### 42" h or 48" h with 33" h wing panel

- Panel A front panel code:  
 • (D33) right shoulder screw (33" high/low)  
 Panel B left panel code:  
 • (B) 2 way shallow clip or shoulder screw  
 Connector kit:  
 • PCK-8

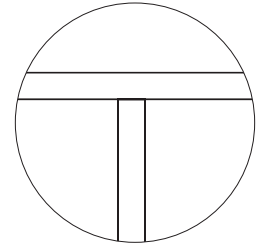

**T connection - overview**

**Panel codes**

- B - 2-way shallow clip or shoulder screw
- B - Center shoulder screw
- B33 - Center shoulder screw (33" high/low)
- B42 - Center shoulder screw (42" high/low)

**Clean seam connector**

- PCK-4 - T and L connector kit for two 42" h or 48" h panels
- PCK-8 - T and L connector kit for two 33" h panels

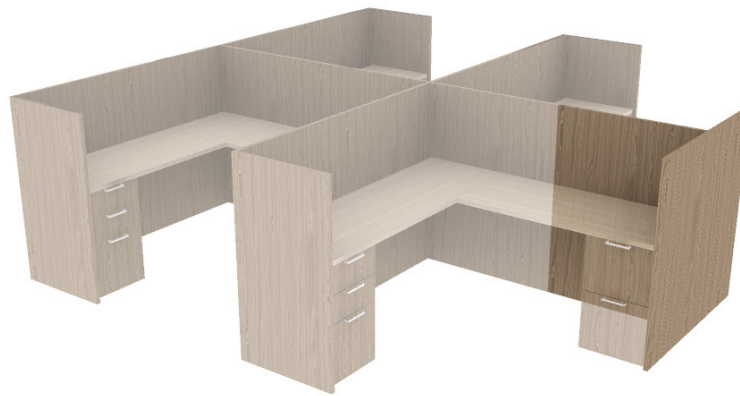

Panel location reference

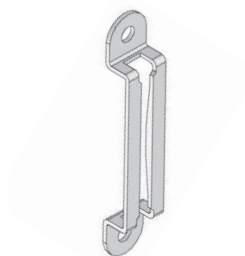

Panel clip



5/8" shoulder screw

PCK-4 / PCK-8 components

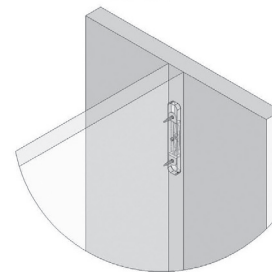
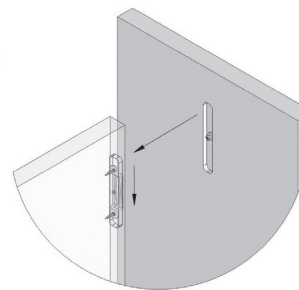

Panel connection reference

## T connection - configurations

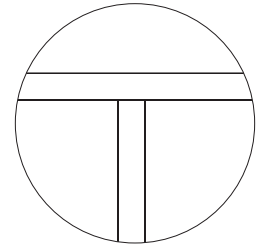

### 42" h and/or 48" h panel connections

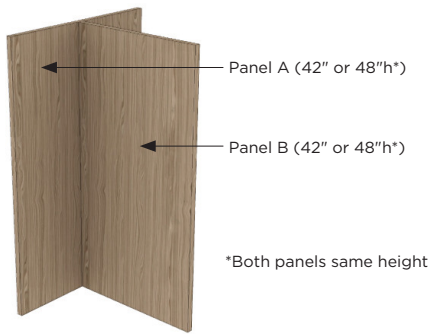

#### Two 48" h or 42" h panels

- Panel A front panel code:
- (B) Center shoulder screw
- Panel B left panel code:
- (B) 2 way shallow clip or shoulder screw
- Connector kit:
- PCK-4

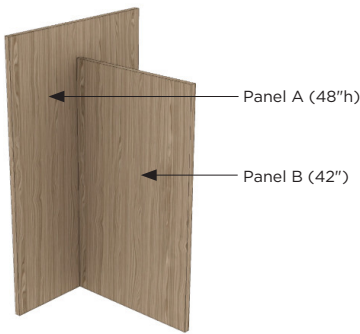

#### 48" h down to 42" h panel

- Panel A front panel code:
- (B42) Center shoulder screw (42" high/low)
- Panel B left panel code:
- (B) 2 way shallow clip or shoulder screw
- Connector kit:
- PCK-4

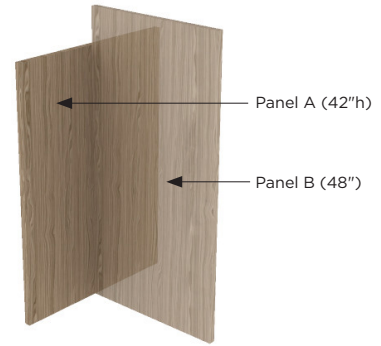

#### 42" h up to 48" h panel

- Panel A front panel code:
- (B) Center shoulder screw
- Panel B left panel code:
- (B42) 2 way shallow clip or shoulder screw (42" high/low)
- Connector kit:
- PCK-4

### 33" h panel connections

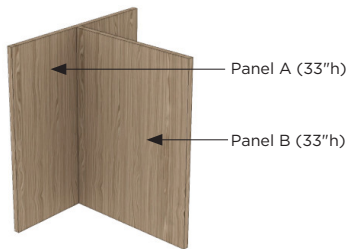

#### Two 33" h panels

- Panel A front panel code:
- (B) Center shoulder screw
- Panel B left panel code:
- (B) 2 way shallow clip or shoulder screw
- Connector kit:
- PCK-8

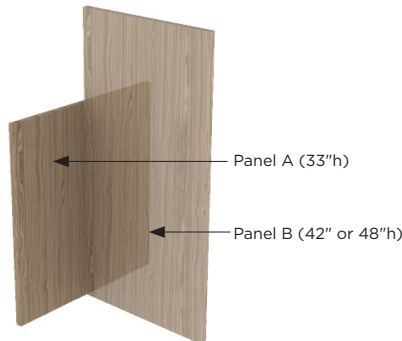

#### 33" h up to 42" h or 48" h panel

- Panel A front panel code:
- (B) Center shoulder screw
- Panel B left panel code:
- (B33) 2 way shallow clip or shoulder screw (33" high/low)
- Connector kit:
- PCK-8

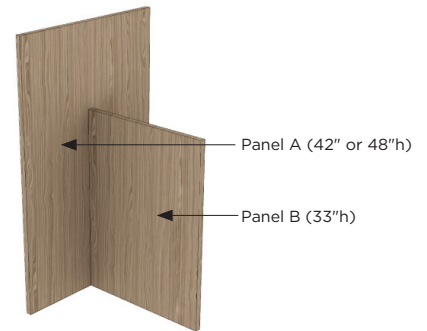

#### 48" h or 42" h down to 33" h panel

- Panel A front panel code:
- (B33) Center shoulder screw (33" high/low)
- Panel B left panel code:
- (B) 2 way shallow clip or shoulder screw
- Connector kit:
- PCK-8

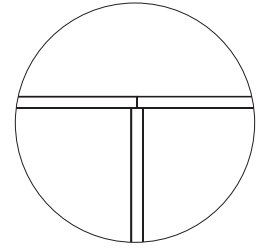

## 3 way connection - overview

### Panel codes

- B - 2-way shallow clip or shoulder screw
- E - 3-way block front
- E33 - 3-way block front (33" high/low)
- E42 - 3-way block front (42" high/low)
- F - 3-way deep clip front
- F33 - 3-way deep clip front (33" high/low)
- F42 - 3-way deep clip front (42" high/low)

### Clean seam connector

- PCK-1 - T connector kit for three 42" h or 48" h panels, or two 42" h panels up to 48" h
- PCK-5 - T connector kit for three 33" h panels, or two 33" h panels connected to two 42" h or 48" h panels
- PCK-9 - T connector kit for two 42" h or 48" h panels connected to one 33" h panel
- PCK-11 - T connector kit for two 48" h panels connected to one 42" h panel



Panel location reference

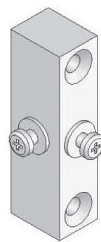

T connection screw block

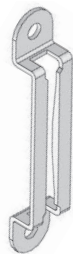
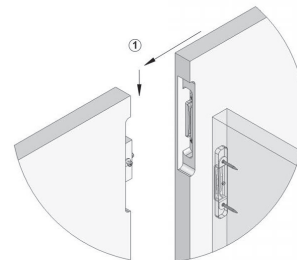

Panel clip

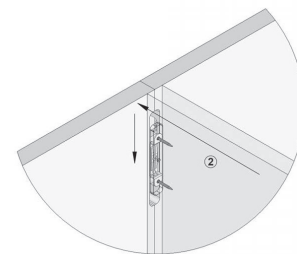

PCK-1 / PCK-5 / PCK-9 / PCK-11 components

Panel connection reference

## 3 way connection - configurations

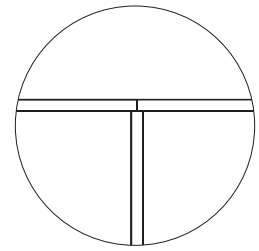

### 42" h and/or 48" h panel connections

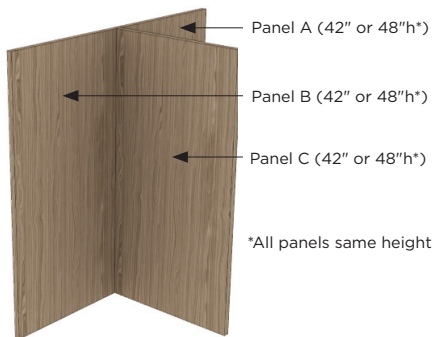

#### Three 48" h or 42" h panels

- Panel A left panel code:
- (E) 3-way block front
- Panel B right panel code:
- (F) 3-way deep clip front
- Panel C left panel code:
- (B) 2 way shallow clip or shoulder screw
- Connector kit:
- PCK-1

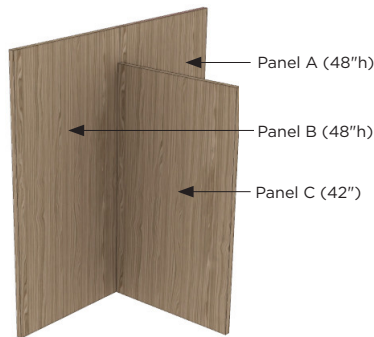

#### Two 48" h down to 42" h panel

- Panel A left panel code:
- (E42) 3-way block front (42" high/low)
- Panel B right panel code:
- (F42) 3-way deep clip front (42" high/low)
- Panel C left panel code:
- (B) 2 way shallow clip or shoulder screw
- Connector kit:
- PCK-11

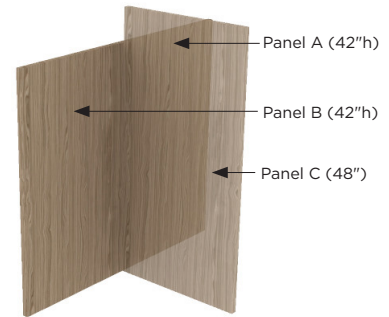

#### Two 42" h up to 48" h panel

- Panel A left panel code:
- (E) 3-way block front
- Panel B right panel code:
- (F) 3-way deep clip front
- Panel C left panel code:
- (B42) 2 way shallow clip or shoulder screw (42" high/low)
- Connector kit:
- PCK-1

### 33" h panel connections

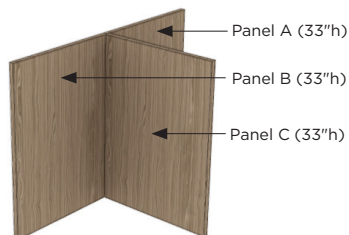

#### Three 33" h panels

- Panel A left panel code:
- (E) 3-way block front
- Panel B right panel code:
- (F) 3-way deep clip front
- Panel C left panel code:
- (B) 2 way shallow clip or shoulder screw
- Connector kit:
- PCK-5

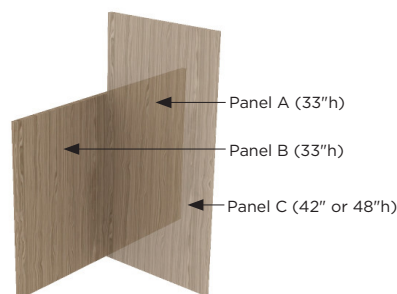

#### Two 33" h up to 48" h or 42" h panel

- Panel A left panel code:
- (E) 3-way block front
- Panel B right panel code:
- (F) 3-way deep clip front
- Panel C left panel code:
- (B33) 2 way shallow clip or shoulder screw (33" high/low)
- Connector kit:
- PCK-5

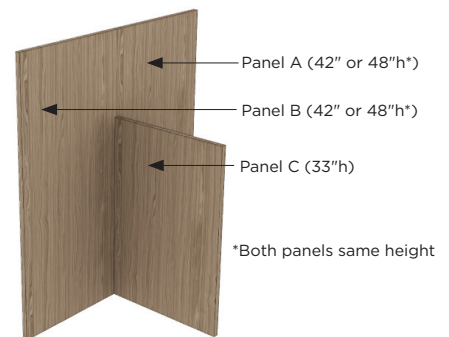

#### Two 48" h or 42" h down to 33" h panel

- Panel A left panel code:
- (E33) 3-way block front (33" high/low)
- Panel B right panel code:
- (F33) 3-way deep clip front (33" high/low)
- Panel C left panel code:
- (B) 2-way shallow clip or shoulder screw
- Connector kit:
- PCK-9

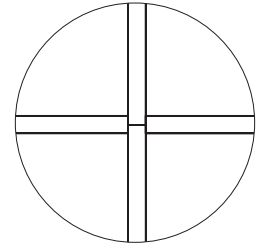

## 4 way connection

### Panel codes

B - 2-way shallow clip or shoulder screw

G - 4-way block

G33 - 4-way block (33" high/low)

G42 - 4-way block (42" high/low)

H - 4-way deep clip

H33 - 4-way deep clip (33" high/low)

H42 - 4-way deep clip (42" high/low)

### Clean seam connector

PCK-2 - X connector kit for four 42" or 48" panels

PCK-6 - X connector kit for four 33" panels

PCK-10 - X connector kit for two 42" or 48" panels connected to two 33" panels

PCK-12 - X connector kit for two 48" panels connected to two 42" panels



Panel location reference

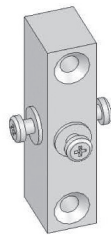

X connection screw block

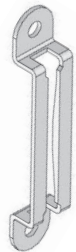

Panel clip

PCK-2 / PCK-6 / PCK-10 / PCK-12 components

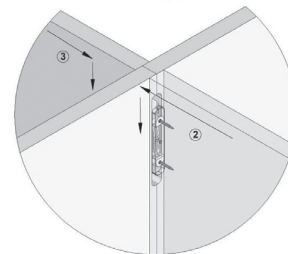
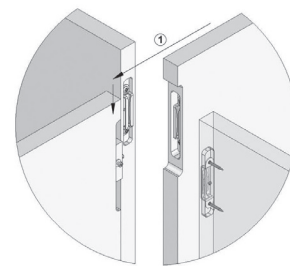

Panel connection reference

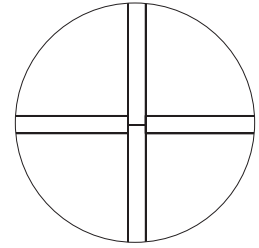

## 4-way connection - configurations

### 42" h and/or 48" h panel connections

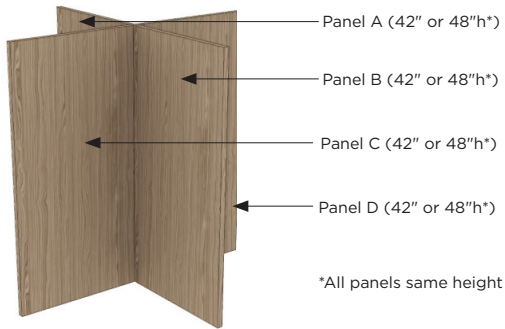

#### Four 42" h or 48" h panels

- Panel A right panel code:
  - (H) 4-way deep clip
- Panel B left panel code:
  - (G) 4-way block
- Panel C right panel code:
  - (B) 2 way shallow clip or shoulder screw
- Panel D left panel code:
  - (B) 2 way shallow clip or shoulder screw
- Connector kit:
  - PCK-2

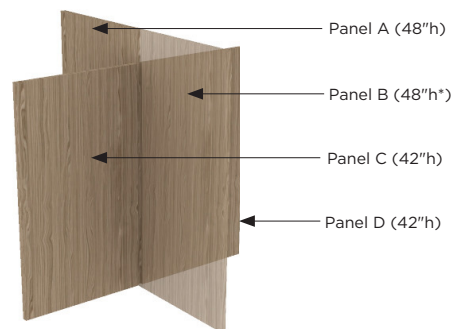

#### Two 48" h down to two 42" h panels

- Panel A right panel code:
  - (H42) 4-way deep clip (42" high/low)
- Panel B left panel code:
  - (G42) 4-way block (42" high/low)
- Panel C right panel code:
  - (B) 2 way shallow clip or shoulder screw
- Panel D left panel code:
  - (B) 2 way shallow clip or shoulder screw
- Connector kit:
  - PCK-12

### 33" h panel connections

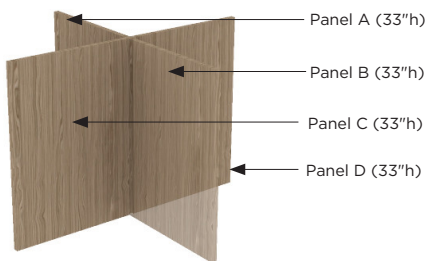

#### Four 33" h panels

- Panel A right panel code:
  - (H) 4-way deep clip
- Panel B left panel code:
  - (G) 4-way block
- Panel C right panel code:
  - (B) 2 way shallow clip or shoulder screw
- Panel D left panel code:
  - (B) 2 way shallow clip or shoulder screw
- Connector kit:
  - PCK-6

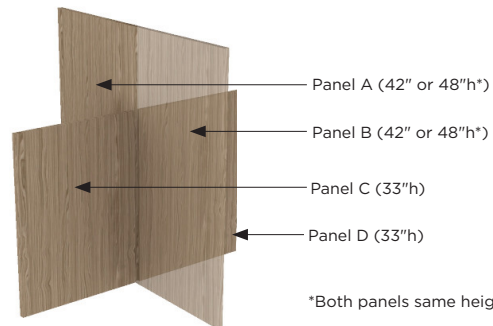

#### Two 48" h or 42" h down to two 33" h panels

- Panel A right panel code:
  - (H33) 4-way deep clip (33" high/low)
- Panel B left panel code:
  - (G33) 4-way block (33" high/low)
- Panel C right panel code:
  - (B) 2 way shallow clip or shoulder screw
- Panel D left panel code:
  - (B) 2 way shallow clip or shoulder screw
- Connector kit:
  - PCK-10