

PET WORKSURFACE EDGE MODESTY STANDARD FEATURES

- For Use with Tops when these Options are Specified: Deuce Static Bases (ASC, ASCW, ASO, ASOW, ASCA, ASOA), T Static Bases (TSC, TSO), Arc Static Base (RSC), Pneumatic Bases (C3N, C3R) and Electric Bases (C3T, C3U, C3M, C3Q)
- Leaves a 1.5"W Gap Between Modesty and Worksurface Edge for Wire Management
- 15" Deep Wing Ends
- Mount Brackets Included

Note: Use with Applause Only

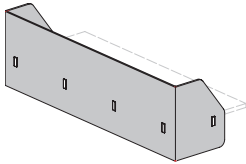

model	w	d	h	wt	cu ft	list
A4812WEMP	52	17	21	13.5	3.5	\$ 847

- Use with 48" Rectangular Worksurface
- 12" Above Worksurface Height

A6012WEMP	64	17	21	14	4	\$ 849
------------------	----	----	----	----	---	--------

- Use with 60" Rectangular Worksurface
- 12" Above Worksurface Height

A6612WEMP	70	17	21	14.5	4.25	\$ 852
------------------	----	----	----	------	------	--------

- Use with 66" Rectangular Worksurface
- 12" Above Worksurface Height

A7212WEMP	76	17	21	15	4.5	\$ 854
------------------	----	----	----	----	-----	--------

- Use with 72" Rectangular Worksurface
- 12" Above Worksurface Height

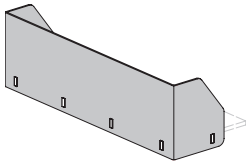

model	w	d	h	wt	cu ft	list
A4818WEMP	52	17	21	13.5	3.5	\$ 847

- Use with 48" Rectangular Worksurface
- 18" Above Worksurface Height

A6018WEMP	64	17	21	14	4	\$ 849
------------------	----	----	----	----	---	--------

- Use with 60" Rectangular Worksurface
- 18" Above Worksurface Height

A6618WEMP	70	17	21	14.5	4.25	\$ 852
------------------	----	----	----	------	------	--------

- Use with 66" Rectangular Worksurface
- 18" Above Worksurface Height

A7218WEMP	76	17	21	15	4.5	\$ 854
------------------	----	----	----	----	-----	--------

- Use with 72" Rectangular Worksurface
- 18" Above Worksurface Height

OPTIONS

Finish	Bracket Finish	
BLACK	PAL Polished Aluminum	Studio Powder Coat (Upcharge \$48)
GREIGE	Standard Powder Coat	CADT Cadet
FOSSIL	BWT Bone White	CLOV Clover
CADET	BUFF Buff	GLDN Goldenrod
	CHLK Chalk	HERN Heron
	SGLD Gold	LATT Latte
	GRPH Graphite	MOSS Moss
	MSL Luster Grey	RUSS Russet
	HIP Oiled Bronze	SUNS Sunset
	BKO Onyx	
	POLR Polar	
	SBRZ Soft Bronze	
	HIF Warm Grey	

HOW TO ORDER

SPECIFY: Finish | Bracket Finish.

MODEL NUMBER

A4812WEMP

Finish	Bracket Finish
BLACK	BWT

PET WORKSURFACE EDGE MODESTY STANDARD FEATURES

- For Use with Tops when these Options are Specified: Deuce Static Bases (ASC, ASCW, ASO, ASOW, ASCA, ASOA), T Static Bases (TSC, TSO), Arc Static Base (RSC), Pneumatic Bases (C3N, C3R) and Electric Bases (C3T, C3U, C3M, C3Q)
- Leaves a 1.5"W Gap Between Modesty and Worksurface Edge for Wire Management
- Mount Brackets Included

Note: Use with Applause Only

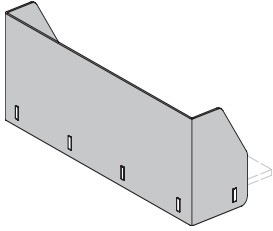

model	w	d	h	wt	cu ft	list
A4824WEMP	52	17	27	15.5	4.5	\$ 1,119
<ul style="list-style-type: none"> • Use with 48" Rectangular Worksurface • 15" Deep Wing Ends • 24" Above Worksurface Height 						
A6024WEMP	64	17	27	16.5	5	\$ 1,124
<ul style="list-style-type: none"> • Use with 60" Rectangular Worksurface • 15" Deep Wing Ends • 24" Above Worksurface Height 						
A6624WEMP	70	17	27	17	5.25	\$ 1,127
<ul style="list-style-type: none"> • Use with 66" Rectangular Worksurface • 15" Deep Wing Ends • 24" Above Worksurface Height 						
A7224WEMP	76	17	27	17.5	5.75	\$ 1,132
<ul style="list-style-type: none"> • Use with 72" Rectangular Worksurface • 15" Deep Wing Ends • 24" Above Worksurface Height 						

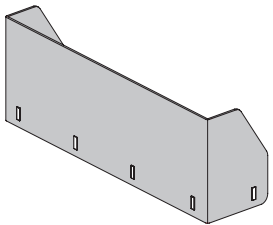

model	w	d	h	wt	cu ft	list
A4824EWEMP	52	29	27	17.5	5.75	\$ 1,132
<ul style="list-style-type: none"> • Use with 48" Rectangular Worksurface • 27" Deep Wing Ends • 24" Above Worksurface Height • Use on 30" & 36" Deep Tables Only 						
A6024EWEMP	64	23	27	17.5	5.75	\$ 1,132
<ul style="list-style-type: none"> • Use with 60" Rectangular Worksurface • 21" Deep Wing Ends • 24" Above Worksurface Height • Use on 24", 30" & 36" Deep Tables Only 						
A6624EWEMP	70	20	27	17.5	5.75	\$ 1,132
<ul style="list-style-type: none"> • Use with 66" Rectangular Worksurface • 18" Deep Wing Ends • 24" Above Worksurface Height 						

OPTIONS

Finish	Bracket Finish
BLACK	PAL Polished Aluminum
GREIGE	Standard Powder Coat
FOSSIL	BWT Bone White
CADET	BUFF Buff
	CHLK Chalk
	SGLD Gold
	GRPH Graphite
	MSL Luster Grey
	HIP Oiled Bronze
	BKO Onyx
	POLR Polar
	SBRZ Soft Bronze
	HIF Warm Grey
	STUDIO Studio Powder Coat (Upcharge \$48)
	CADT Cadet
	CLOV Clover
	GLDN Goldenrod
	HERN Heron
	LATT Latte
	MOSS Moss
	RUSS Russet
	SUNS Sunset

HOW TO ORDER

SPECIFY: Finish | Bracket Finish.

MODEL NUMBER

A4824WEMP

Finish	Bracket Finish
BLACK	BWT

PET WORKSURFACE EDGE MODESTY STANDARD FEATURES

- For Use on Static Height Stand Alone Tables Only
- Mount Brackets Included
- Leaves a 1.5"W Gap Between Modesty and Worksurface Edge for Wire Management
- 15" Deep Wing Ends

NOTE: Use With Agile Only

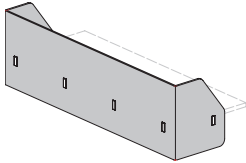

model	w	d	h	wt	cu ft	list
A-WEMP-4812	52	17	21	13	3.5	\$ 953
<ul style="list-style-type: none"> • Use with 48" Rectangular Worksurface • 12" Above Worksurface Height 						
A-WEMP-5412	58	17	21	13.5	3.75	\$ 955
<ul style="list-style-type: none"> • Use with 54" Rectangular Worksurface • 12" Above Worksurface Height 						
A-WEMP-6012	64	17	21	14	4	\$ 956
<ul style="list-style-type: none"> • Use with 60" Rectangular Worksurface • 12" Above Worksurface Height 						
A-WEMP-6612	70	17	21	14.5	4.25	\$ 958
<ul style="list-style-type: none"> • Use with 66" Rectangular Worksurface • 12" Above Worksurface Height 						
A-WEMP-7212	76	17	21	15	4.5	\$ 961
<ul style="list-style-type: none"> • Use with 72" Rectangular Worksurface • 12" Above Worksurface Height 						

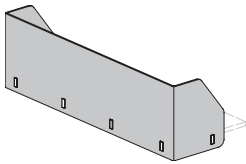

model	w	d	h	wt	cu ft	list
A-WEMP-4818	52	17	21	13	3.5	\$ 953
<ul style="list-style-type: none"> • Use with 48" Rectangular Worksurface • 18" Above Worksurface Height 						
A-WEMP-5418	58	17	21	13.5	3.75	\$ 955
<ul style="list-style-type: none"> • Use with 54" Rectangular Worksurface • 18" Above Worksurface Height 						
A-WEMP-6018	64	17	21	14	4	\$ 956
<ul style="list-style-type: none"> • Use with 60" Rectangular Worksurface • 18" Above Worksurface Height 						
A-WEMP-6618	70	17	21	14.5	4.25	\$ 958
<ul style="list-style-type: none"> • Use with 66" Rectangular Worksurface • 18" Above Worksurface Height 						
A-WEMP-7218	76	17	21	15	4.5	\$ 961
<ul style="list-style-type: none"> • Use with 72" Rectangular Worksurface • 18" Above Worksurface Height 						

OPTIONS

Finish	Bracket Finish	
BLACK	Standard Powder Coat	Studio Powder Coat (Upcharge \$48)
GREIGE	BWT Bone White	CADT Cadet
FOSSIL	BUFF Buff	CLOV Clover
CADET	CHLK Chalk	GLDN Goldenrod
	SGLD Gold	HERN Heron
	GRPH Graphite	LATT Latte
	MSL Luster Grey	MOSS Moss
	HIP Oiled Bronze	RUSS Russet
	BKO Onyx	SUNS Sunset
	POLR Polar	
	SBRZ Soft Bronze	
	HIF Warm Grey	

HOW TO ORDER

SPECIFY: Finish | Bracket Finish.

MODEL NUMBER

A-WEMP-4812

Finish	Bracket Finish
BLACK	BWT

PET WORKSURFACE EDGE MODESTY STANDARD FEATURES

- For Use on Static Height Stand Alone Tables Only
- Mount Brackets Included

- Leaves a 1.5"W Gap Between Modesty and Worksurface Edge for Wire Management

NOTE: Use With Agile Only

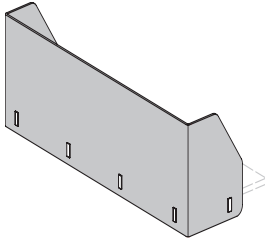

model	w	d	h	wt	cu ft	list
A-WEMP-4824	52	17	27	15.5	4.5	\$ 1,259
<ul style="list-style-type: none"> • Use with 48" Rectangular Worksurface • 24" Above Worksurface Height • 15" Deep Wing Ends 						
A-WEMP-5424	58	17	27	16	4.75	\$ 1,262
<ul style="list-style-type: none"> • Use with 54" Rectangular Worksurface • 24" Above Worksurface Height • 15" Deep Wing Ends 						
A-WEMP-6024	64	17	27	16.5	5	\$ 1,265
<ul style="list-style-type: none"> • Use with 60" Rectangular Worksurface • 24" Above Worksurface Height • 15" Deep Wing Ends 						
A-WEMP-6624	70	17	27	17	5.25	\$ 1,268
<ul style="list-style-type: none"> • Use with 66" Rectangular Worksurface • 24" Above Worksurface Height • 15" Deep Wing Ends 						
A-WEMP-7224	76	17	27	17.5	5.75	\$ 1,274
<ul style="list-style-type: none"> • Use with 72" Rectangular Worksurface • 24" Above Worksurface Height • 15" Deep Wing Ends 						

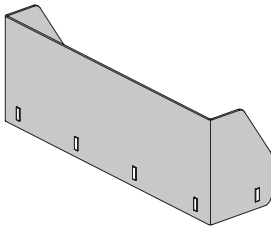

model	w	d	h	wt	cu ft	list
A-EWEMP-4824	52	29	27	17.5	5.75	\$ 1,274
<ul style="list-style-type: none"> • Use with 48" Rectangular Worksurface • 24" Above Worksurface Height • 27" Deep Wing Ends • Use on 30" Deep Tables Only 						
A-EWEMP-5424	58	26	27	17.5	5.75	\$ 1,274
<ul style="list-style-type: none"> • Use with 54" Rectangular Worksurface • 24" Above Worksurface Height • 24" Deep Wing Ends • Use on 30" Deep Tables Only 						
A-EWEMP-6024	64	23	27	17.5	5.75	\$ 1,274
<ul style="list-style-type: none"> • Use with 60" Rectangular Worksurface • 24" Above Worksurface Height • 21" Deep Wing Ends 						
A-EWEMP-6624	70	20	27	17.5	5.75	\$ 1,274
<ul style="list-style-type: none"> • Use with 66" Rectangular Worksurface • 24" Above Worksurface Height • 18" Deep Wing Ends 						

OPTIONS

Finish	Bracket Finish	
BLACK	Standard Powder Coat	Studio Powder Coat (Upcharge \$48)
GREIGE	BWT Bone White	CADT Cadet
FOSSIL	BUFF Buff	CLOV Clover
CADET	CHLK Chalk	GLDN Goldenrod
	SGLD Gold	HERN Heron
	GRPH Graphite	LATT Latte
	MSL Luster Grey	MOSS Moss
	HIP Oiled Bronze	RUSS Russet
	BKO Onyx	SUNS Sunset
	POLR Polar	
	SBRZ Soft Bronze	
	HIF Warm Grey	

HOW TO ORDER

SPECIFY: Finish | Bracket Finish.

MODEL NUMBER

A-WEMP-4824

Finish	Bracket Finish
BLACK	BWT

PET WORKSURFACE EDGE MODESTY STANDARD FEATURES

- For Use on Height Adjustable Tables Only
- Leaves a 1.5"W Gap Between Modesty and Worksurface Edge for Wire Management

- Mount Brackets Included
- 15" Deep Wing Ends

NOTE: Use With Agile Only

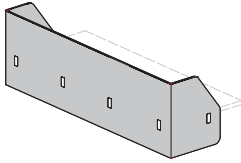

model	w	d	h	wt	cu ft	list
AH-WEMP-4612	50	17	21	13	3.5	\$ 952
<ul style="list-style-type: none"> • Use with 46" Rectangular Worksurface • 12" Above Worksurface Height 						
AH-WEMP-5212	56	17	21	13.5	3.75	\$ 953
<ul style="list-style-type: none"> • Use with 52" Rectangular Worksurface • 12" Above Worksurface Height 						
AH-WEMP-5812	62	17	21	14	4	\$ 956
<ul style="list-style-type: none"> • Use with 58" Rectangular Worksurface • 12" Above Worksurface Height 						
AH-WEMP-6412	68	17	21	14.5	4.25	\$ 958
<ul style="list-style-type: none"> • Use with 64" Rectangular Worksurface • 12" Above Worksurface Height 						
AH-WEMP-7012	74	17	21	15	4.5	\$ 961
<ul style="list-style-type: none"> • Use with 70" Rectangular Worksurface • 12" Above Worksurface Height 						

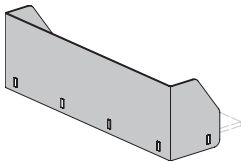

model	w	d	h	wt	cu ft	list
AH-WEMP-4618	50	17	21	13	3.5	\$ 952
<ul style="list-style-type: none"> • Use with 46" Rectangular Worksurface • 18" Above Worksurface Height 						
AH-WEMP-5218	56	17	21	13.5	3.75	\$ 953
<ul style="list-style-type: none"> • Use with 52" Rectangular Worksurface • 18" Above Worksurface Height 						
AH-WEMP-5818	62	17	21	14	4	\$ 956
<ul style="list-style-type: none"> • Use with 58" Rectangular Worksurface • 18" Above Worksurface Height 						
AH-WEMP-6418	68	17	21	14.5	4.25	\$ 958
<ul style="list-style-type: none"> • Use with 64" Rectangular Worksurface • 18" Above Worksurface Height 						
AH-WEMP-7018	74	17	21	15	4.5	\$ 961
<ul style="list-style-type: none"> • Use with 70" Rectangular Worksurface • 18" Above Worksurface Height 						

OPTIONS

Finish	Bracket Finish	
BLACK	Standard Powder Coat	Studio Powder Coat (Upcharge \$48)
GREIGE	BWT Bone White	CADT Cadet
FOSSIL	BUFF Buff	CLOV Clover
CADET	CHLK Chalk	GLDN Goldenrod
	SGLD Gold	HERN Heron
	GRPH Graphite	LATT Latte
	MSL Luster Grey	MOSS Moss
	HIP Oiled Bronze	RUSS Russet
	BKO Onyx	SUNS Sunset
	POLR Polar	
	SBRZ Soft Bronze	
	HIF Warm Grey	

HOW TO ORDER

SPECIFY: Finish | Bracket Finish.

MODEL NUMBER

AH-WEMP-4612

Finish	Bracket Finish
BLACK	BWT

PET WORKSURFACE EDGE MODESTY STANDARD FEATURES

- For Use on Height Adjustable Tables Only
- Mount Brackets Included

- Leaves a 1.5"W Gap Between Modesty and Worksurface Edge for Wire Management

NOTE: Use With Agile Only

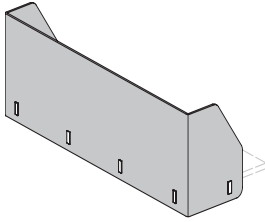

model	w	d	h	wt	cu ft	list
AH-WEMP-4624	50	17	27	15.5	4.5	\$ 1,259
<ul style="list-style-type: none"> • Use with 46" Rectangular Worksurface • 24" Above Worksurface Height • 15" Deep Wing Ends 						
AH-WEMP-5224	56	17	27	16	4.75	\$ 1,262
<ul style="list-style-type: none"> • Use with 52" Rectangular Worksurface • 24" Above Worksurface Height • 15" Deep Wing Ends 						
AH-WEMP-5824	62	17	27	16.5	5	\$ 1,265
<ul style="list-style-type: none"> • Use with 58" Rectangular Worksurface • 24" Above Worksurface Height • 15" Deep Wing Ends 						
AH-WEMP-6424	68	17	27	17	5.25	\$ 1,268
<ul style="list-style-type: none"> • Use with 64" Rectangular Worksurface • 24" Above Worksurface Height • 15" Deep Wing Ends 						
AH-WEMP-7024	74	17	27	17.5	5.75	\$ 1,274
<ul style="list-style-type: none"> • Use with 70" Rectangular Worksurface • 24" Above Worksurface Height • 15" Deep Wing Ends 						

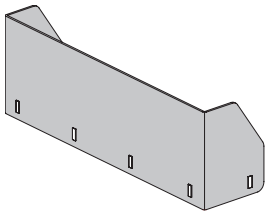

model	w	d	h	wt	cu ft	list
AH-EWEMP-4624	50	30	27	17.5	5.75	\$ 1,274
<ul style="list-style-type: none"> • Use with 46" Rectangular Worksurface • 24" Above Worksurface Height • 28" Deep Wing Ends • Use on 30" Deep Tables Only 						
AH-EWEMP-5224	56	27	27	17.5	5.75	\$ 1,274
<ul style="list-style-type: none"> • Use with 52" Rectangular Worksurface • 24" Above Worksurface Height • 25" Deep Wing Ends • Use on 30" Deep Tables Only 						
AH-EWEMP-5824	62	24	27	17.5	5.75	\$ 1,274
<ul style="list-style-type: none"> • Use with 58" Rectangular Worksurface • 24" Above Worksurface Height • 22" Deep Wing Ends 						
AH-EWEMP-6424	68	21	27	17.5	5.75	\$ 1,274
<ul style="list-style-type: none"> • Use with 64" Rectangular Worksurface • 24" Above Worksurface Height • 19" Deep Wing Ends 						
AH-EWEMP-7024	74	18	27	17.5	5.75	\$ 1,274
<ul style="list-style-type: none"> • Use with 70" Rectangular Worksurface • 24" Above Worksurface Height • 16" Deep Wing Ends 						

OPTIONS

Finish	Bracket Finish	
BLACK	Standard Powder Coat	Studio Powder Coat (Upcharge \$48)
GREIGE	BWT Bone White	CADT Cadet
FOSSIL	BUFF Buff	CLOV Clover
CADET	CHLK Chalk	GLDN Goldenrod
	SGLD Gold	HERN Heron
	GRPH Graphite	LATT Latte
	MSL Luster Grey	MOSS Moss
	HIP Oiled Bronze	RUSS Russet
	BKO Onyx	SUNS Sunset
	POLR Polar	
	SBRZ Soft Bronze	
	HIF Warm Grey	

HOW TO ORDER

SPECIFY: Finish | Bracket Finish.

MODEL NUMBER

AH-WEMP-4624

Finish	Bracket Finish
BLACK	BWT